

1 INCH = 1,500 FEET

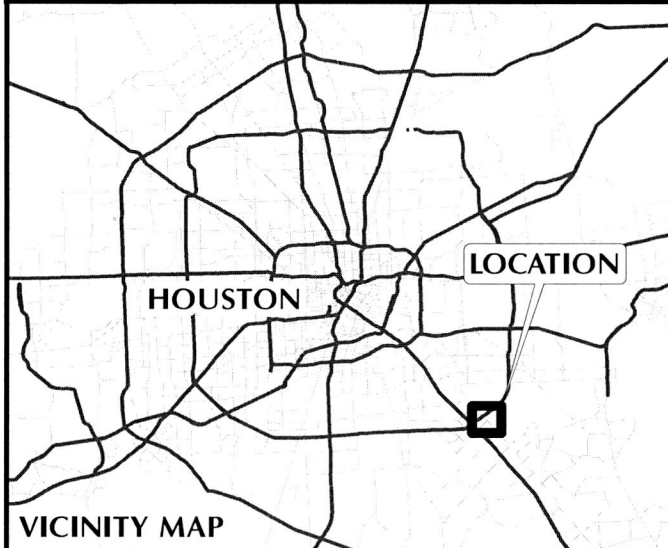
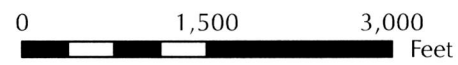

CITY OF HOUSTON

PROJECT LOCATION MAP

WBS No. S-000900-0147-3
 11,100 LF OF 24-INCH WATER LINE ALONG HIGHWAY 3
 FROM THE 42-INCH WATER LINE AT FUQUA ST.
 TO DIXIE FARM ROAD (FM 1959)

KEY MAP GRID(S): 576R; 577N, S, W & X
 COUNCIL DISTRICT(S): E

- Prop. WL (WBS No. S-090-0147-3)
- Prop. WL By Others
- Exist. WL (24" & Larger)

- School
- Hospital
- Police Station
- Fire Station



2925 Briarpark Drive
 Houston, Tx 77042



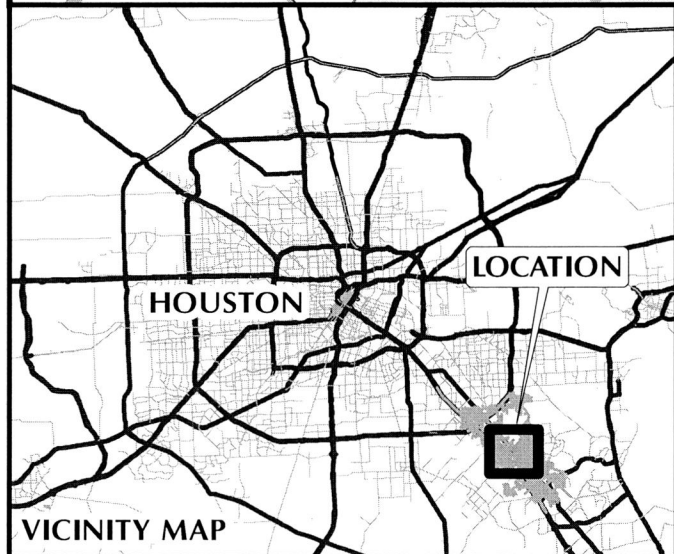
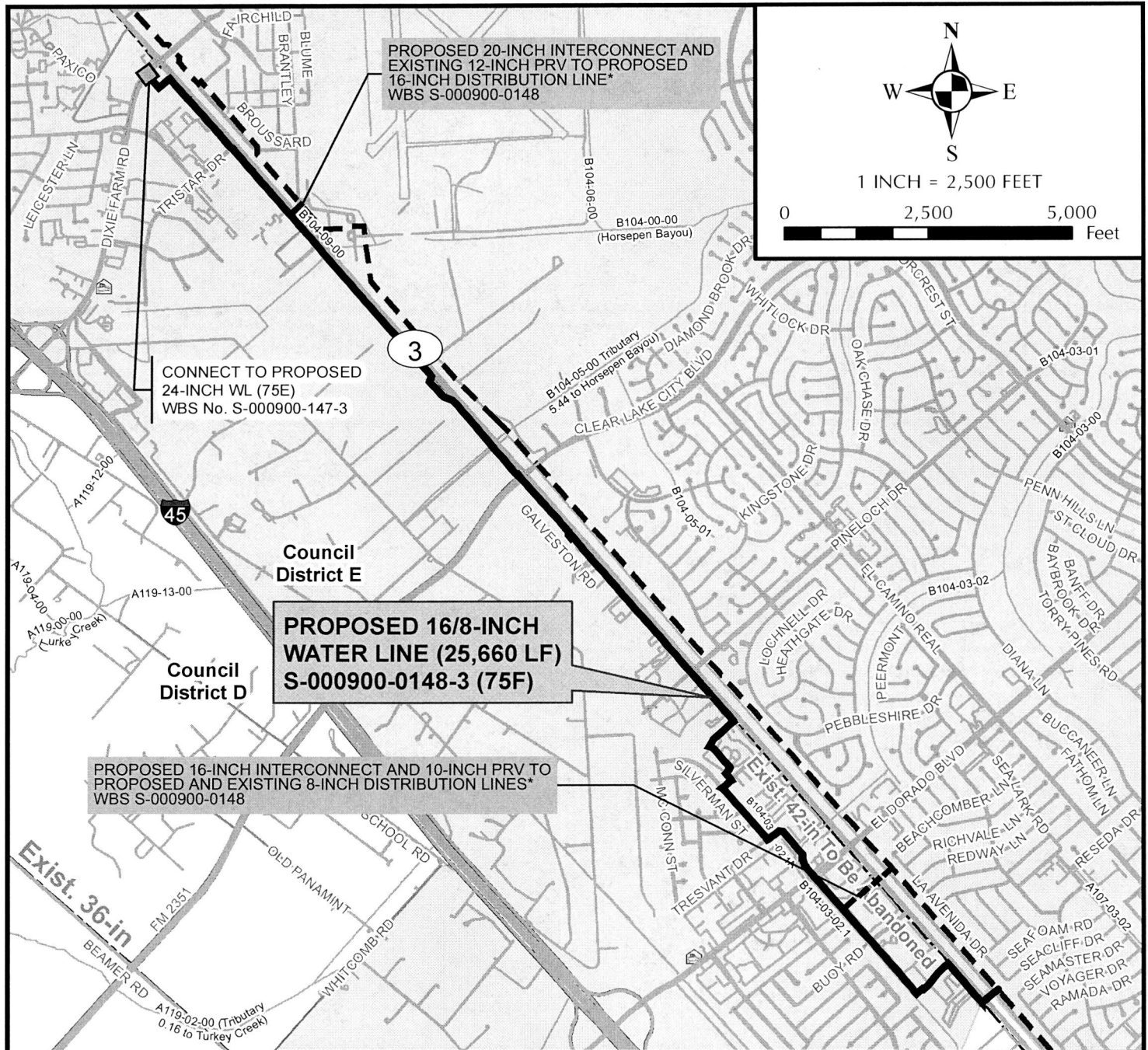

CITY OF HOUSTON

PROJECT LOCATION MAP

WBS No. S-000900-0148-3
25,660 LF OF 16/8-INCH WATER LINE ALONG
HIGHWAY 3 FROM DIXIE FARM ROAD (FM 1959) TO
1,500 FT NORTH OF W TEXAS AVENUE

KEY MAP GRID(S): 577X; 617B, C, G, H, M, R; 618N
COUNCIL DISTRICT(S): E

- Prop. WL (WBS No. S-090-0148-3)
- Prop. WL By Others
- Exist. WL (24" & Larger)

School
 Hospital
 Police Station
 Fire Station

 2925 Briarpark Drive
Houston, Tx 77042

SURFACE WATER TRANSMISSION PROGRAM