

HOUSTON PUBLIC WORKS
CAPITAL PROJECTS

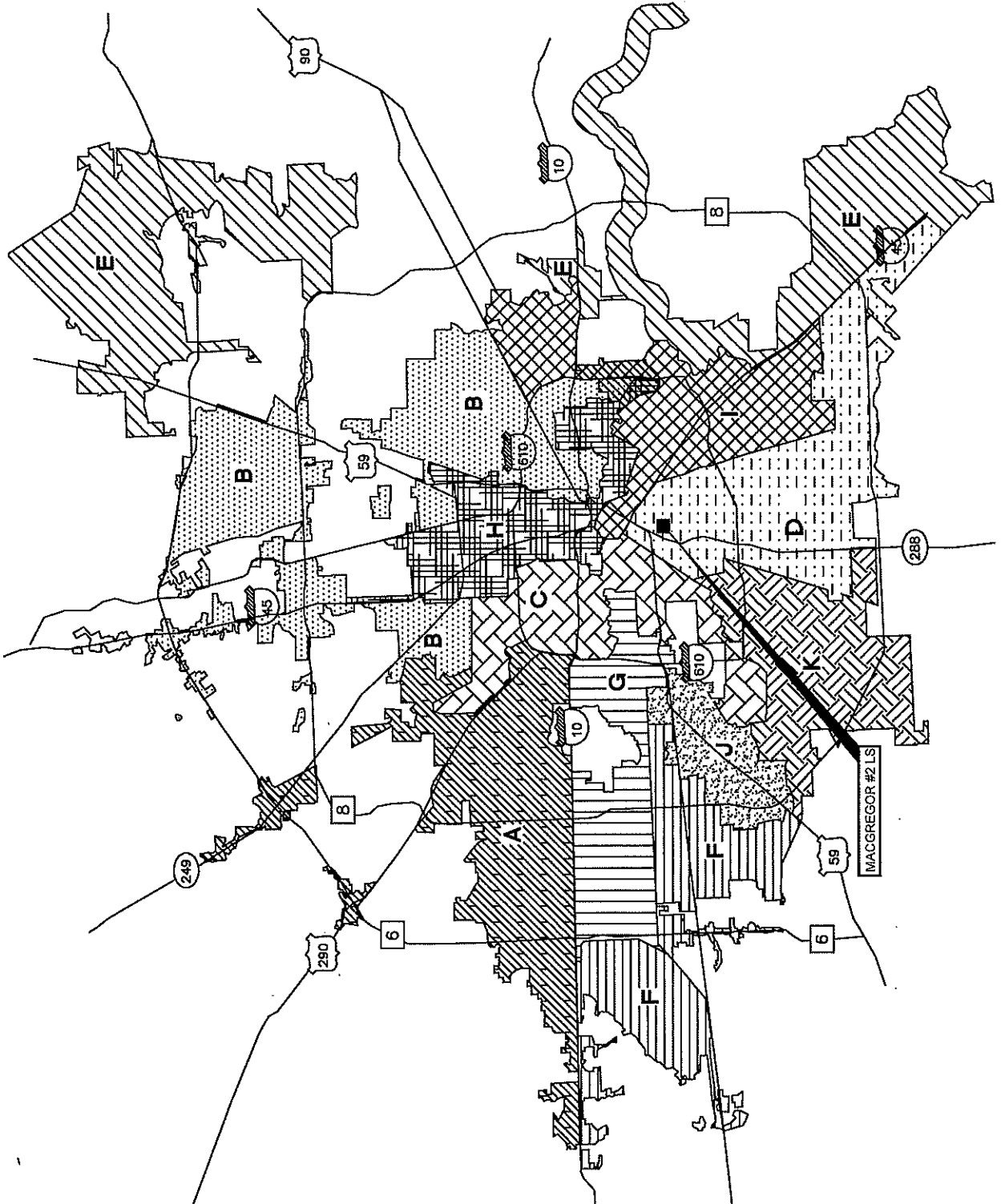

LIFT STATIONS

MACGREGOR #2
COUNCIL DISTRICT: D
KEY MAP No.: 533B
GIMS MAP No.:



CITY COUNCIL MAP

MACGREGOR #2
LIFT STATION
RENEWAL/REPLACEMENT
WBS NO. R-000267-0129-4



KIT Professionals, Inc.
Engineers • Planners • Construction Managers
2000 W. Sam Houston Pkwy S., Ste 1400
Houston, Texas 77002
Phone: (713) 783-8700; Fax: (713) 783-8747
TBPPE Firm Registration No. F-4991

HOUSTON PUBLIC WORKS
CAPITAL PROJECTS

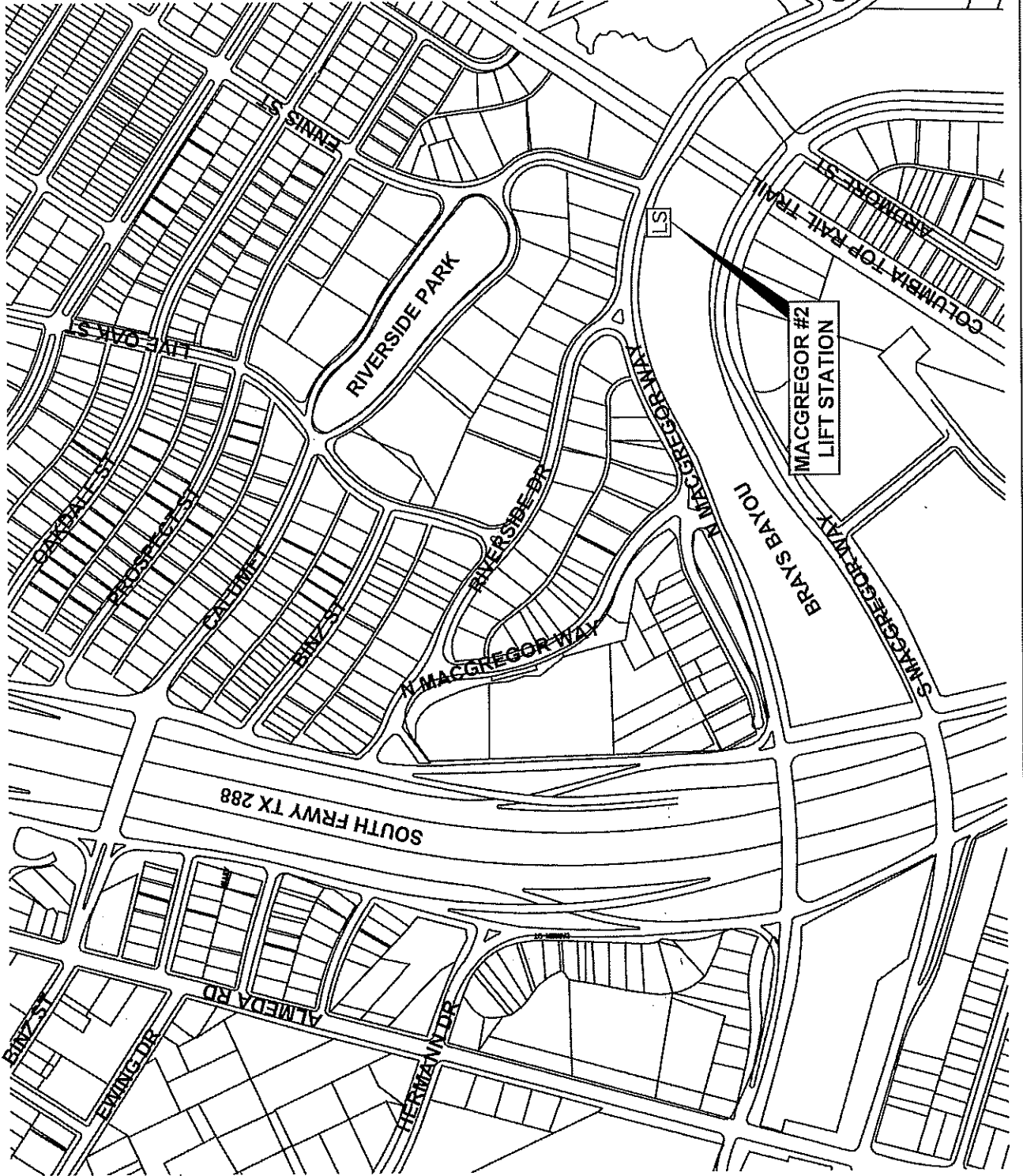

MACGREGOR #2
KEY MAP NO.: 533B
GIMS MAP NO.: 5355B
COUNCIL DISTRICT - D

MACGREGOR #2 LIFT STATION

LIFT STATION
RENEWAL/REPLACEMENT
WBS NO. R-000267-0129-4



KIT Professionals, Inc.

Engineers • Planners • Construction Managers
2000 W. Sam Houston Pkwy S., Ste 1400
Houston, TX 77058
Phone: (713) 783-8700; Fax: (713) 783-8747
T.E.P.E. Firm Registration No. F-4891

HOUSTON PUBLIC WORKS
CAPITAL PROJECTS

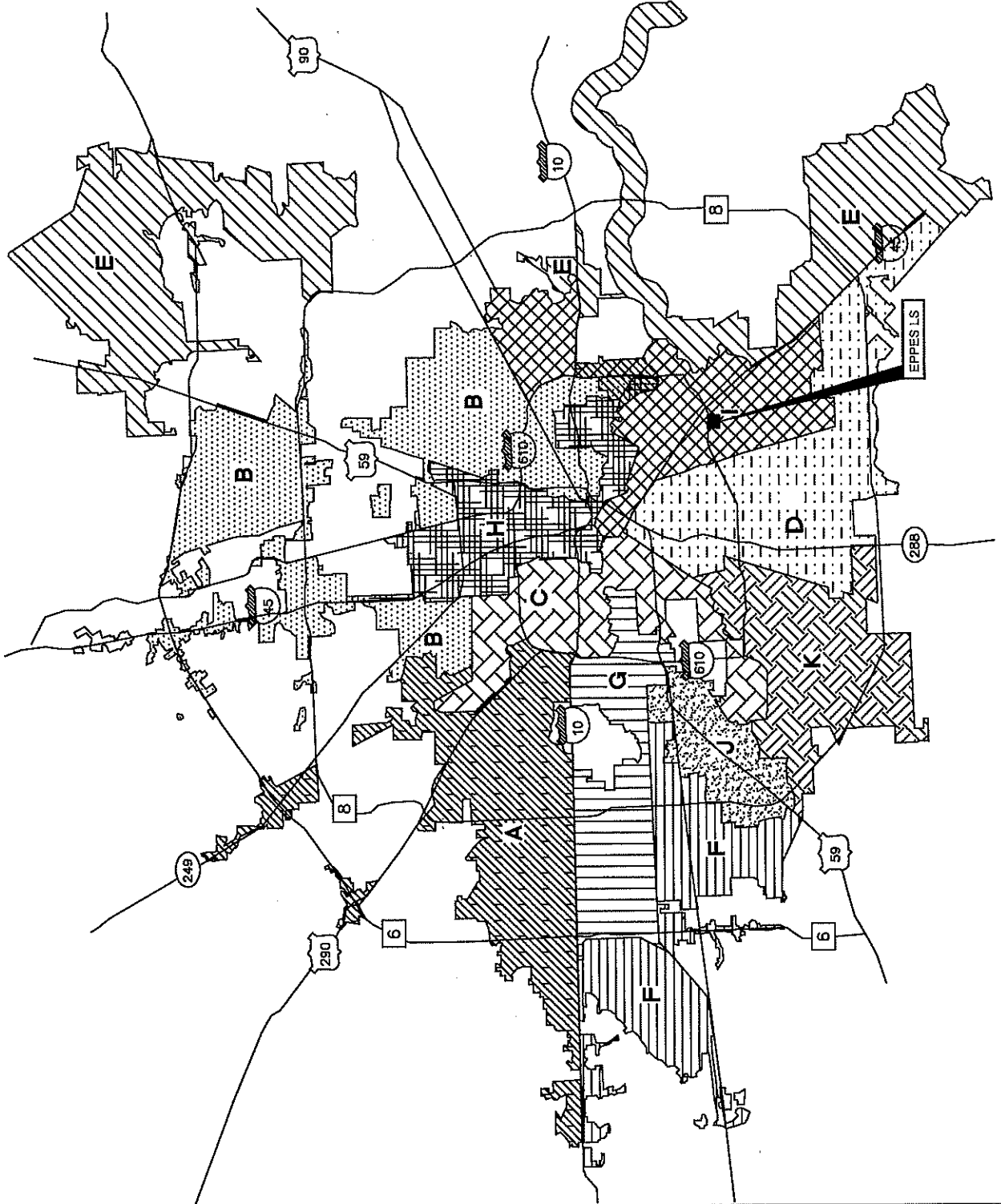

LIFT STATIONS

EPPES
COUNCIL DISTRICT: 1
KEY MAP No.: 534R
GIMS MAP No.: 5554A

CITY COUNCIL MAP

EPPES
LIFT STATION
RENEWAL/REPLACEMENT
WBS NO. R-000267-0129-4



Challenging Challenges...

KIT Professionals, Inc.

Engineers • Planners • Construction Managers
2000 W. Sam Houston Pkwy. S., Ste 1400
Houston, Texas 77042
Phone: (713) 783-8700; Fax: (713) 783-8747
TBPE Firm Registration No. F-4991

HOUSTON PUBLIC WORKS
CAPITAL PROJECTS

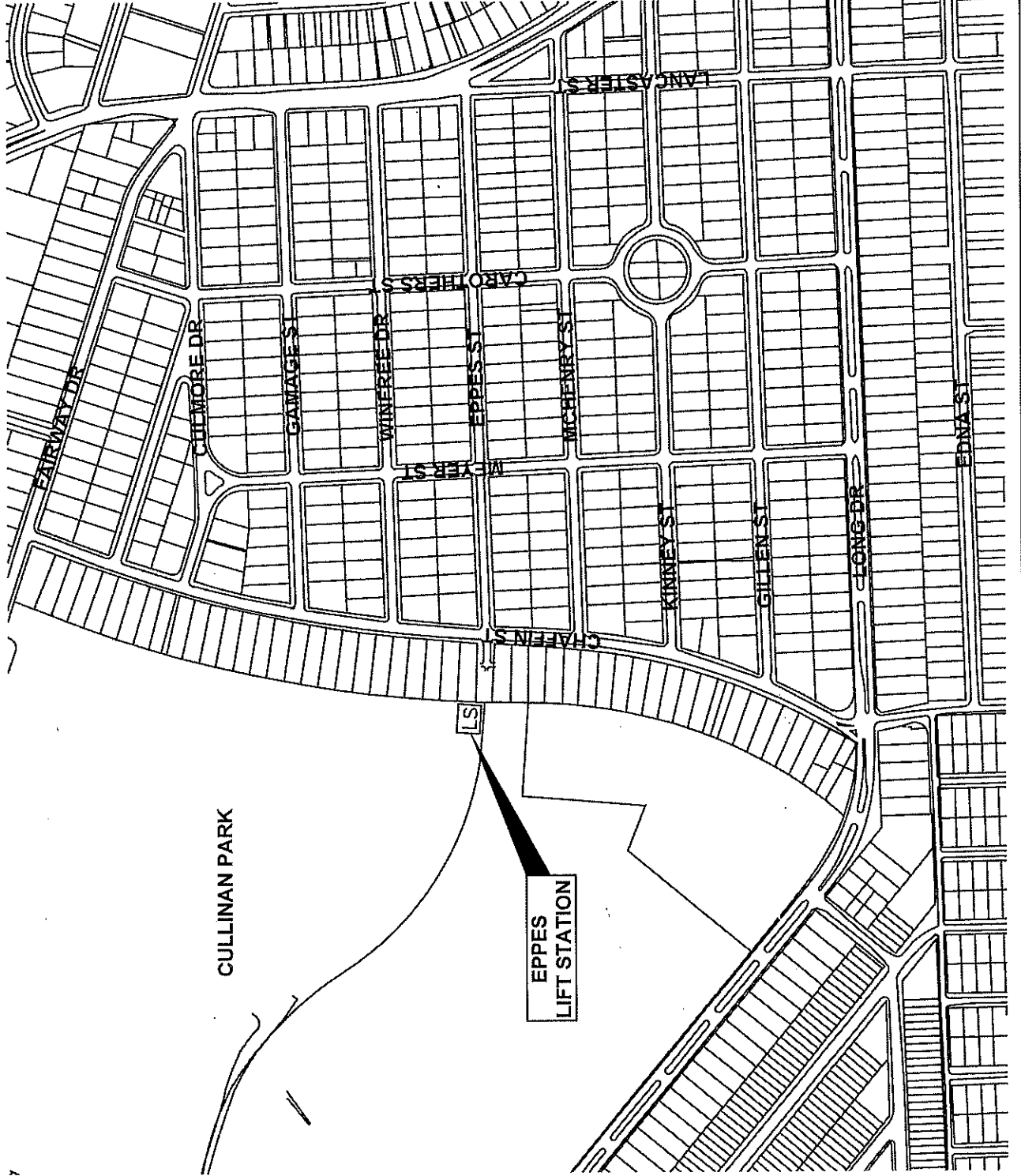
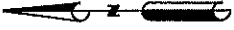

EPES
KEY MAP NO.: 534R
GIMS MAP NO.: 5554A
COUNCIL DISTRICT - I

EPES LIFT STATION

LIFT STATION
RENEWAL/REPLACEMENT
WBS NO. R-000267-0129-4



KIT Professionals, Inc.
Challenging Challenges...

Engineers • Planners • Construction Managers
2000 W. Sam Houston Pkwy S., Ste 1400
Houston, Texas 77052
Phone: (713) 783-9700; Fax: (713) 783-8747
TBP# Perm Registration No. F-4981

HOUSTON PUBLIC WORKS
CAPITAL PROJECTS

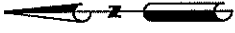

KELLOGG
KEY MAP NO.: 535A
GIMS MAP NO.: 5655A
COUNCIL DISTRICT - I

KELLOGG LIFT STATION

LIFT STATION
RENEWAL/REPLACEMENT
WBS NO. R-000267-0129-4



KIT Professionals, Inc.
Engineers • Planners • Construction Managers
2000 W. Sam Houston Pkwy S., Ste. 1400
Houston, Texas 77062
Phone: (713) 783-8700; Fax: (713) 783-8747
TSPCE Firm Registration No. F-4981

HOUSTON PUBLIC WORKS
CAPITAL PROJECTS



LIFT STATIONS

KELLOGG
COUNCIL DISTRICT: I
KEY MAP No.: 535A
GIMS MAP No.: 5655A

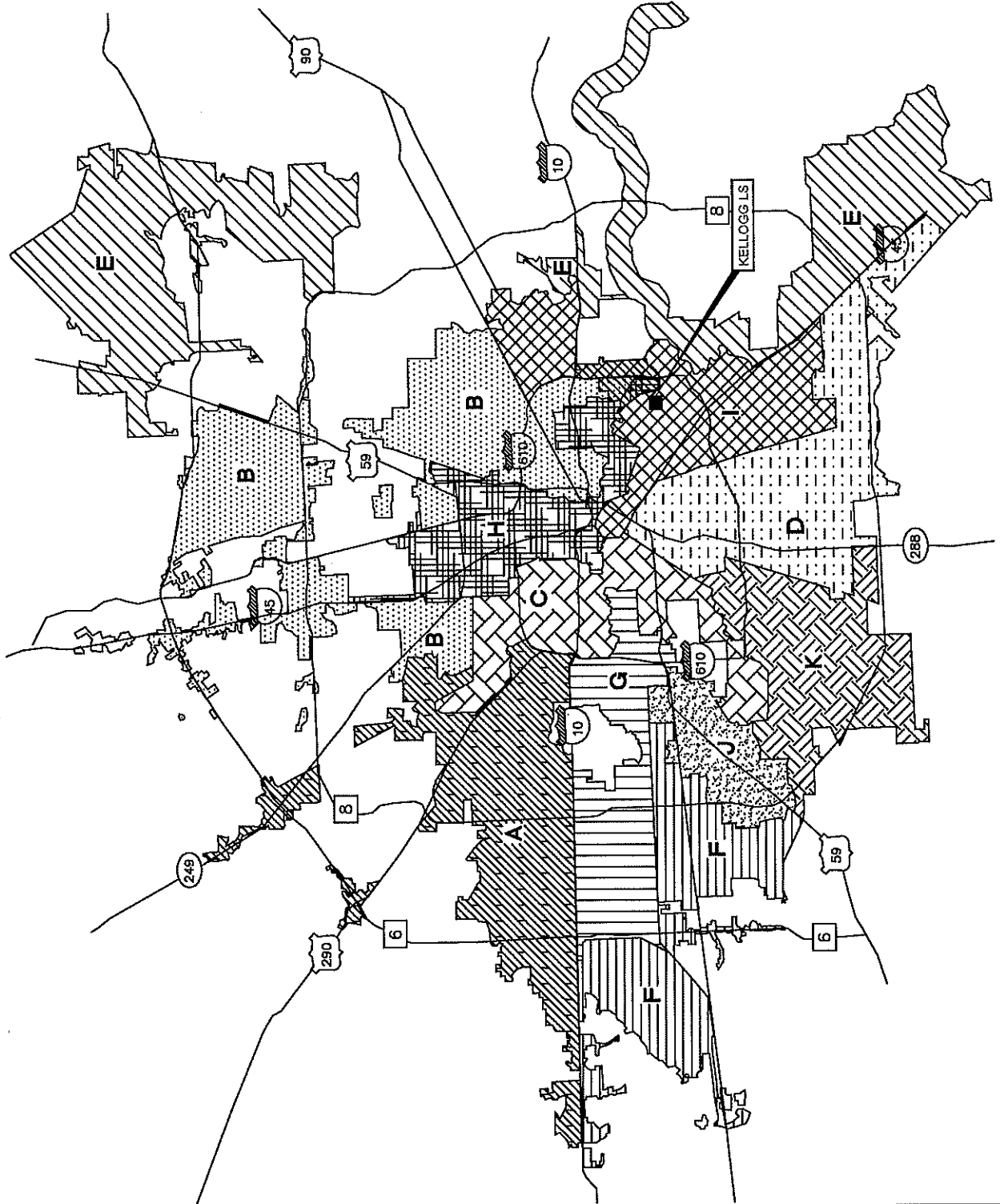

CITY COUNCIL MAP

KELLOGG
LIFT STATION
RENEWAL/REPLACEMENT
WBS NO. R-000267-0129-4



KIT Professionals, Inc.
Engineers • Planners • Construction Managers
2000 W. Sam Houston Pkwy S., Ste 1400
Houston, Texas 77042
Phone: (713) 768-8700, Fax: (713) 768-8747
TBPE Firm Registration No. F-4981

HOUSTON PUBLIC WORKS
CAPITAL PROJECTS



LIFT STATIONS

SCOTT #2
COUNCIL DISTRICT: D
KEY MAP No.: 533U
GIMS MAP No.: 5453A

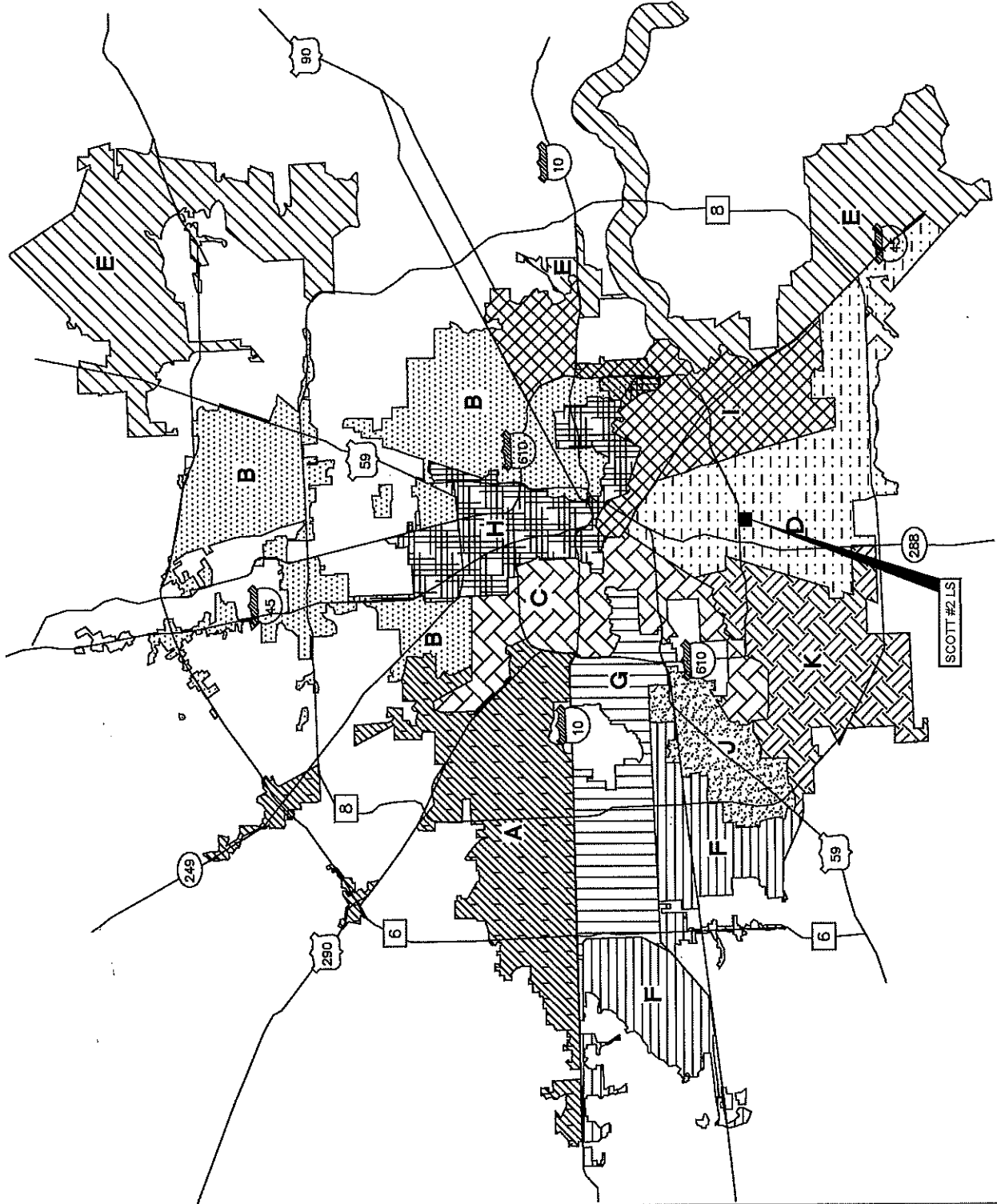

CITY COUNCIL MAP

SCOTT #2
LIFT STATION
RENEWAL/REPLACEMENT
WBS NO. R-000267-0129-4



KIT Professionals, Inc.
Engineers • Planners • Construction Managers
2000 W. Sam Houston Pkwy. S., Ste. 1400
Houston, Texas 77042
Phone: (713) 783-8700; Fax: (713) 783-8747
TBPPE Firm Registration No. T-4991

HOUSTON PUBLIC WORKS
CAPITAL PROJECTS

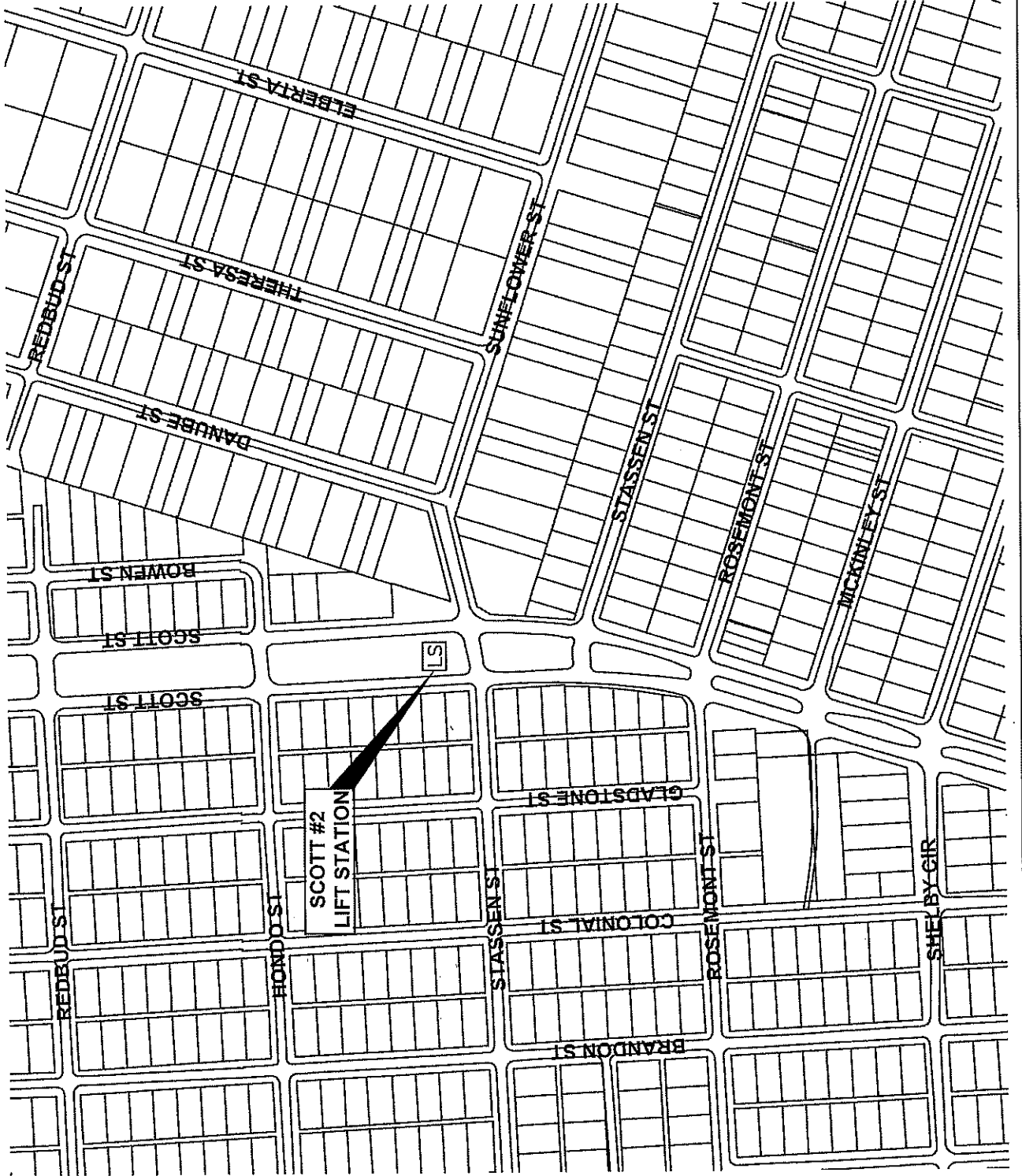
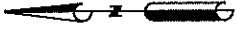

SCOTT #2
KEY MAP NO.: 533U
GIMS MAP NO.: 5453A
COUNCIL DISTRICT - D

SCOTT #2 LIFT STATION

LIFT STATION
RENEWAL/REPLACEMENT
WBS NO. R-000267-0129-4



KIT Professionals, Inc.

Engineers • Planners • Construction Managers
2200 W. Sam Houston Pkwy S., Ste 1400
Houston, Texas 77062
Phone: (713) 783-8700; Fax: (713) 783-8747
TEPE Firm Registration No. F-4891

HOUSTON PUBLIC WORKS
CAPITAL PROJECTS



LIFT STATIONS

GLENGYLE
COUNCIL DISTRICT: E
KEY MAP No.: 338Q
GIMS MAP No.: 5968B

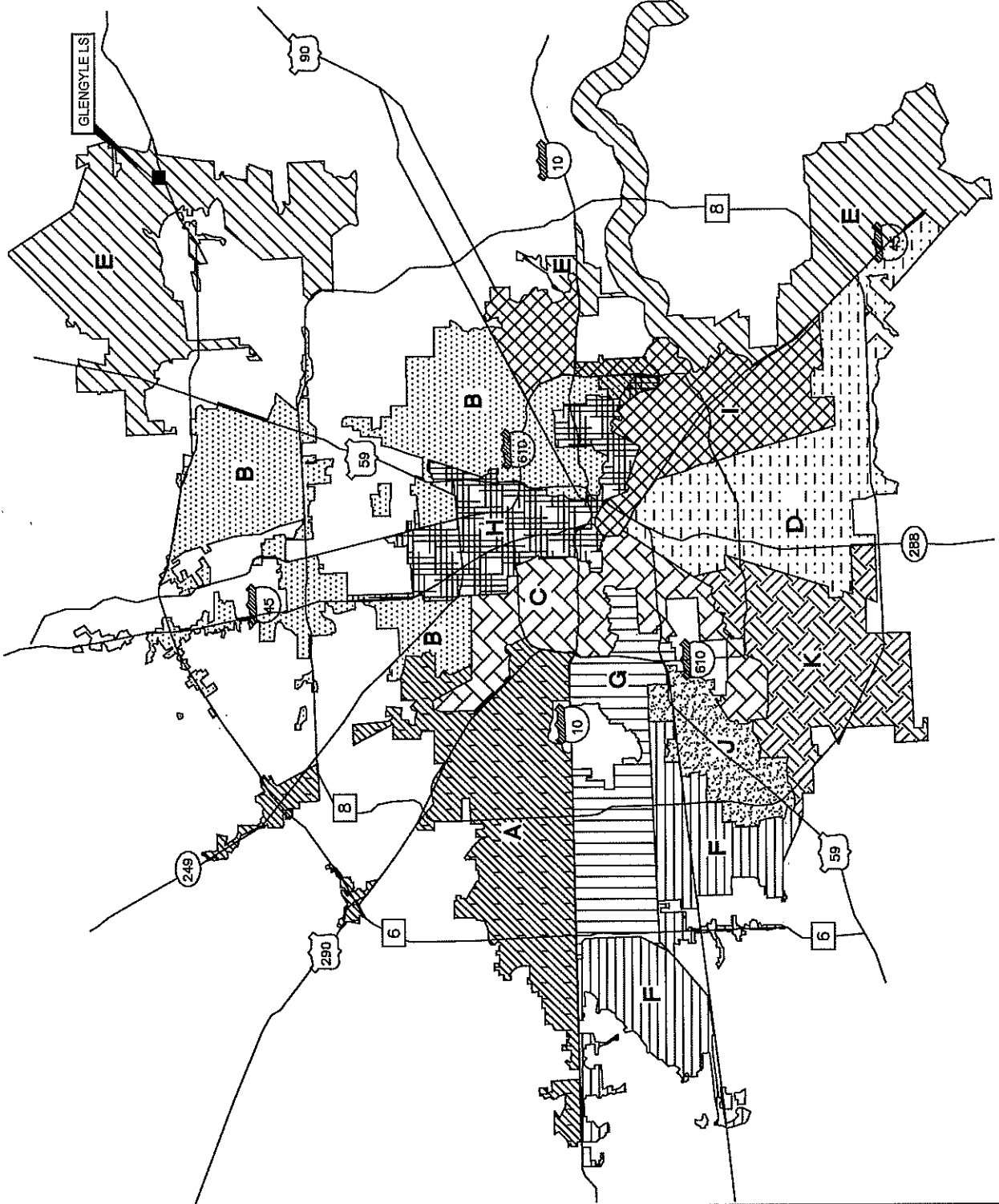

CITY COUNCIL MAP

GLENGYLE
LIFT STATION
RENEWAL/REPLACEMENT
WBS NO. R-000267-0129-4



KIT Professionals, Inc.

Engineers • Planners • Construction Managers
2000 W. Sam Houston Pkwy S., Ste 1400
Houston, Texas 77042
Phone: (713) 785-8700 Fax: (713) 785-8747
TPE Firm Registration No. F-4991

HOUSTON PUBLIC WORKS
CAPITAL PROJECTS

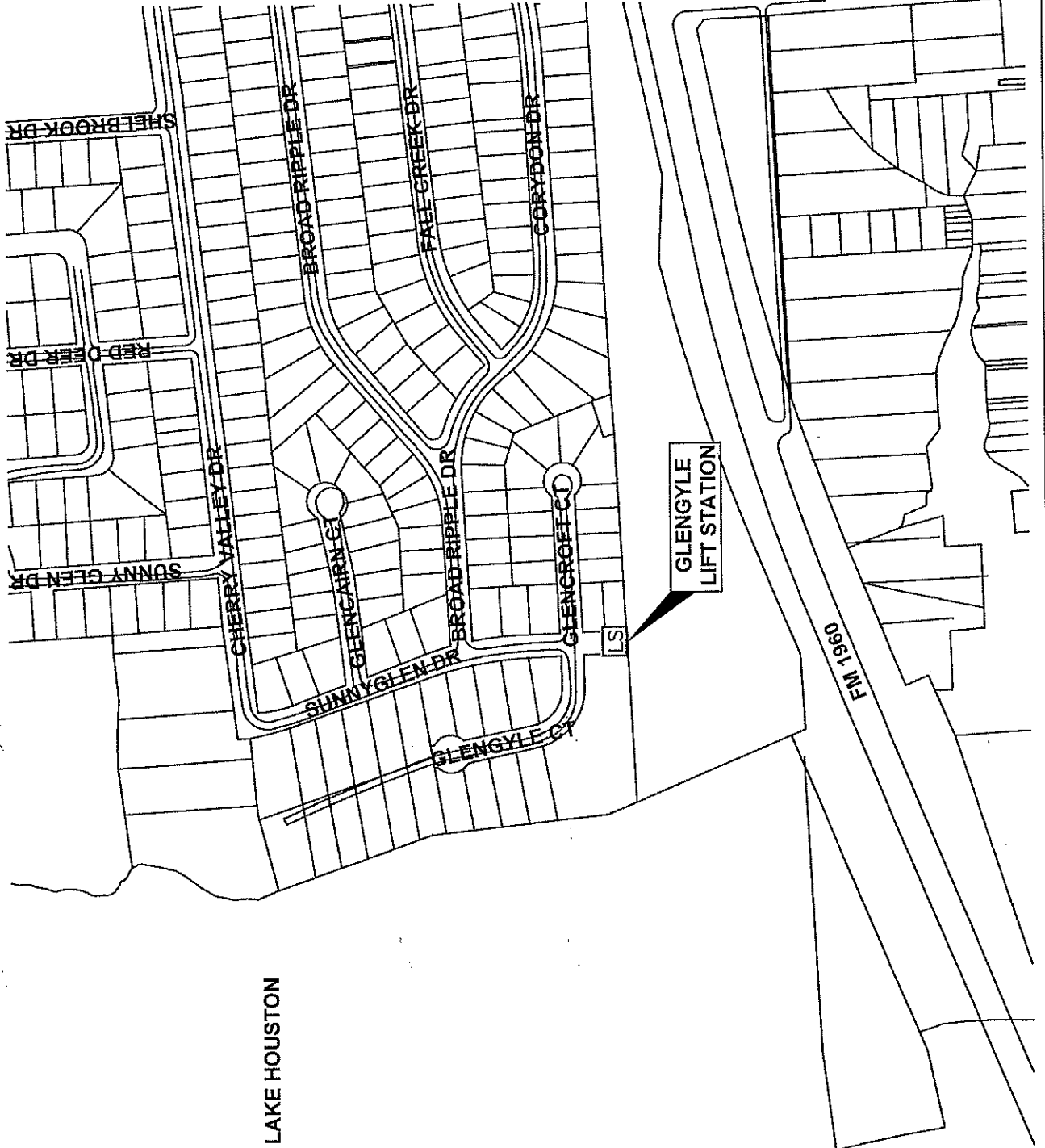
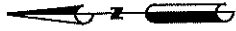

LAKE HOUSTON

GLENGYLE
KEY MAP NO.: 338Q
GIMS MAP NO.: 5968B
COUNCIL DISTRICT - E

GLENGYLE LIFT STATION

LIFT STATION
RENEWAL/REPLACEMENT
WBS NO. R-000267-0129-4



KIT Professionals, Inc.
Engineers • Planners • Construction Managers
200 W. Sam Houston Pkwy S., Ste 1400
Houston, TX 77062
Phone: (713) 783-8700; Fax: (713) 783-8747
TBEPE Firm Registration No. F-4951

HOUSTON PUBLIC WORKS
CAPITAL PROJECTS

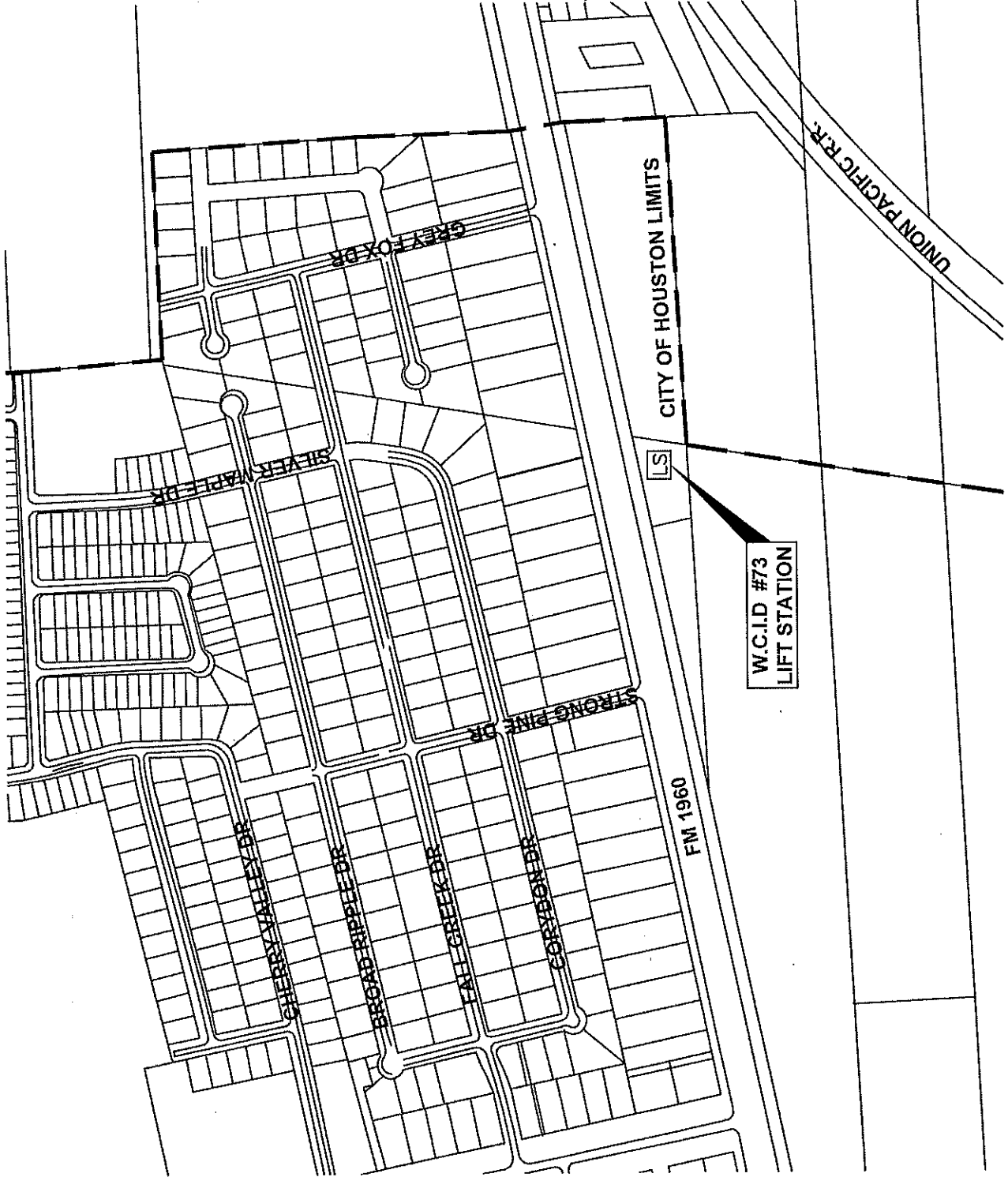
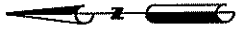

W.C.I.D. #73
KEY MAP NO.: 338R
GIMS MAP NO.: 6068A
COUNCIL DISTRICT - E

W.C.I.D #73 LIFT STATION

LIFT STATION
RENEWAL/REPLACEMENT
WBS NO. R-000267-0129-4



KIT Professionals, Inc.

Engineers • Planners • Construction Managers
2000 W. Sam Houston Pkwy S., Ste 1400
Houston, Texas 77058
Phone: (713) 783-2700; Fax: (713) 783-5747
TYPE F Firm Registration No. F-4581