

# PROJECT MAP

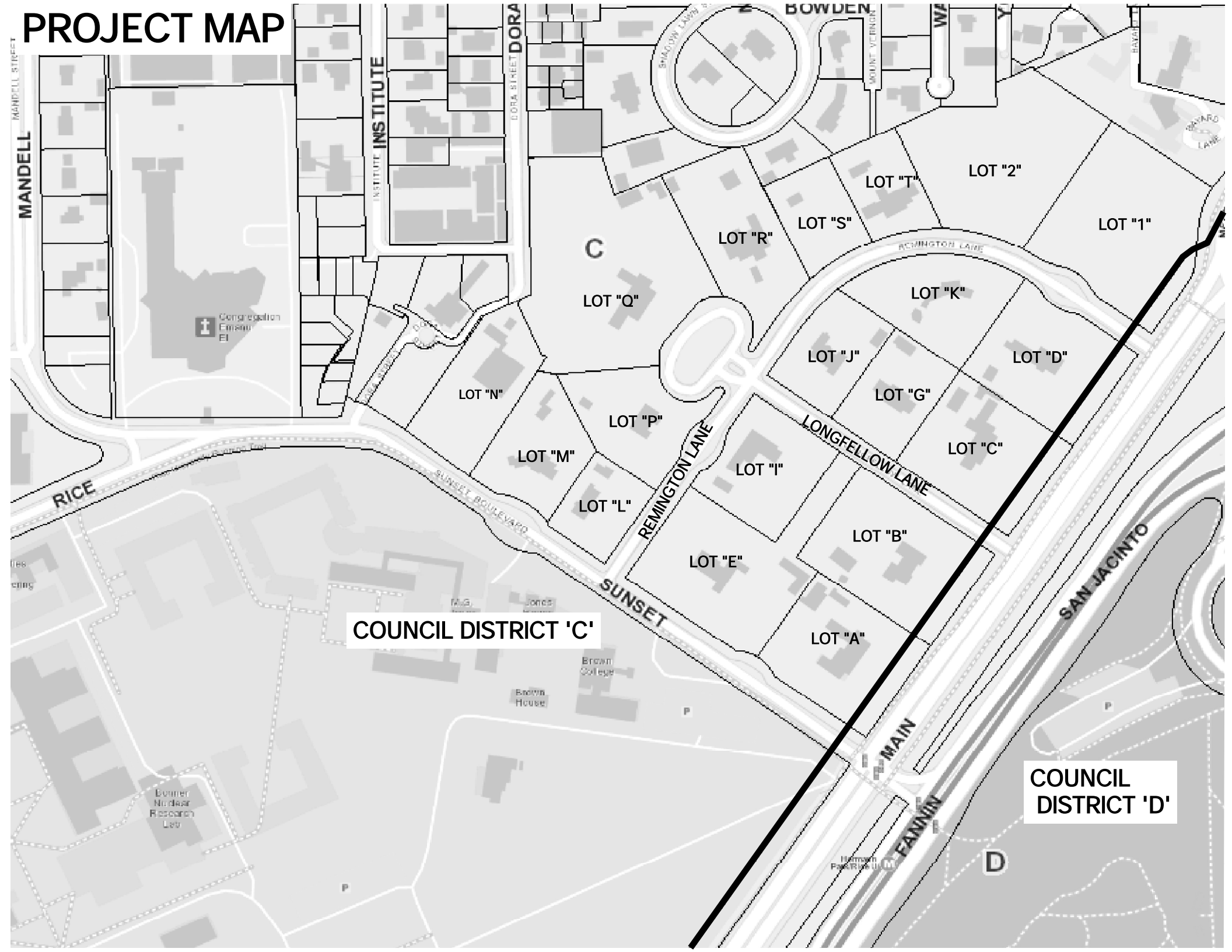

MANDELL STREET

INSTITUTE

DORA STREET

BOWDEN

W

Y

BEVARD LANE

Congregation  
First  
E

C

LOT "1"

LOT "2"

LOT "T"

LOT "S"

LOT "R"

LOT "Q"

LOT "K"

LOT "D"

LOT "J"

LOT "G"

LOT "C"

LOT "P"

LOT "I"

LONGFELLOW LANE

LOT "N"

LOT "M"

LOT "L"

LOT "E"

LOT "B"

SUNSET

LOT "A"

SAN JACINTO

COUNCIL DISTRICT 'C'

COUNCIL DISTRICT 'D'

D

MAIN

FANNIN

RICE

Bonner  
Nuclear  
Research  
Lab

Brown  
House

Brown  
College

UNIVERSITY  
PARKING LOT

# EXHIBIT A SHADYSIDE MAP

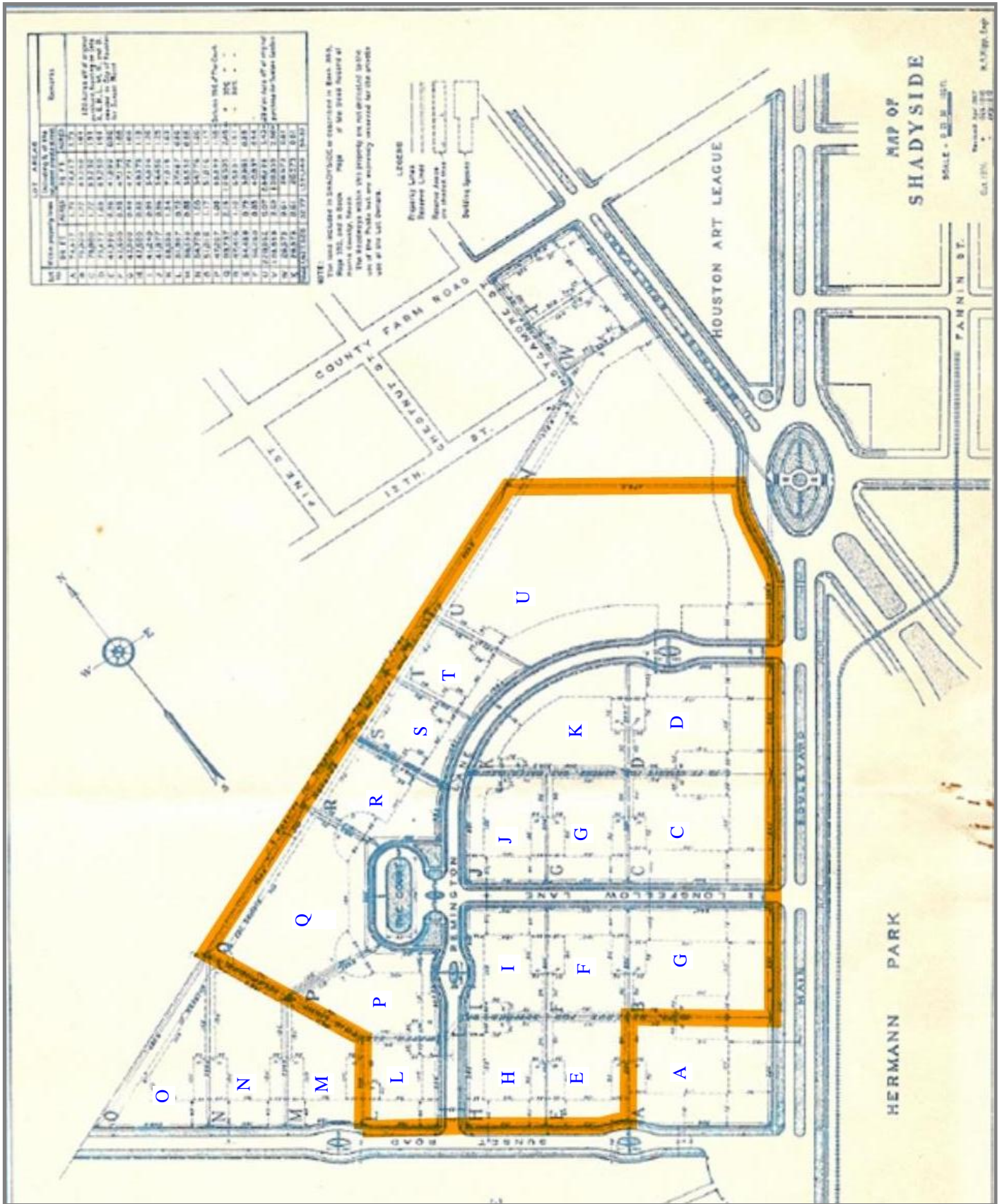
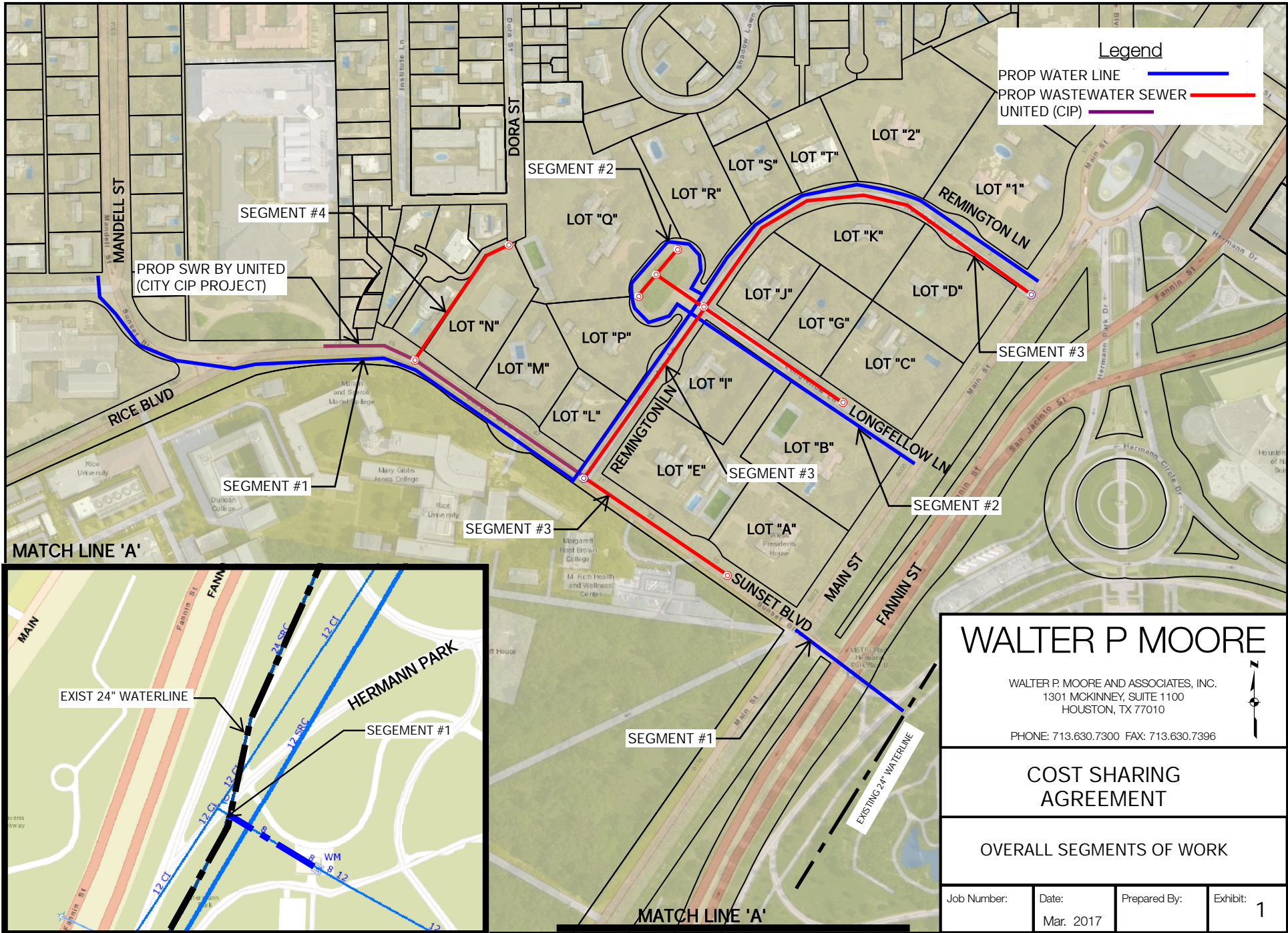
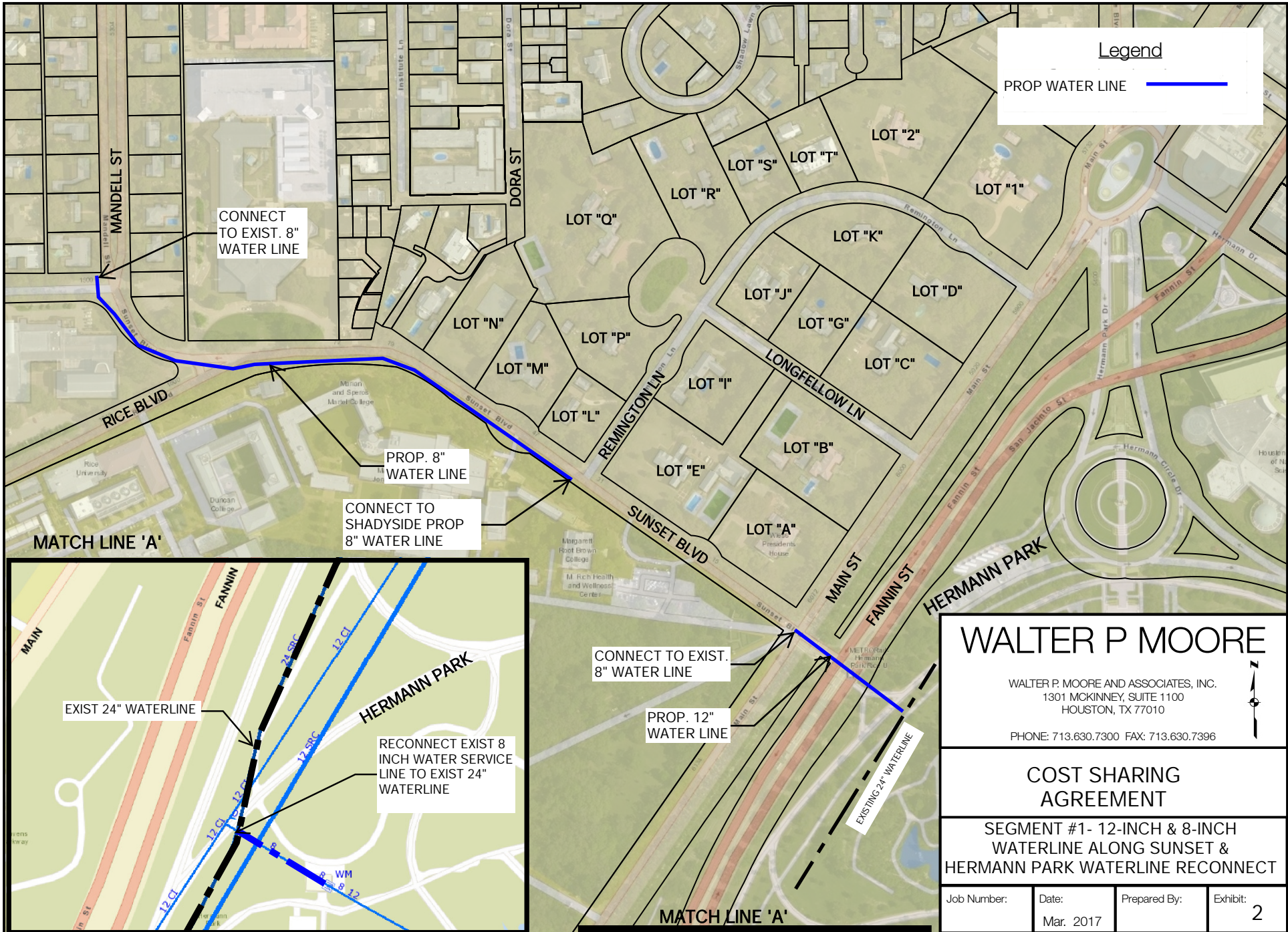

Exhibit A-i





**Legend**

PROP WATER LINE —

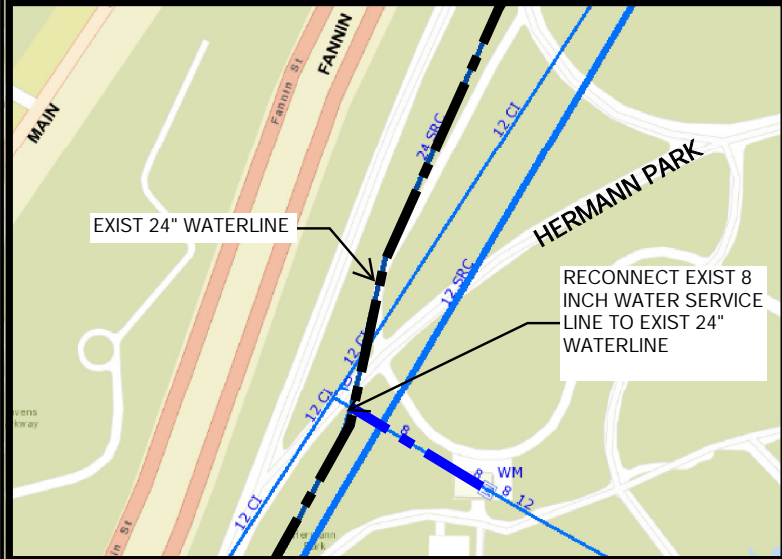

**WALTER P MOORE**

WALTER P. MOORE AND ASSOCIATES, INC.  
 1301 MCKINNEY, SUITE 1100  
 HOUSTON, TX 77010

PHONE: 713.630.7300 FAX: 713.630.7396

---

**COST SHARING AGREEMENT**

SEGMENT #1- 12-INCH & 8-INCH WATERLINE ALONG SUNSET & HERMANN PARK WATERLINE RECONNECT

|             |           |              |          |
|-------------|-----------|--------------|----------|
| Job Number: | Date:     | Prepared By: | Exhibit: |
|             | Mar. 2017 |              | 2        |

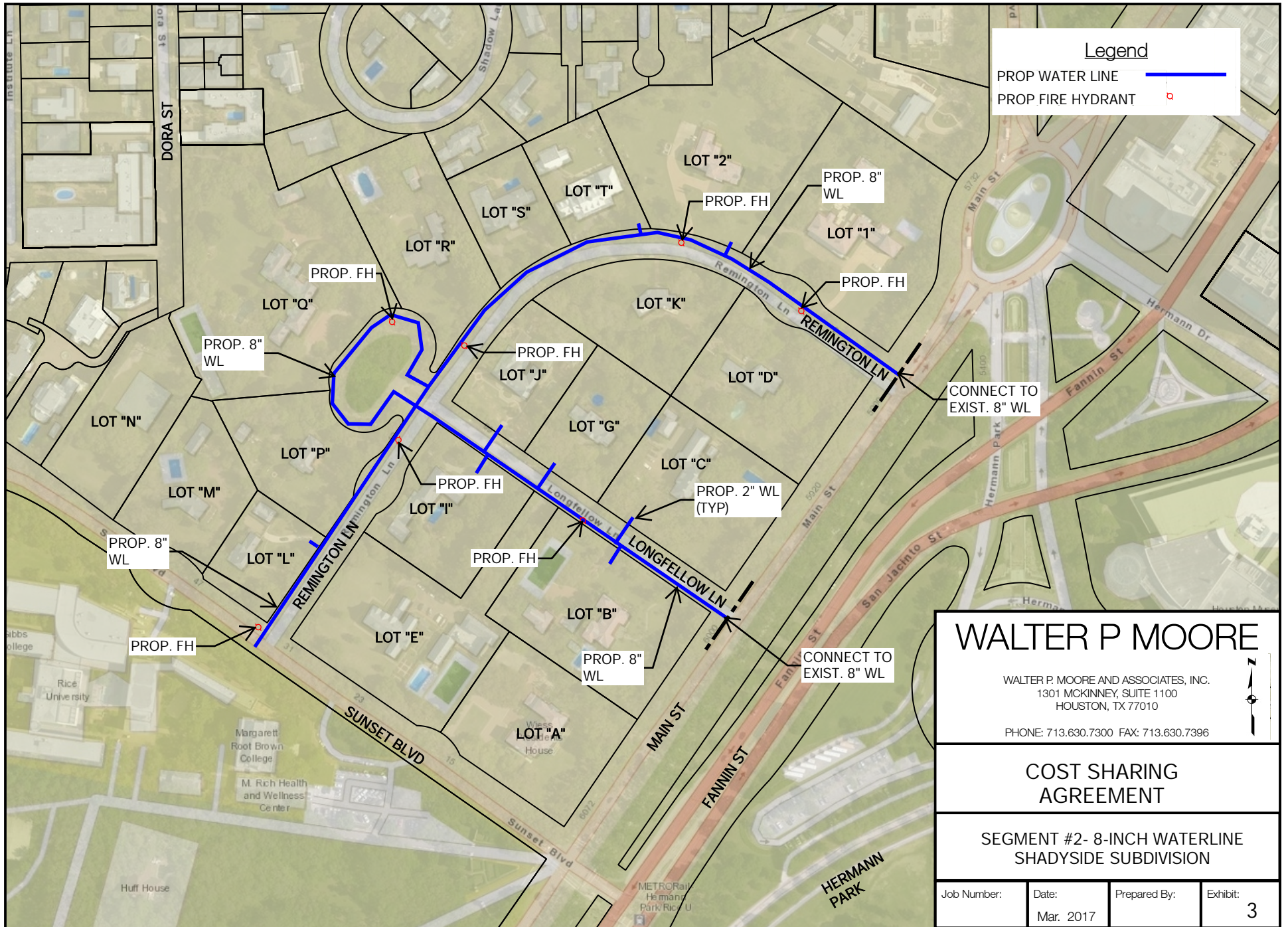

**Legend**

PROP WATER LINE —

PROP FIRE HYDRANT ●

**WALTER P MOORE**

WALTER P. MOORE AND ASSOCIATES, INC.  
 1301 MCKINNEY, SUITE 1100  
 HOUSTON, TX 77010

PHONE: 713.630.7300 FAX: 713.630.7396

**COST SHARING AGREEMENT**

**SEGMENT #2- 8-INCH WATERLINE SHADYSIDE SUBDIVISION**

|             |           |              |          |
|-------------|-----------|--------------|----------|
| Job Number: | Date:     | Prepared By: | Exhibit: |
|             | Mar. 2017 |              | 3        |

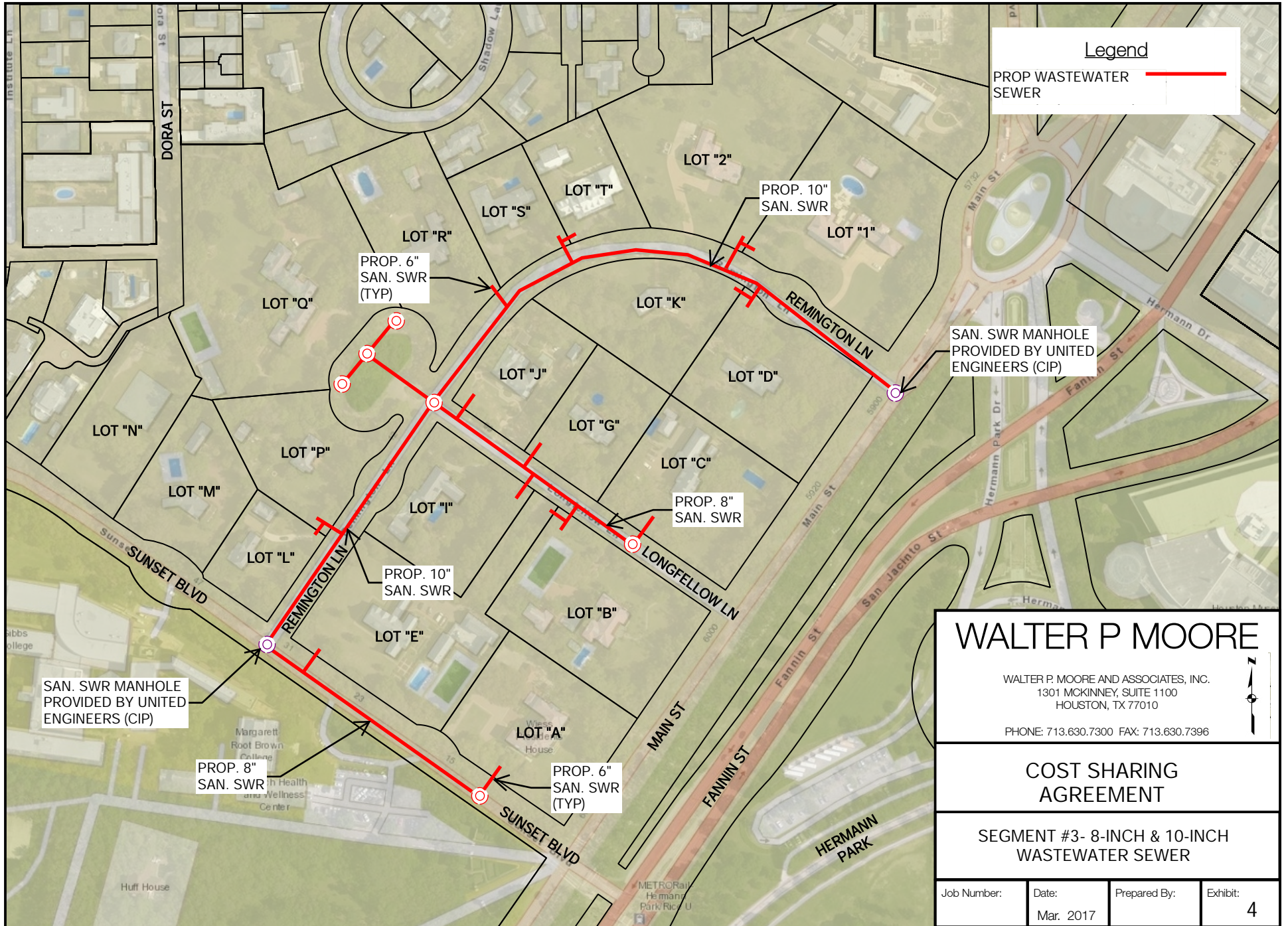

**Legend**

PROP WASTEWATER SEWER —

**WALTER P MOORE**

WALTER P. MOORE AND ASSOCIATES, INC.  
 1301 MCKINNEY, SUITE 1100  
 HOUSTON, TX 77010

PHONE: 713.630.7300 FAX: 713.630.7396

**COST SHARING AGREEMENT**

**SEGMENT #3- 8-INCH & 10-INCH WASTEWATER SEWER**

|             |           |              |          |
|-------------|-----------|--------------|----------|
| Job Number: | Date:     | Prepared By: | Exhibit: |
|             | Mar. 2017 |              | 4        |

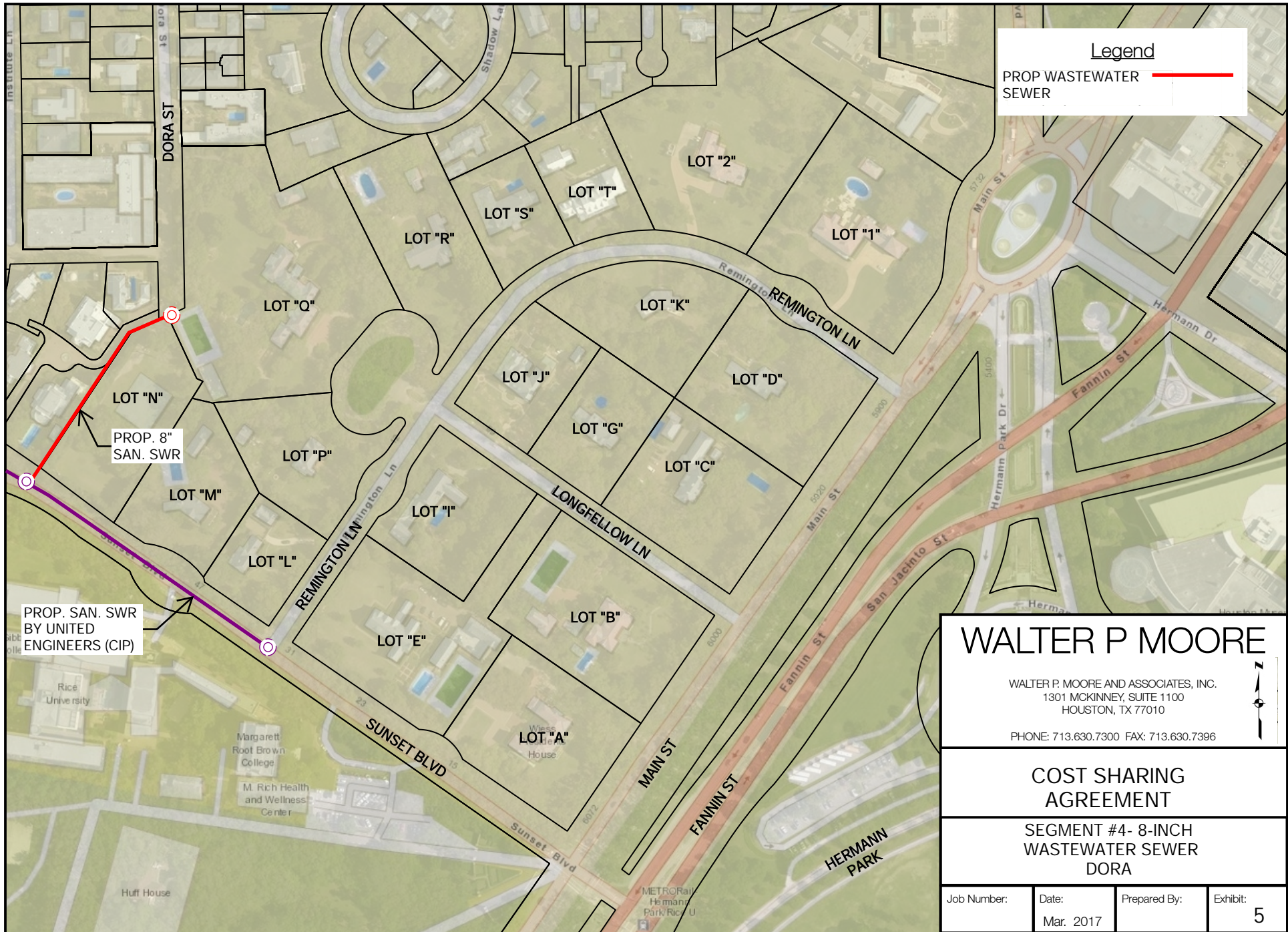

**Legend**

PROP WASTEWATER SEWER —

**WALTER P MOORE**

WALTER P. MOORE AND ASSOCIATES, INC.  
 1301 MCKINNEY, SUITE 1100  
 HOUSTON, TX 77010

PHONE: 713.630.7300 FAX: 713.630.7396



**COST SHARING AGREEMENT**

**SEGMENT #4- 8-INCH WASTEWATER SEWER DORA**

|             |           |              |          |
|-------------|-----------|--------------|----------|
| Job Number: | Date:     | Prepared By: | Exhibit: |
|             | Mar. 2017 |              | 5        |

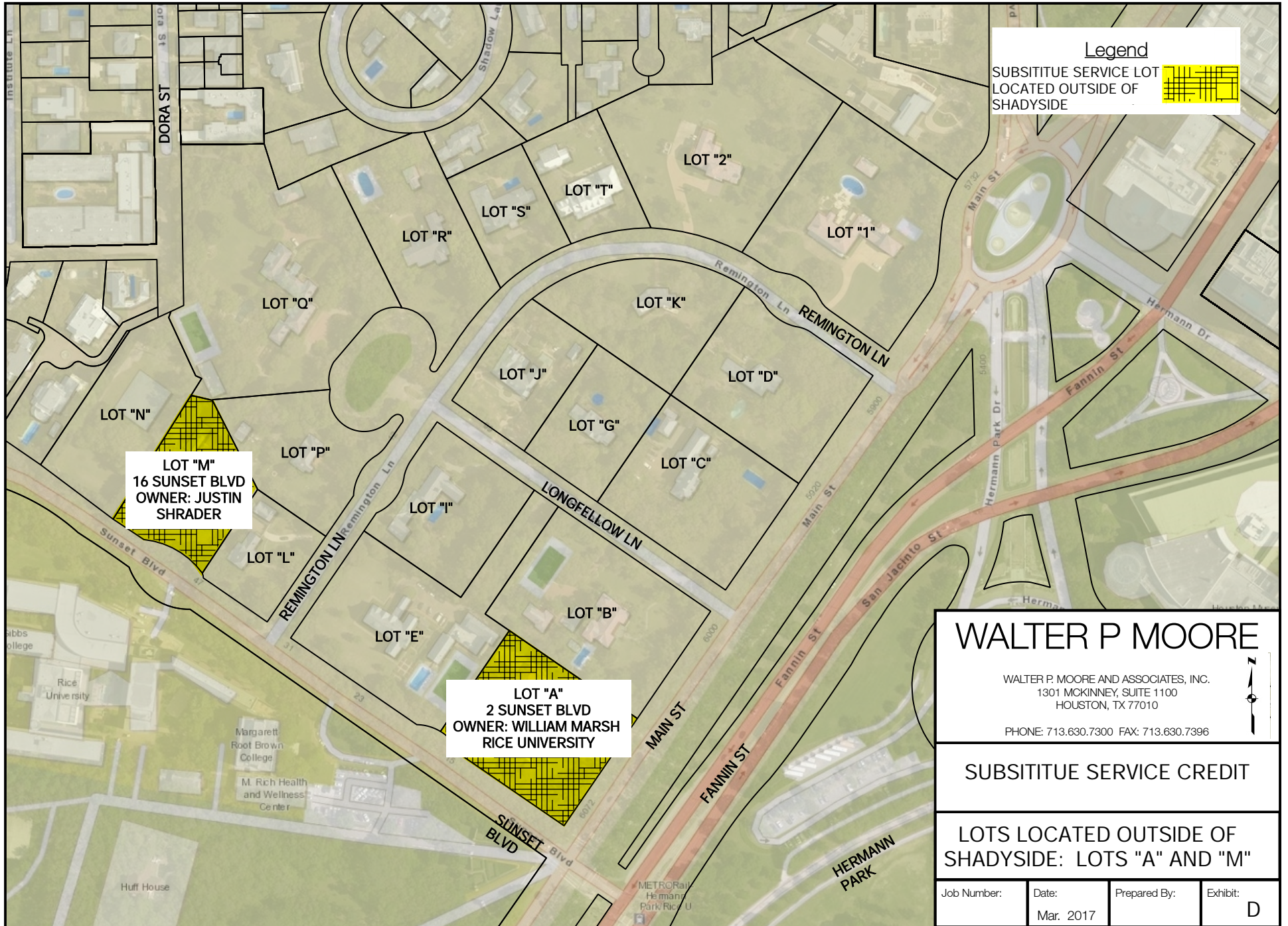

**Legend**  
 SUBSTITUE SERVICE LOT  
 LOCATED OUTSIDE OF  
 SHADYSIDE

**LOT "M"**  
 16 SUNSET BLVD  
 OWNER: JUSTIN  
 SHRADER

**LOT "A"**  
 2 SUNSET BLVD  
 OWNER: WILLIAM MARSH  
 RICE UNIVERSITY

**WALTER P MOORE**  
 WALTER P. MOORE AND ASSOCIATES, INC.  
 1301 MCKINNEY, SUITE 1100  
 HOUSTON, TX 77010  
 PHONE: 713.630.7300 FAX: 713.630.7396

**SUBSTITUE SERVICE CREDIT**

**LOTS LOCATED OUTSIDE OF  
 SHADYSIDE: LOTS "A" AND "M"**

|             |           |              |          |
|-------------|-----------|--------------|----------|
| Job Number: | Date:     | Prepared By: | Exhibit: |
|             | Mar. 2017 |              | D        |