

Dowdell Public Utility District

Key Map No. 290 K and No. 290 L

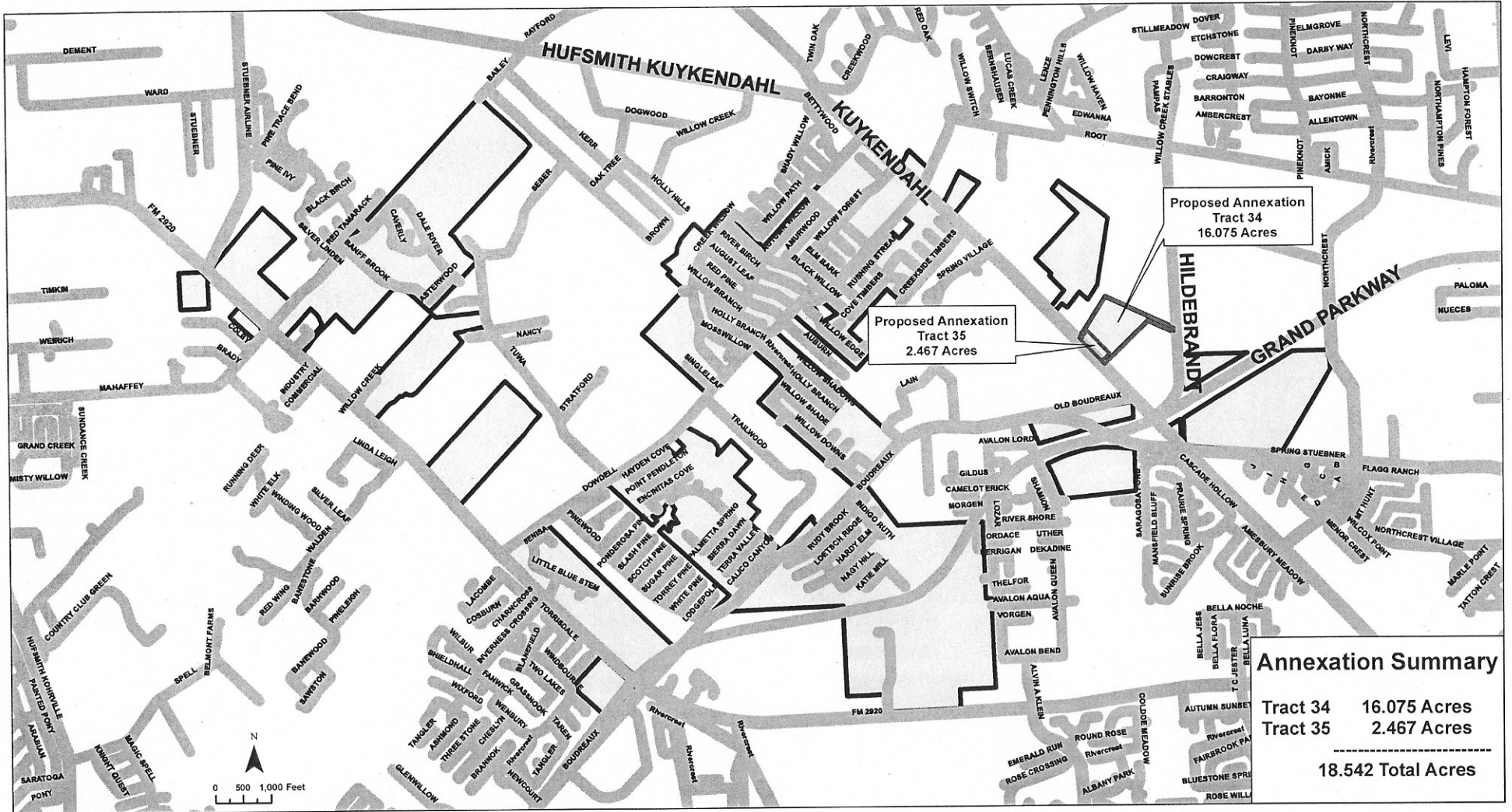

Legend

Dowdell PUD Boundary

VanDeWiele & Vogler
Incorporated
Consulting Engineers

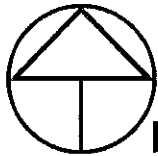

NORTH

SCALE: 1" = 300'

CALLED 4.3285 ACRES
STANLEY HOLLY CHEN, ET AL
H.C.C.F. NO. M697019

N 35°46'13" E 883.55'

CALLLED 16.075 ACRES
HOME DEPOT U.S.A., INC.
H.C.C.F. NO. RP-2017-218121
**TRACT THIRTY FOUR
(TO BE ANNEXED)
16.075 ACRES**

POB TRACT 34
TRACT THIRTY FOUR
(TO BE ANNEXED)
16.075 ACRES

KUYKENDAHL ROAD
(100' RIGHT-OF-WAY)

L10
C2-C3
L11-L13
L14-L15

N 41°36'23" W 582.22'

CALLLED 2.467 ACRES
DICKINSON VILLAGE LTD.
H.C.C.F. NO. RP-2017-219195

RESIDUE OF A
CALLLED 54.116 AC.
HOUSTON LIGHTING &
POWER COMPANY
H.C.C.F. NO. L149363

S 48°23'37" W 1061.35'

JAMES M. MCGEE SURVEY
A-588
GULF, COLORADO
AND SANTA FE RAILROAD
COMPANY SURVEY
ABSTRACT-1301

CALLLED 35.135 ACRES
DOROTHY TREICHEL
H.C.C.F. NO. 20140509035

S 62°26'40" E 1350.10'

C1
L2

HILDEBRANDT ROAD
(60' RIGHT-OF-WAY)

L1

GENERAL NOTES

1. THIS DOCUMENT IS PREPARED UNDER 22 TAC 663.21, DOES NOT REFLECT THE RESULTS OF AN ON THE GROUND SURVEY, AND IS NOT TO BE USED TO CONVEY OR ESTABLISH INTERESTS IN REAL PROPERTY EXCEPT THOSE RIGHTS IMPLIED OR ESTABLISHED BY THE CREATION OR RECONFIGURATION OF THE BOUNDARY OF THE POLITICAL SUBDIVISION FOR WHICH IT WAS PREPARED.
2. BEARINGS WERE BASED ON THE DISTRICT BOUNDARY MAP OF HARRIS COUNTY DOWDELL P.U.D. (PUBLIC UTILITY DISTRICT), PREPARED BY MILLER SURVEY, GROUP, DATED 01-18-16.
3. THIS PLAT IS ACCOMPANIED BY A SEPARATE METES AND BOUNDS DESCRIPTION. (SEE SHEETS 2 OF 3 AND 3 OF 3)
4. THIS EXHIBIT DOES NOT IMPLY TO BE A LAND TITLE SURVEY OF THE SUBJECT PROPERTY AND IS NOT INTENDED TO BE USED FOR TITLE CONVEYANCE PURPOSES.

LINE TABLE

LINE	BEARING	DISTANCE
L1	S 00°14'56" E	67.83'
L2	N 62°26'40" W	499.53'
L3	S 03°23'37" W	28.28'
L4	N 41°36'23" W	100.01'
L5	S 86°36'23" E	21.21'
L6	N 41°36'23" W	15.00'
L7	N 48°23'37" E	10.00'
L8	S 86°36'23" E	14.14'
L9	N 48°23'37" E	158.02'
L10	S 35°46'13" W	108.97'
L11	S 41°36'23" E	7.00'
L12	S 48°23'37" W	20.00'
L13	N 41°36'23" W	4.76'
L14	N 41°36'23" W	44.45'
L15	N 41°34'04" W	2.07'

CURVE CHART

CURVE	RADIUS	DELTA	LENGTH	BEARING	CHORD
C1	270.00'	8°13'08"	38.73'	S 52°30'11" W	38.70'
C2	100.00'	14°53'14"	25.98'	S 28°19'40" W	25.91'
C3	135.00'	16°50'15"	39.67'	S 29°18'13" W	39.53'
C4	20.00'	14°33'14"	5.08'	S 38°09'16" W	5.07'

EXHIBIT OF
HARRIS COUNTY DOWDELL P.U.D.
(PUBLIC UTILITY DISTRICT)
ANNEXATION TRACT THIRTY FOUR 16.075 AC.
SITUATED IN THE
JAMES M. MCGEE SURVEY, A-588 &
THE GULF, COLORADO AND SANTA FE
RAILROAD COMPANY SURVEY, A-1301
HARRIS COUNTY, TEXAS

FIELD BY:	-	DATE:	02-22-17
DRAWN BY:	DG	REV:	07-25-17
CHECKED BY:	RPK	REV:	
JOB NO.	52801-P34_R1-16.075ac	REV:	
SHEET 1 OF 3		REV:	

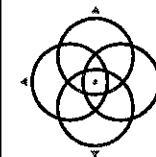

WINDROSE
LAND SURVEYING | PLATTING

3200 WILCREST, SUITE 325 | HOUSTON, TX 77042 | 713.458.2281
FIRM REGISTRATION NO. 10108800 | WINDROSESERVICES.COM

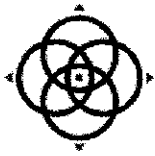

WINDROSE
LAND SURVEYING | PLATTING

**HARRIS COUNTY DOWDELL P.U.D. (PUBLIC UTILITY DISTRICT)
ANNEXATION TRACT THIRTY FOUR
16.075 ACRES**

A TRACT OR PARCEL CONTAINING 16.075 ACRES OF LAND SITUATED IN THE JAMES MCGEE SURVEY, ABSTRACT NO. 588 AND THE GULF COLORADO AND SANTA FE RAILROAD COMPANY SURVEY, ABSTRACT NO. 1301, HARRIS COUNTY, TEXAS, BEING THE SAME CALLED 16.075 ACRE TRACT CONVEYED TO HOME DEPOT U.S.A., INC., RECORDED UNDER HARRIS COUNTY CLERK'S FILE (H.C.C.F.) NO. RP-2017-218121, WITH SAID 16.075 ACRE TRACT BEING MORE PARTICULARLY DESCRIBED BY METES AND BOUNDS AS FOLLOWS;

BEGINNING AT A POINT AT THE INTERSECTION OF THE NORTHWESTERLY LINE OF SAID CALLED 16.075 ACRE TRACT AND THE NORTHEASTERLY RIGHT-OF-WAY (R.O.W.) LINE OF KUYKENDAHL ROAD (100 FOOT R.O.W.), FOR THE SOUTH CORNER OF A CALLED 4.3295 ACRE TRACT OF LAND CONVEYED TO STANLEY HOLLY CHEN, ET AL, RECORDED UNDER H.C.C.F. NO. M697019 AND THE WEST CORNER OF THE HEREIN DESCRIBED TRACT;

THENCE, NORTH 35 DEG. 46 MIN. 13 SEC. EAST, ALONG THE COMMON LINE OF SAID CALLED 16.075 ACRE TRACT AND SAID 4.3295 ACRE TRACT, A DISTANCE OF 883.55 FEET TO A POINT ON THE SOUTH LINE OF A CALLED 35.135 ACRE TRACT OF LAND CONVEYED TO DOROTHY TREICHEL, RECORDED UNDER H.C.C.F. NO. 20140509035, FOR THE EAST CORNER OF SAID 4.3295 ACRE TRACT, THE NORTH CORNER OF SAID CALLED 16.075 ACRE TRACT AND OF THE HEREIN DESCRIBED TRACT;

THENCE, SOUTH 62 DEG. 26 MIN. 40 SEC. EAST, ALONG THE COMMON LINE OF SAID CALLED 35.135 ACRE TRACT AND SAID CALLED 16.075 ACRE TRACT, A DISTANCE OF 1,350.10 FEET TO A POINT ON THE WEST R.O.W. LINE OF HILDEBRANDT ROAD, FOR THE SOUTHEAST CORNER OF SAID CALLED 35.135 ACRE TRACT, THE NORTHEAST CORNER OF SAID CALLED 16.075 ACRE TRACT, AND A NORTHEAST CORNER OF THE HEREIN DESCRIBED TRACT;

THENCE, SOUTH 00 DEG. 14 MIN. 56 SEC. EAST, ALONG THE WEST R.O.W. LINE OF SAID HILDEBRANDT ROAD, A DISTANCE OF 67.83 FEET TO A POINT FOR THE NORTHEAST CORNER OF THE RESIDUE OF A 54.116 ACRE TRACT CONVEYED TO HOUSTON LIGHTING & POWER, AS RECORDED IN H.C.C.F. NO. L149363 AND FOR A SOUTHEAST CORNER OF THE HEREIN DESCRIBED TRACT;

THENCE, NORTH 62 DEG. 26 MIN. 40 SEC. WEST, ALONG THE NORTHEAST LINE OF SAID RESIDUE OF A 54.116 ACRE TRACT, A DISTANCE OF 499.53 FEET TO THE BEGINNING OF A NON-TANGENT CURVE TO THE LEFT;

THENCE, ALONG THE NORTHWEST LINE OF SAID RESIDUE OF A 54.116 ACRE TRACT AND ALONG SAID CURVE TO THE LEFT, HAVING A RADIUS OF 270.00 FEET, A CENTRAL ANGLE OF 08 DEG. 13 MIN. 08 SEC., AN ARC LENGTH OF 38.73 FEET, AND A CHORD BEARING AND DISTANCE OF SOUTH 52 DEG. 30 MIN. 11 SEC. WEST – 38.70 FEET TO A POINT OF TANGENCY;

THENCE, CONTINUING ALONG THE NORTHWEST LINE OF SAID RESIDUE OF A 54.116 ACRE TRACT, SOUTH 48 DEG. 23 MIN. 37 SEC. WEST, A DISTANCE OF 1,061.35 FEET TO AN ANGLE POINT;

THENCE, SOUTH 03 DEG. 23 MIN. 37 SEC. WEST, A DISTANCE OF 28.28 FEET TO A POINT ON THE NORTHEASTERLY R.O.W. LINE OF SAID KUYKENDAHL ROAD FOR THE SOUTH CORNER OF SAID CALLED 16.075 ACRE TRACT AND OF THE HEREIN DESCRIBED TRACT;

THENCE, NORTH 41 DEG. 36 MIN. 23 SEC. WEST, ALONG THE NORTHEASTERLY R.O.W. LINE OF SAID KUYKENDAHL ROAD, A DISTANCE OF 100.01 FEET TO THE SOUTH CORNER OF A CALLED 2.467 ACRE TRACT CONVEYED TO DICKINSON VILLAGE LTD., RECORDED UNDER H.C.C.F. NO. RP-2017-219195 AND A SOUTH CORNER OF SAID CALLED 16.075 ACRE TRACT AND OF THE HEREIN DESCRIBED TRACT;

THENCE, ALONG THE COMMON LINES OF SAID CALLED 2.467 ACRE TRACT AND SAID CALLED 16.075 ACRE TRACT, THE FOLLOWING COURSES AND DISTANCES;

SOUTH 86 DEG. 36 MIN. 23 SEC. EAST, A DISTANCE OF 21.21 FEET TO A CORNER;

NORTH 41 DEG. 36 MIN. 23 SEC. WEST, A DISTANCE OF 15.00 FEET TO A CORNER;

NORTH 48 DEG. 23 MIN. 37 SEC. EAST, A DISTANCE OF 10.00 FEET TO A CORNER;

SOUTH 86 DEG. 36 MIN. 23 SEC. EAST, A DISTANCE OF 14.14 FEET TO A CORNER;

NORTH 48 DEG. 23 MIN. 37 SEC. EAST, A DISTANCE OF 158.02 FEET TO A CORNER;

NORTH 41 DEG. 36 MIN. 23 SEC. WEST, A DISTANCE OF 582.22 FEET TO A CORNER;

SOUTH 35 DEG. 46 MIN. 13 SEC. WEST, A DISTANCE OF 108.97 FEET TO THE BEGINNING OF A TANGENT CURVE TO THE LEFT;

IN A SOUTHWESTERLY DIRECTION AND ALONG SAID CURVE TO THE LEFT, HAVING A RADIUS OF 100.00 FEET, A CENTRAL ANGLE OF 14 DEG. 53 MIN. 14 SEC., AN ARC LENGTH OF 25.98 FEET, AND A CHORD BEARING AND DISTANCE OF SOUTH 28 DEG. 19 MIN. 40 SEC. WEST – 25.91 FEET TO THE BEGINNING OF A REVERSE CURVE TO THE RIGHT;

IN A SOUTHWESTERLY DIRECTION AND ALONG SAID CURVE TO THE RIGHT, HAVING A RADIUS OF 135.00 FEET, A CENTRAL ANGLE OF 16 DEG. 50 MIN. 15 SEC., AN ARC LENGTH OF 39.67 FEET, AND A CHORD BEARING AND DISTANCE OF SOUTH 29 DEG. 18 MIN. 13 SEC. WEST – 39.53 FEET TO THE END OF SAID CURVE;

SOUTH 41 DEG. 36 MIN. 23 SEC. EAST, A DISTANCE OF 7.00 FEET TO A CORNER;

SOUTH 48 DEG. 23 MIN. 37 SEC. WEST, A DISTANCE OF 20.00 FEET TO A CORNER;

NORTH 41 DEG. 36 MIN. 23 SEC. WEST, A DISTANCE OF 4.76 FEET TO BEGINNING OF A NON-TANGENT CURVE TO THE LEFT;

IN A SOUTHWESTERLY DIRECTION AND ALONG SAID CURVE TO THE LEFT, HAVING A RADIUS OF 20.00 FEET, A CENTRAL ANGLE OF 14 DEG. 33 MIN. 14 SEC., AN ARC LENGTH OF 5.08 FEET, AND A CHORD BEARING AND DISTANCE OF SOUTH 38 DEG. 09 MIN. 16 SEC. WEST – 5.07 FEET TO THE NORTHEASTERLY R.O.W. LINE OF SAID KUYKENDAHL ROAD, THE WEST CORNER OF SAID CALLED 2.467 ACRE TRACT, A WESTERLY CORNER OF SAID CALLED 16.075 ACRE TRACT AND OF THE HEREIN DESCRIBED TRACT;

THENCE, NORTH 41 DEG. 36 MIN. 23 SEC. WEST, ALONG THE NORTHEASTERLY R.O.W. LINE OF SAID KUYKENDAHL ROAD, A DISTANCE OF 44.45 FEET TO AN ANGLE POINT OF SAID CALLED 16.075 ACRE TRACT AND OF THE HEREIN DESCRIBED TRACT;

THENCE, NORTH 41 DEG. 34 MIN. 04 SEC. WEST, CONTINUING ALONG THE NORTHEASTERLY R.O.W. LINE OF SAID KUYKENDAHL ROAD, A DISTANCE OF 2.07 FEET TO THE **PLACE OF BEGINNING** AND CONTAINING 16.075 ACRES OF LAND.

NOTE: THIS DESCRIPTION IS PREPARED UNDER 22 TAC 663.21 AND IS NOT TO BE USED TO CONVEY OR ESTABLISH INTERESTS IN REAL PROPERTY EXCEPT THOSE RIGHTS IMPLIED OR ESTABLISHED BY THE CREATION OR RECONFIGURATION OF THE BOUNDARY OF THE POLITICAL SUBDIVISION FOR WHICH IT WAS PREPARED.

7/25/17



RONALD PATRICK KELL
R.P.L.S. NO. 6424
STATE OF TEXAS
FIRM REGISTRATION NO. 10108800

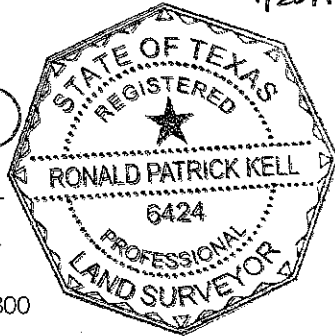

02-22-17
DATE:
REVISED: 07-25-17