

## Parcel Map

SUBJECT: Abandonment and sale of a 6 foot-wide water line easement and an 8 foot-wide sanitary sewer easement, in exchange for conveyance to the City of a 10 foot-wide sanitary sewer easement, all within Lot 8, Block 3, out of the Broad Oaks Addition, out of the Chas. Sage Survey, A-697. Parcels SY16-086A, SY16-086B, and DY16-075

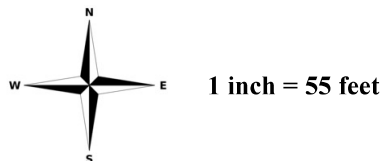
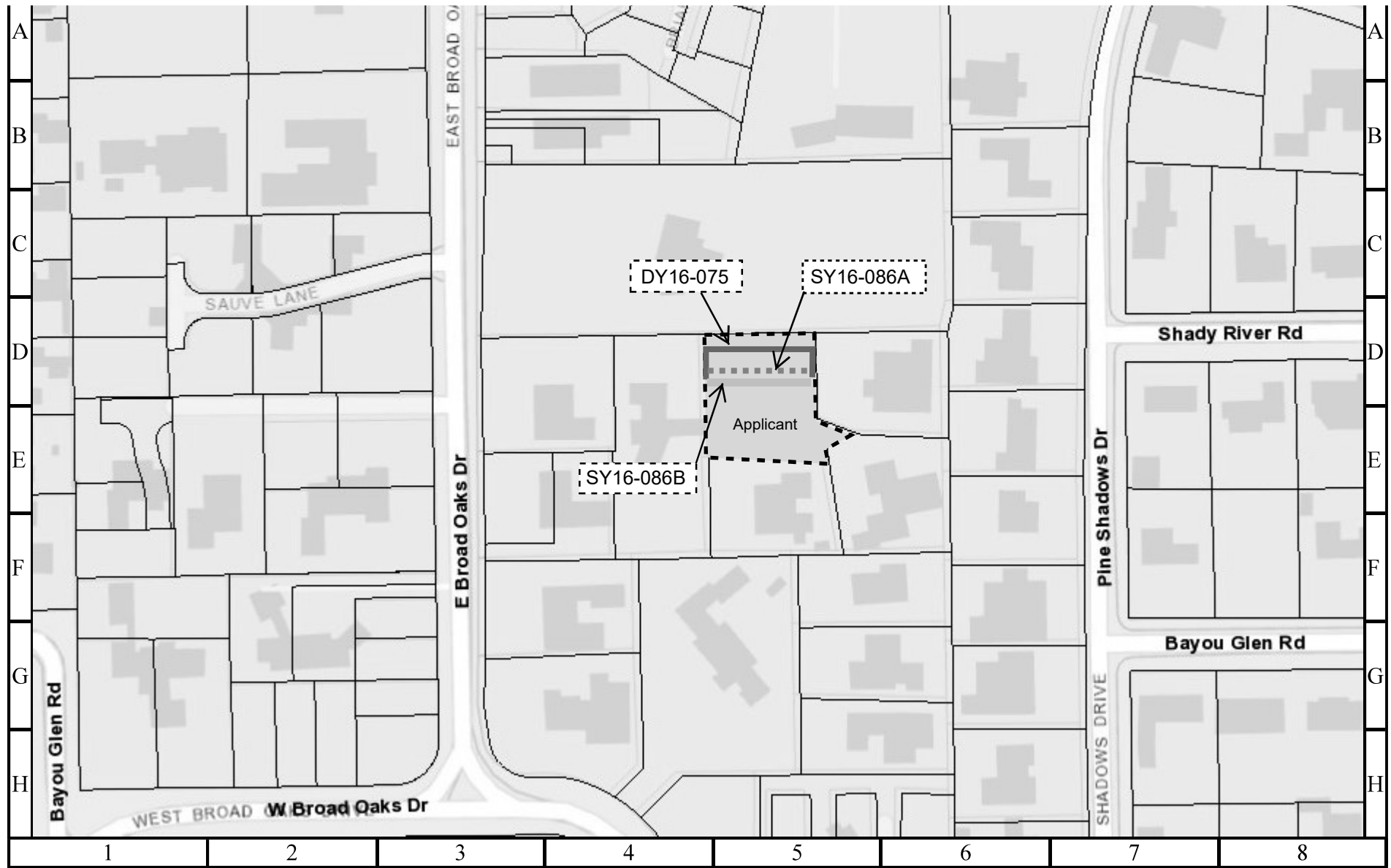

**CITY OF HOUSTON**  
Department of Public Works and Engineering  
Geographic Information & Management System (GIMS)

DISCLAIMER: THIS MAP REPRESENTS THE BEST INFORMATION AVAILABLE TO THE CITY.  
THE CITY DOES NOT WARRANT ITS ACCURACY OR COMPLETENESS.  
FIELD VERIFICATIONS SHOULD BE DONE AS NECESSARY.



Parcels Are Approximate