

VICINITY MAP OF PROPOSED TRACT TO BE ANNEXED
 INTO HARRIS COUNTY MUNICIPAL UTILITY DISTRICT NO. 278
 BEING 1.0338 ACRES OF LAND OUT OF THE
 W.W. WILLIAMS SURVEY, TRACT 1A, A-1311
 HARRIS COUNTY, TEXAS

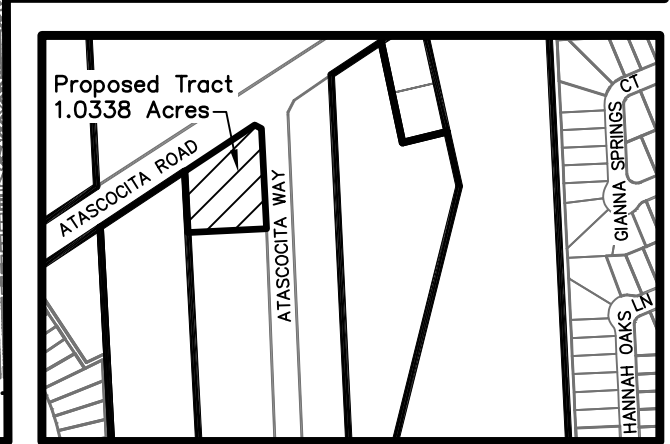



SCALE: 1"=0.5 MILE



DETAIL
 1"=500'

LEGEND:

-  M.U.D. NO. 278 BOUNDARY
-  PROPOSED ANNEXATION

LEGEND

- A = ASPHALT
- AG = AIR CONDITIONER
- BWF = DAMAGED WIRE FENCE
- C/CONC = CONCRETE
- CB = CABLE BOX
- CD = CLEAN OUT
- CLB = CENTERLINE OF DITCH
- CLF = CHAIN LINK FENCE
- CLRD = CENTERLINE OF ROAD
- DC = DOWN OUT
- EM = ELECTRIC METER
- EP = ELECTRIC PANEL
- EH = FIRE HYDRANT
- FOCM = FIBER OPTIC CABLE MARKER
- GB = GRADE BREAK
- GI = GRADE INLET
- GV = GAS VALVE
- GM = GAS METER
- GP = GAS POST
- GPML = GAS PIPELINE MARKER
- GRV = GRASS
- HR = HEAD WALL
- H.C.C.F. NO. = HARRIS COUNTY CLERK'S FILE NUMBER
- HW = HEAD WALL
- IL = IRON LID
- IP = IRON PIPE
- MP = METAL POLE
- M.P.F. = METAL POLE FENCE
- M.R.H.C. = MAP RECORDS OF HARRIS COUNTY
- LS = LIGHT STANDARD
- LP = POWER POLE
- RP = RETAINING WALL
- SGM = SIGN
- SL = SEPTIC LID
- STAMP = STONE MARKER
- SP = SERVICE POLE
- TOP = TOP OF CONCRETE
- TSS = TRAFFIC SIGNAL BOX
- TSP = TRAFFIC SIGNAL POLE
- ULC = UTILITY CASING
- UCMB = UNDERGROUND CABLE MARKER
- UCMA = UNDERGROUND CABLE MARKER
- WUP = WIRELINE TO UTILITY MARKER
- WLE = WATER LINE EASEMENT
- WM = WATER METER
- WP = WATER VALVE
- WP = WOOD POST

LINE	DISTANCE	BEARING
L1	218.82'	N 56°29'12" E
L2	19.82'	S 63°12'34" E
L3	269.82'	S 02°54'18" E (269.12')

BEARING:
FLOODPLAIN REFERENCE MARK NUMBER 150333 DESCRIBED AS FOLLOWS:
 Floodplain Reference Mark Number 150333 is a Brass Disk Stamped 150333 on bridge at Atascocita Road and F130-02-02 located on downtown S. Rowlett on Southwest end of Houston, N. of Harris Branch Sigs in Keylog 370F in the Greens Watershed near street F130-02-02.
 Deviation = 73.45' (RAW 1080, 2001 ADJ)
 TBM:
 Set 800 Nail in Power Pole in the Southwestly Right-of-Way Line of Atascocita Road as indicated herein.
 Deviation = 76.85'

- NOTES:**
1. This survey was performed in connection with the City Planning Order provided by North Star Title Company, L.P., Certificate No. 0118, Order No. 30, 2017.
 2. Bearing information based on Texas State Plane Coordinate GCS System of 1983, (South Central Zone No. 4294) derived from CORS sites 15043 and 24011.
 3. Surveyor did not abstract tract.
 4. () indicates deed or plat call.
 5. Based on graphical plotting on portion of this tract as shown a 100 year flood hazard area as depicted on The National Flood Insurance Program - Flood Insurance Rate Map issued by the Federal Emergency Management Agency under Community Panel Number 480287 0303 W for Harris County, Texas dated June 9, 2014. The 100 year flood hazard area is subject to change as detailed studies become available and/or extended or changed conditions change.
 6. Subject to City of Houston Ordinance 281-1878 enacted October 23, 1983 pertaining to the platting and recording of real property and establishment of building setbacks. A Certified Copy recorded under H.C.C.F. No. 1255004 and having been amended by Ordinance No. 1099-202, enacted February 17, 1990.
 7. Subject to an unobstructed earth easement 10' wide extending upward from an inclined plane and including plane, which represents the lower limits of the earth easement, begins at a height of 15' above the ground, adjacent to the 10' wide unobstructed easement and then continues upward to a height of 15'-2" as recorded under H.C.C.F. No. E728203.
 8. Natural ground elevations for the subject tract were established by others.
 9. H.L.S.P. 10' Easement subject to an unobstructed earth easement, 10 feet wide from a plane 16 feet above the ground upwards, located on both sides and adjoining Tract(s) (H.C.C.F. No. 5383001).
 10. Revised April 2, 2017 to show additional topographic information.
 11. Tract being more particularly described by separate notes and bounds. See HSC file number A17-023.005.
 12. Revised April 4, 2017 to reference notes and bounds, see note 11.



W. Williams
 Registered Professional Land Surveyor

HOVES SURVEYING COMPANY
 Land Surveys - Computer Mapping
 5200 Calhoun - Spring, Texas 77379
 (281) 350-0851
 Acreage - Resubdiv - Subdiv - Comm - Cont
 Texas Firm Registration No. 19030400

TOPOGRAPHIC SURVEY OF 1.0338 ACRES OF LAND SITUATED IN THE W.M. WILLIAMS SURVEY, ABSTRACT NUMBER 1311, HARRIS COUNTY, TEXAS.
 DATE MARCH 22, 2017 SCALE 1" = 40' JOB NO. 17-028-00

1702800.DWG
 HSC 01646-E-1
 USA 047-001-009-0002

