

Harris County

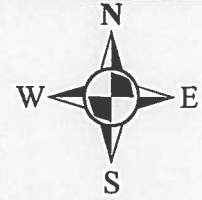

1 inch = 1,000 feet



**PROPOSED 120-INCH WATER LINE (1,650 LF)
S-000900-174A-3 (SUB-SEGMENT A)**

**CONNECT TO PROPOSED 108-INCH WATER LINE
S-000900-0154-3**

84-INCH WL

Council District B

NEWPP

**WHCRWA & NFBWA PROPOSED 96-INCH WATER LINE CONNECTION
S-000900-174B-3 (SUB-SEGMENT B)**

Council District E

8

Woodson Park

County Road 364.36

Lake Houston

County Road 38789
County Road 38005
County Road 38011

Lockwood

G103-15-00

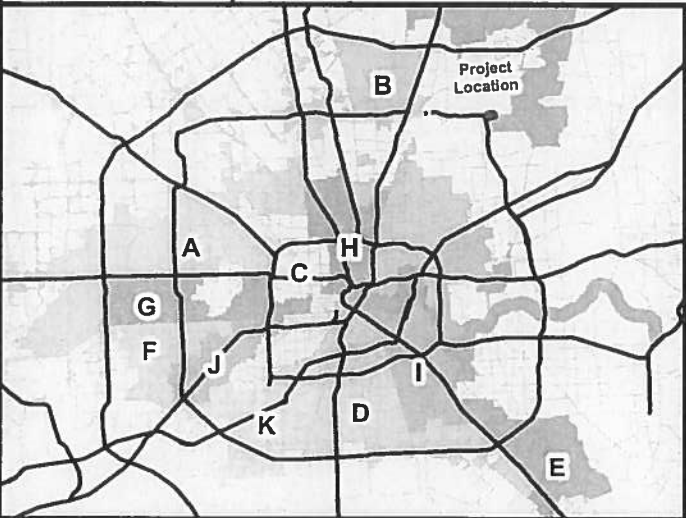

CITY OF HOUSTON

PROJECT LOCATION MAP

WBS No. S-000900-174A-3 & S-000900-174B-3
120-INCH WL ALONG CITY EASEMENTS FROM NEWPP
(FENCE) TO EAST OF UPRR & 96-INCH STUB-OUT

KEY MAP GRID(S): 376Z AND 377W
COUNCIL DISTRICT(S): E

- Butterfly
- Fire Station
- Police Station
- School
- Hospital

- S-000900-174A-3
- S-000900-174B-3
- Proposed 108" Waterline by Others
- Exist LD Water Line 24" and Larger



Contract 99A-1A
2925 Briarpark Drive
Houston, Tx 77042



Harris County

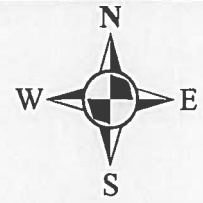

1 inch = 1,000 feet



PROPOSED 120-INCH WATER LINE (SEGMENT 1A)

WHCRWA & NFBWA PROPOSED 96-INCH WATER LINE CONNECTION (SEGMENT 1B)

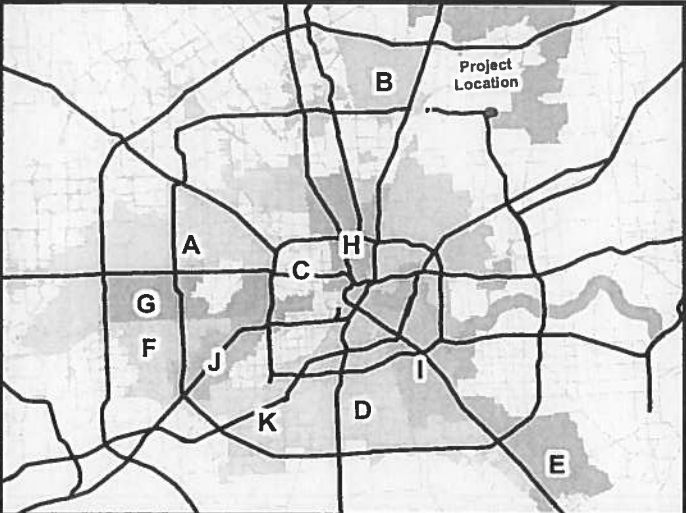
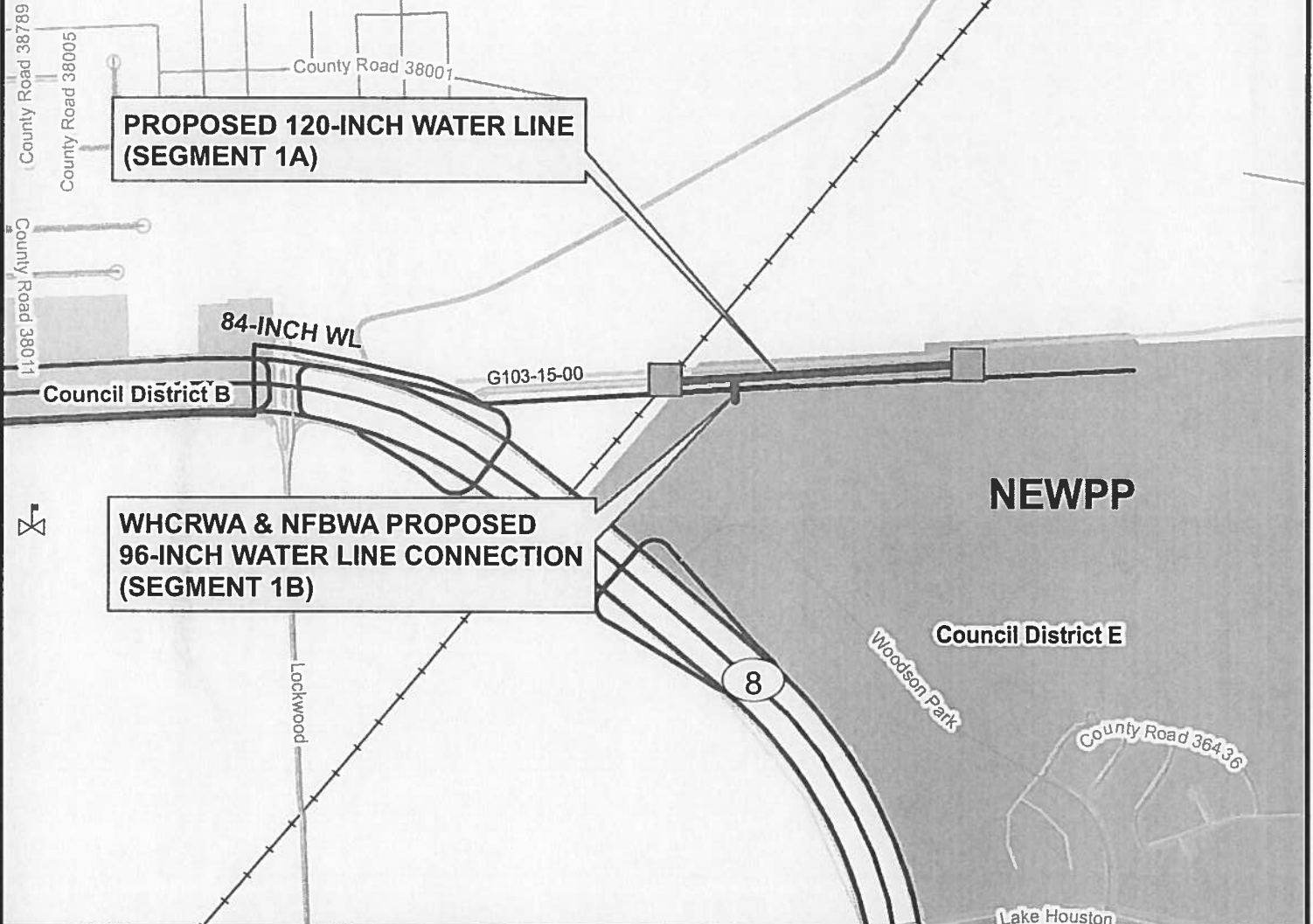

CITY OF HOUSTON

PROJECT LOCATION MAP

WBS No. S-000900-301A-3 & S-000900-301B-3

TECHNICAL SUPPORT FOR THE DESIGN OF NORTHEAST TRANSMISSION LINE - SEGMENT 1A and 1B

KEY MAP GRID(S): 376Z AND 377W

COUNCIL DISTRICT(S): E

- Butterfly
- Fire Station
- Police Station
- School
- Hospital

Segment 1 Streams

Exist LD Water Line 24" and Larger



Segment 1
2925 Briarpark Drive
Houston, Tx 77042



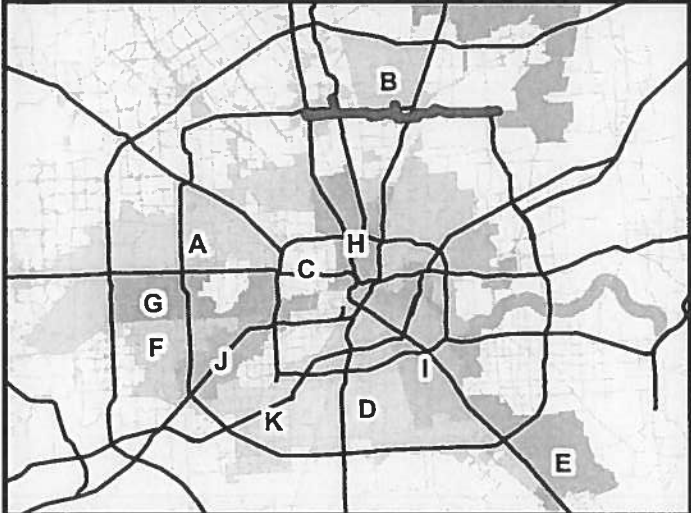
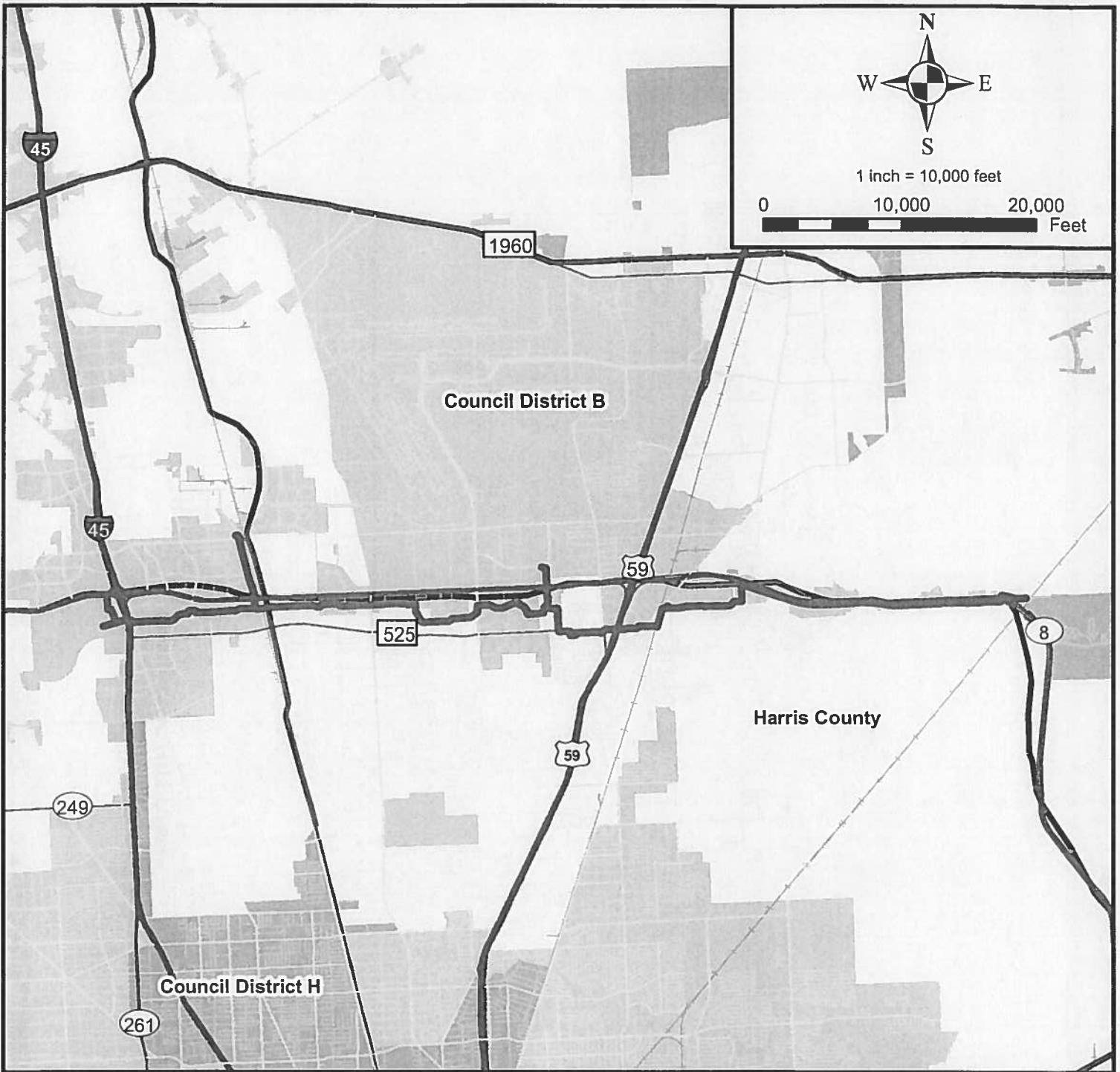

CITY OF HOUSTON PROJECT LOCATION MAP

WBS No. S-000701-0040-3

**CLEARING AND GRUBBING WORK ORDER FOR
NORTHEAST TRANSMISSION WATER LINES**

KEY MAP GRID(S): 372, 373, 374, 375, 376, 377
COUNCIL DISTRICT(S): B

NETL



Clearing and Grubbing
2925 Briarpark Drive
Houston, Tx 77042



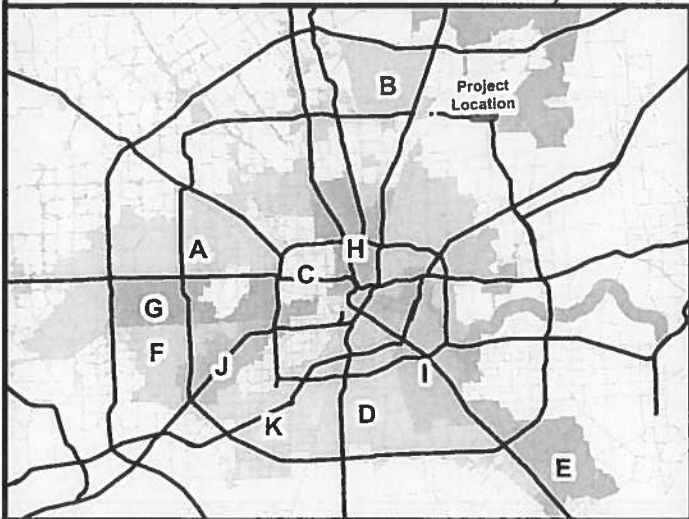
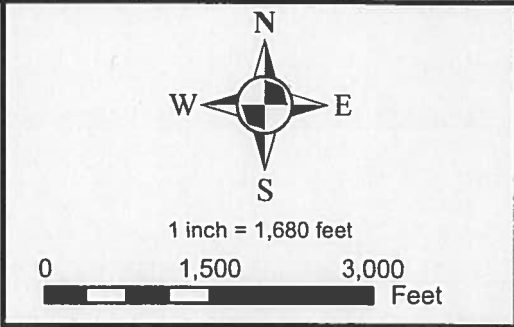
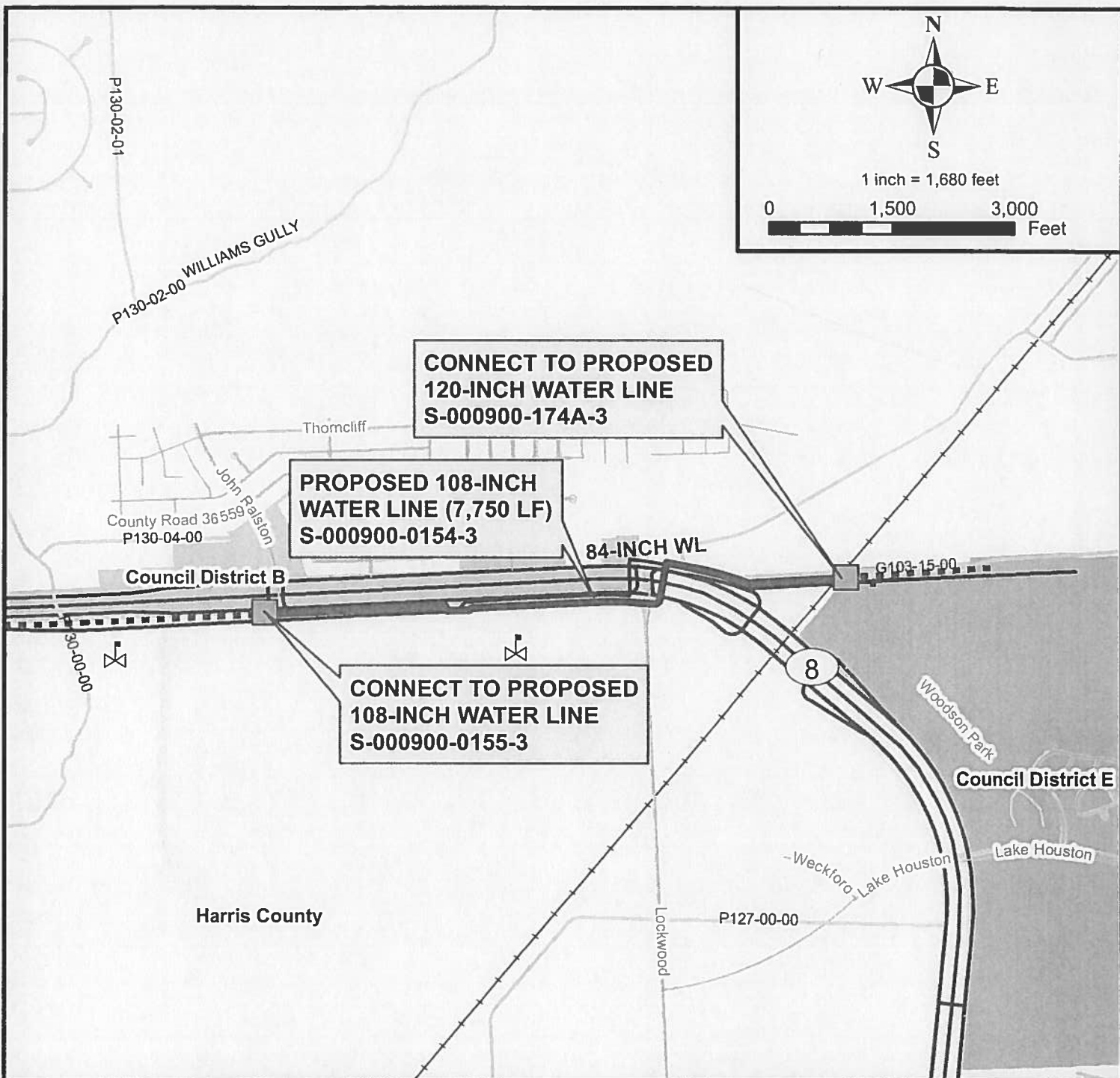

CITY OF HOUSTON PROJECT LOCATION MAP

WBS No. S-000900-0154-3
 108-INCH WL ALONG CITY EASEMENTS
 FROM UPRR TO JOHN RALSTON RD
 KEY MAP GRID(S): 376 X, Y, V, AND Z
 COUNCIL DISTRICT(S): B

- Butterfly
- Fire Station
- Police Station
- School
- Hospital
- S-000900-0154
- Streams
- Proposed 108" Water Line by Others
- Exist LD Water Line 24" and Larger



CONTRACT 99A-1B
 2925 Briarpark Drive
 Houston, Tx 77042



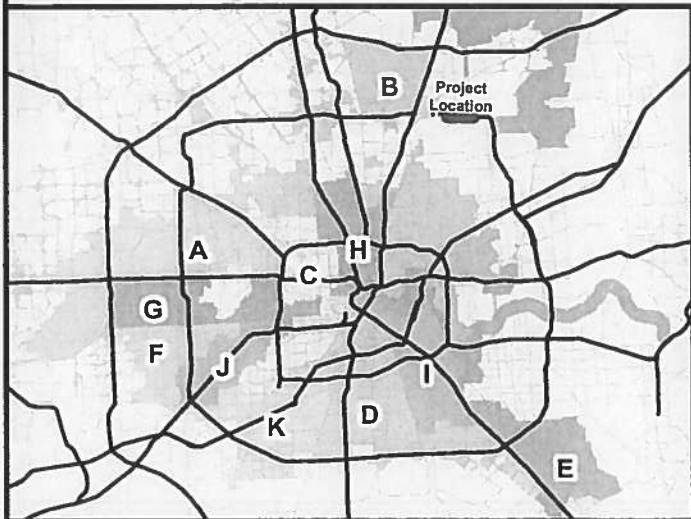
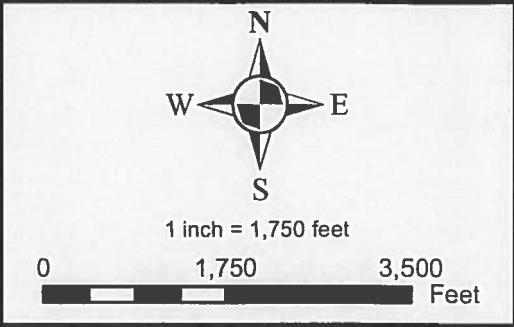
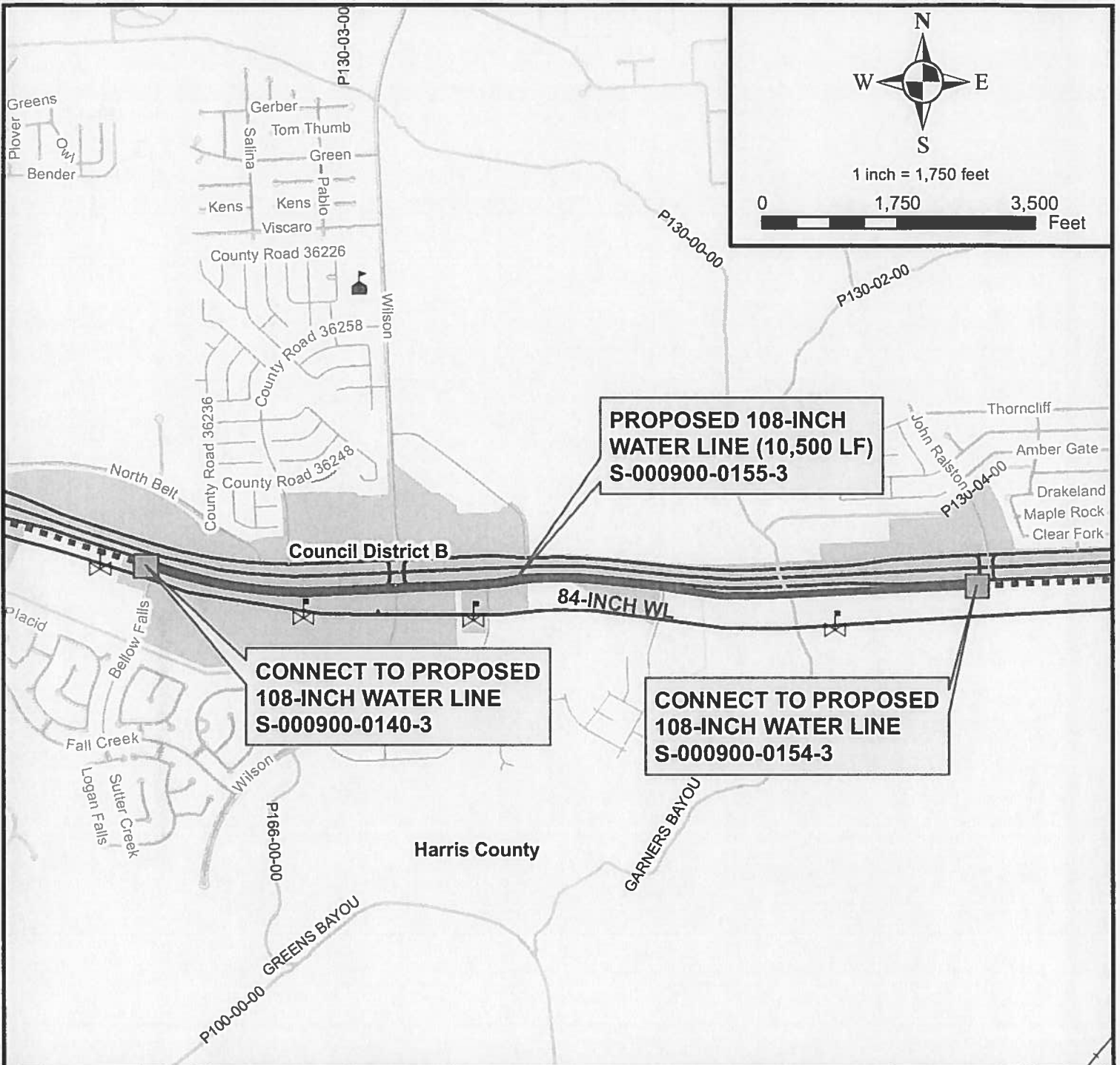

CITY OF HOUSTON PROJECT LOCATION MAP

WBS No. S-000900-0155-3
**108-INCH WL ALONG CITY EASEMENTS FROM
 JOHN RALSTON RD TO BELLOW FALLS LN**
 KEY MAP GRID(S): 375 V, AND Z, AND 376 W, AND X
 COUNCIL DISTRICT(S): B

	Butterfly		Fire Station		Police Station		School		Hospital
--	-----------	--	--------------	--	----------------	--	--------	--	----------

S-000900-0155 Streams
 Proposed 108" Waterline by Others
 Exist LD Water Line 24" and Larger

Contract 99A-2
 2925 Briarpark Drive
 Houston, Tx 77042

Surface Water Treatment Plant

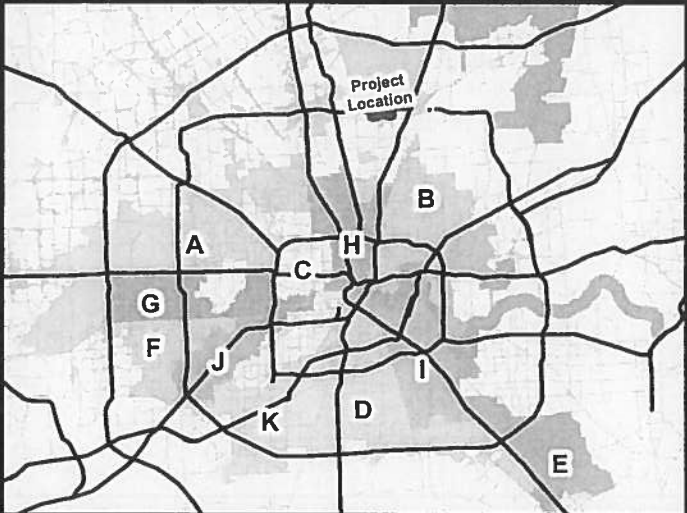
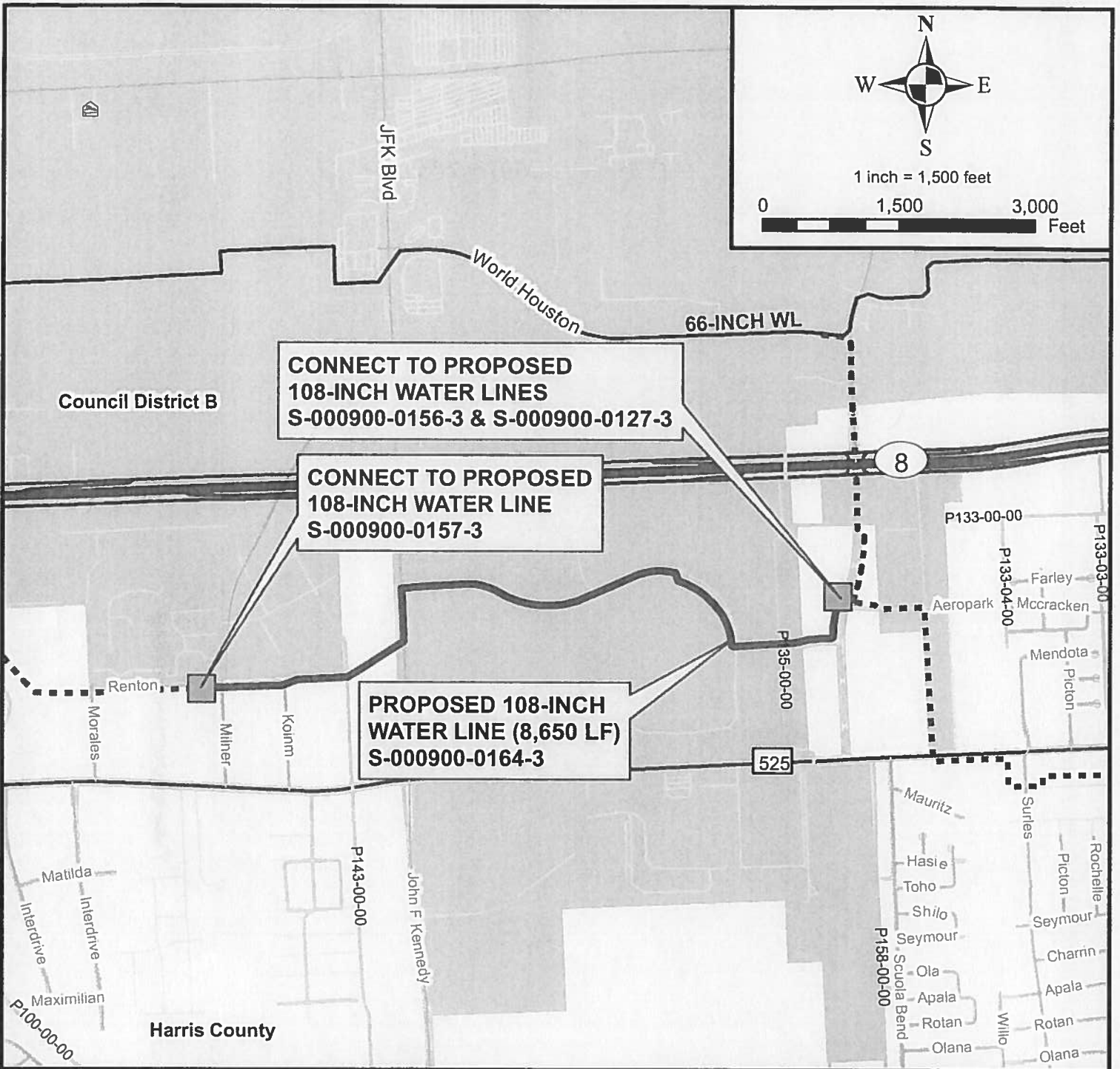

CITY OF HOUSTON PROJECT LOCATION MAP

WBS No. S-000900-0164-3

**108-INCH WL ALONG CITY EASEMENTS
FROM VICKERY DR TO MILNER RD**

KEY MAP GRID(S): 374S, X, T, AND U
COUNCIL DISTRICT(S): B

- Butterfly
- Fire Station
- Police Station
- School
- Hospital

- S-000900-0164
- Proposed 108" Water Line by Others
- Exist LD Water Line 24" and Larger
- Streams



CONTRACT 99C-2
2925 Briarpark Drive
Houston, Tx 77042



Surface Water Reclamation Program

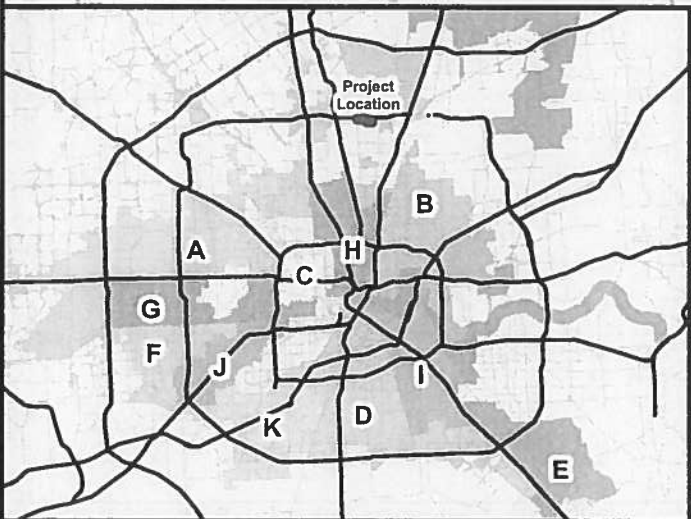
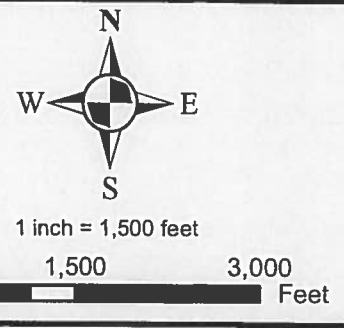
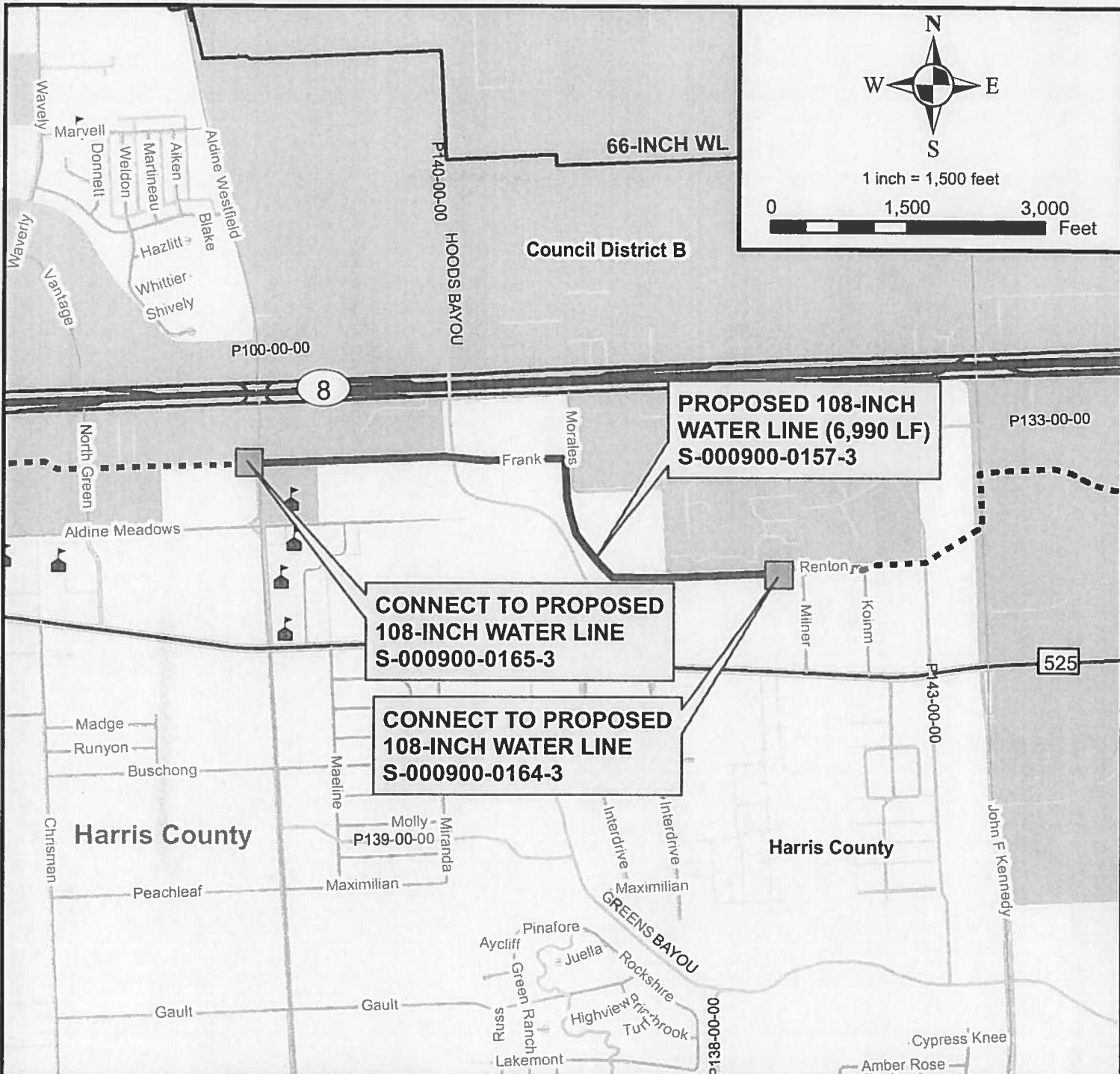

CITY OF HOUSTON PROJECT LOCATION MAP

WBS No. S-000900-0157-3
108-INCH WATER LINE ALONG CITY EASEMENTS
FROM MILNER RD TO ALDINE WESTFIELD RD

KEY MAP GRID(S): 373V, 374 S, AND W
COUNCIL DISTRICT(S): B

	Butterfly		Fire Station		Police Station		School		Hospital
--	-----------	--	--------------	--	----------------	--	--------	--	----------

S-000900-0157 Streams
 Proposed 108" Water Line by Others
 Exist LD Water Line 24" and Larger

CONTRACT 99D-1
 2925 Briarpark Drive
 Houston, Tx 77042

Surface Water Transmission Program

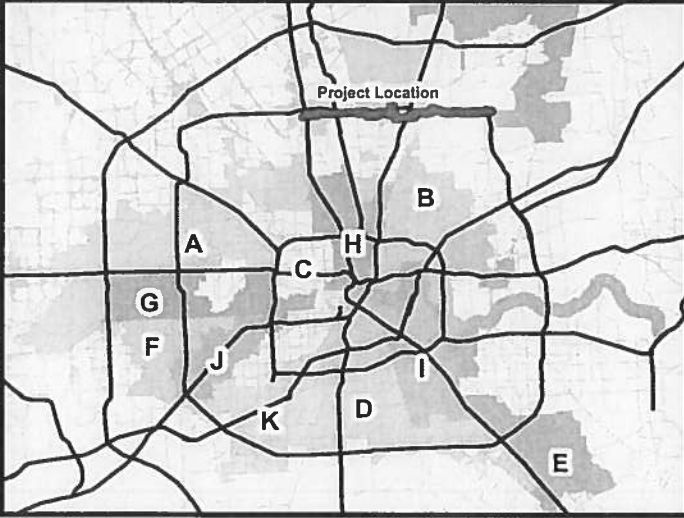
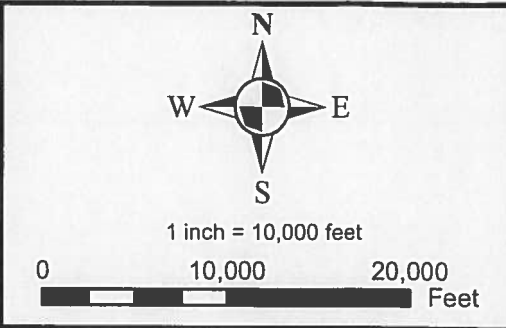
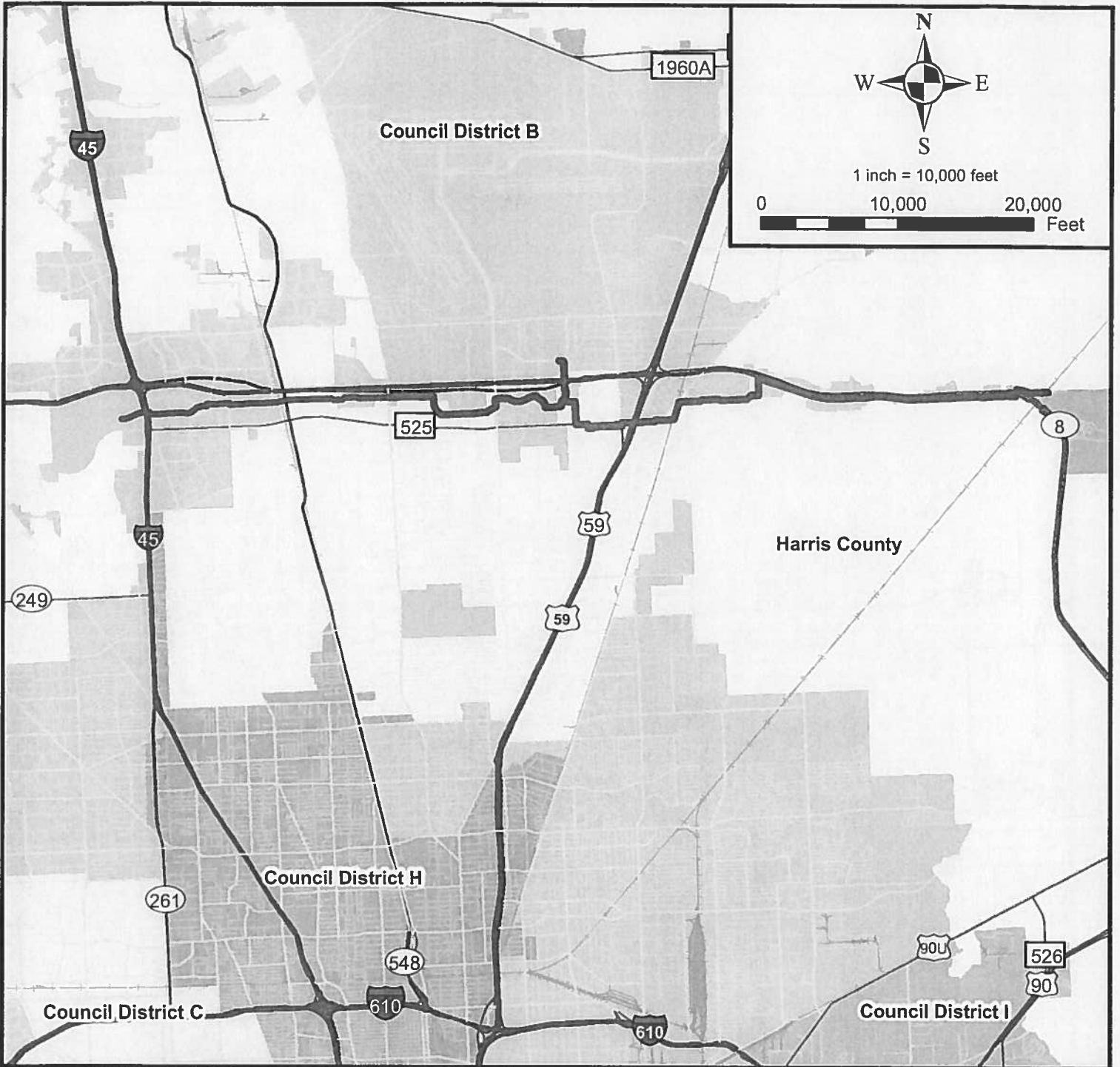

CITY OF HOUSTON PROJECT LOCATION MAP

WBS No. S-000900-0302-3

TECHNICAL SUPPORT FOR THE DESIGN OF NORTHEAST
TRANSMISSION LINE - SEGMENT 2

KEY MAP GRID(S): 372, 373, 374, 375, 376, 377
COUNCIL DISTRICT(S): B

 Segment 2



Segment 2
2925 Briarpark Drive
Houston, Tx 77042

