



Municipal Setting Designation

2014-069-CIP

Map

Legend

-  MSD Site Parcel
-  Community Center
-  Library

00 078.15 0.3 Miles

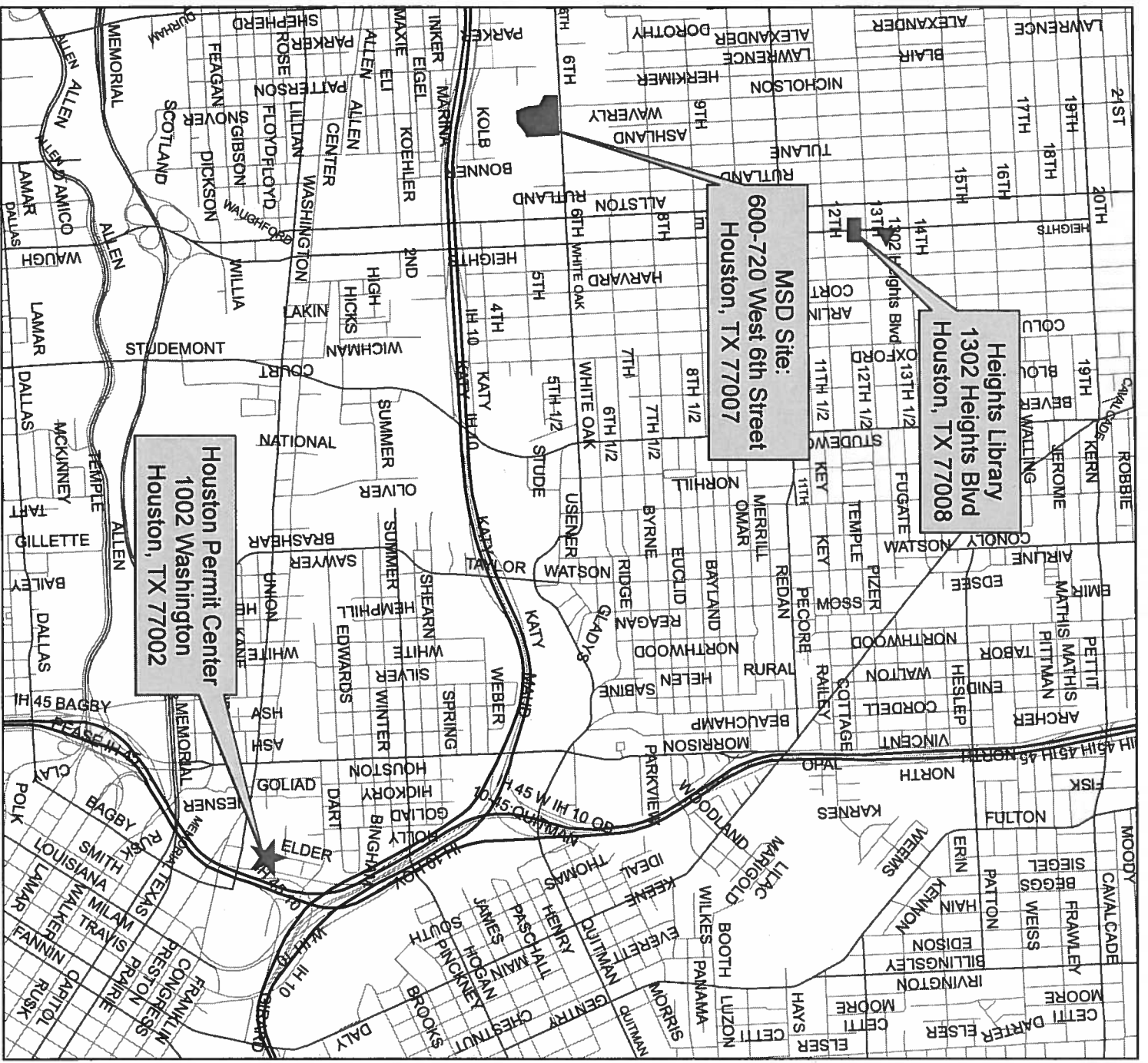
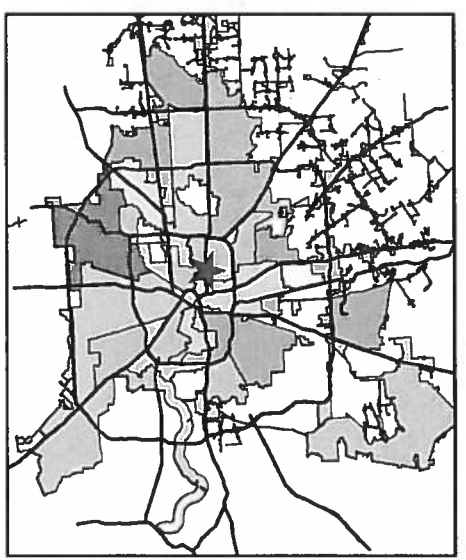

This map represents the best information available to the City. The City does not warrant its accuracy or completeness. Field verification should be performed as necessary.

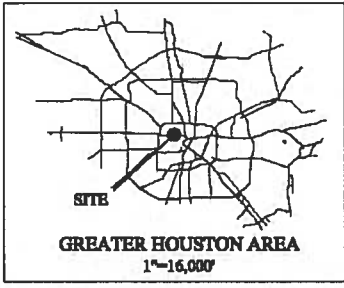

USGS TOPOGRAPHIC QUADRANGLE MAP
Houston Heights, Texas

Terracon
Consulting Engineers & Scientists

Topo Revised: 2010
Aerial Photo Revised: 2009

APPROXIMATE SCALE 1"= 2000'



Central Industrial Park
600-720 W. 6th Street
Houston, Texas

TERRACON PROJECT NO. 92137736

Prepared By: AD

Approved By: AN

FIGURE 1A:
LOCATION OF THE DESIGNATED PROPERTY

N:\ENV\dox\2013\Drafting\92137736\92137736 Figure 1A.dwg

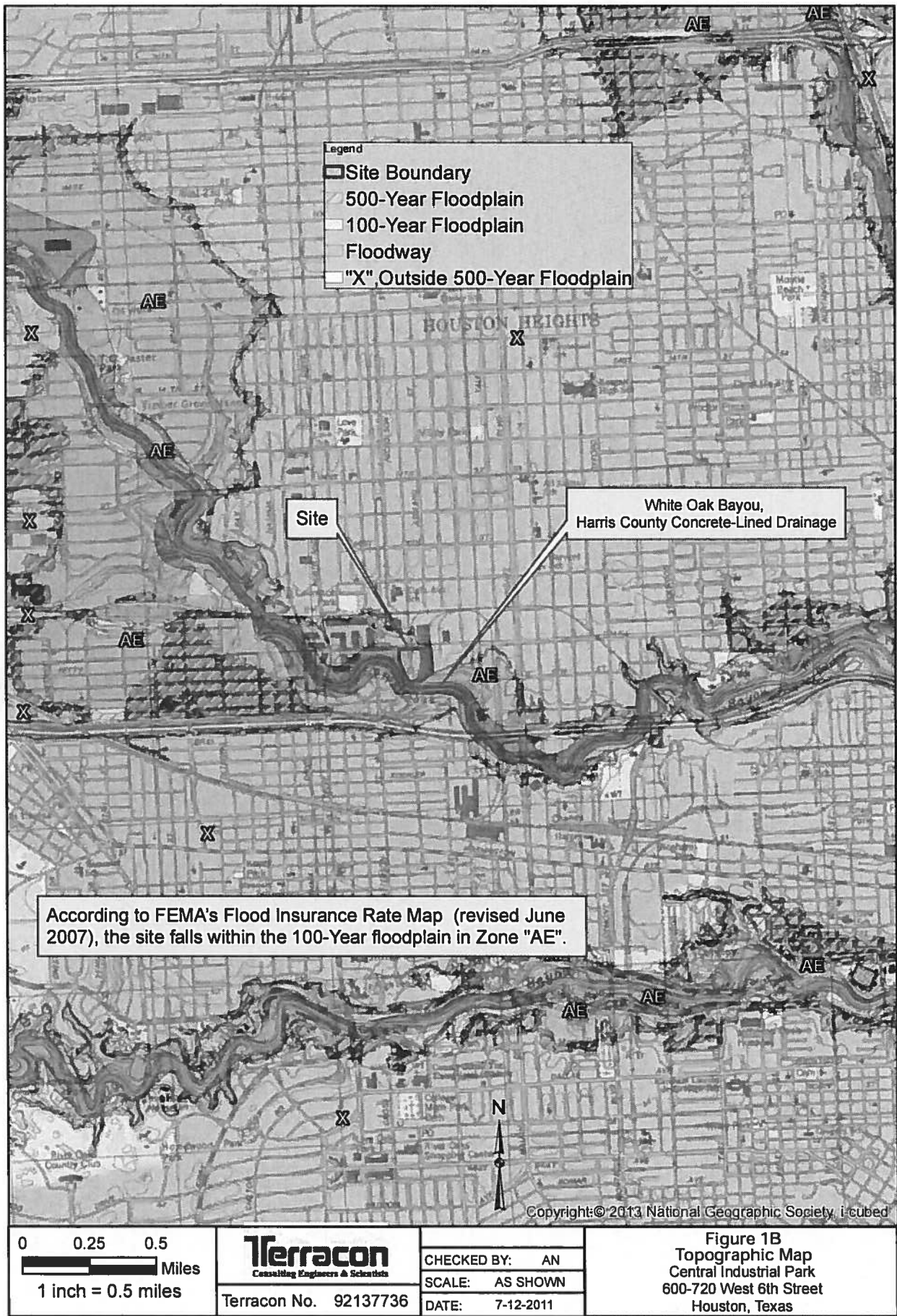

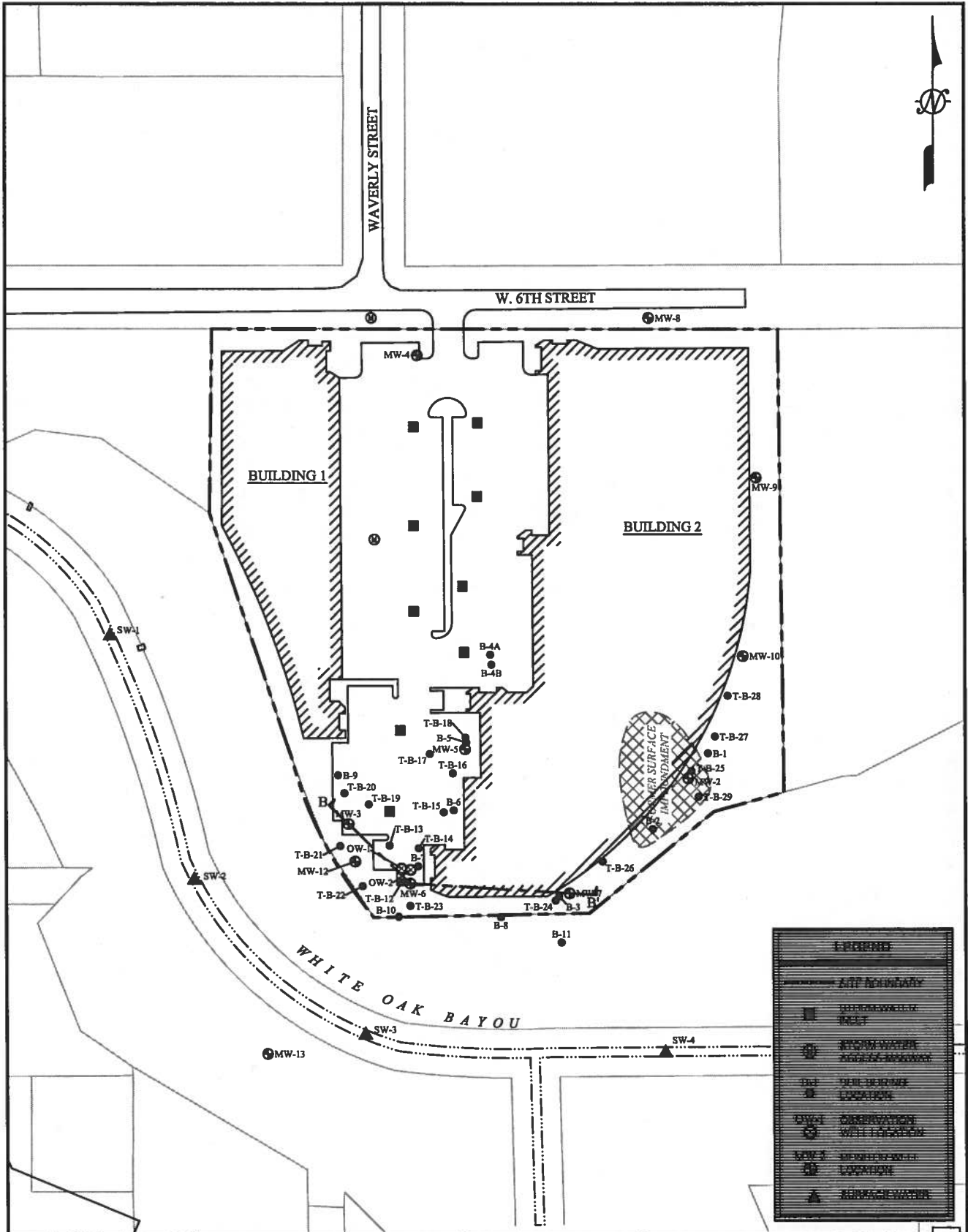

N:\ENV\dox\2013\Drafting\92137736\92137736 Figure 1D.dwg : Figure 1D

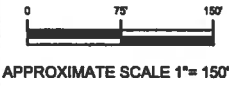

Terracon
Consulting Engineers & Scientists

TERRACON NO: 92137736

DRAWN BY:	AD
CHECKED BY:	AN
SCALE:	AS SHOWN
DATE:	12-2-2013

Figure 1D
Site Plan Showing Soil Borings and Monitor Wells
Central Industrial Park
600-720 W. 6th Street
Houston, Texas

N:\ENV\dox\2013\Drafting\92137736\92137736 Figure 1E-1.dwg : Figure 1E-1

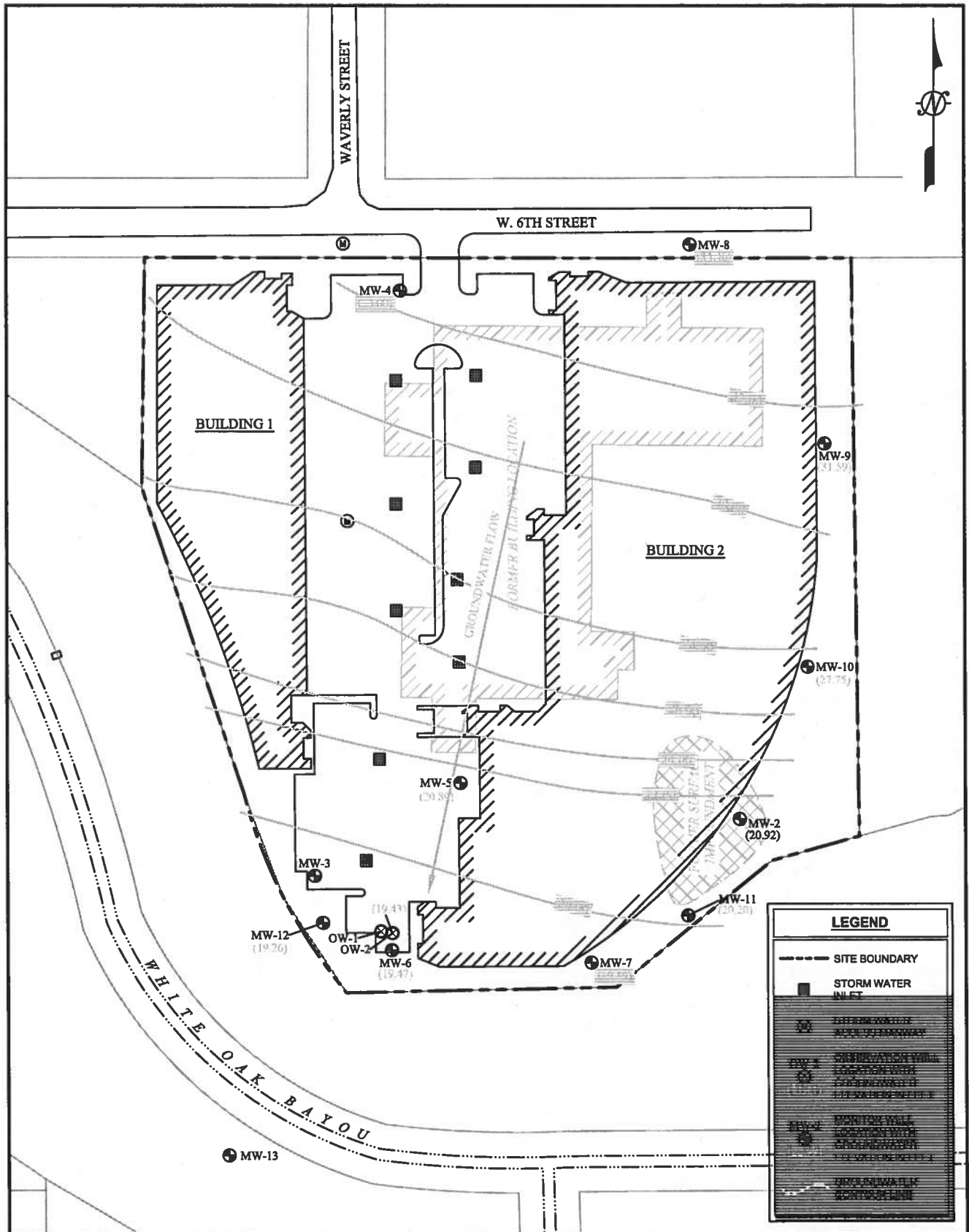

0 60' 120'
APPROXIMATE SCALE 1"= 120'

Terracon
Consulting Engineers & Scientists
TERRACON NO: 92137736

DRAWN BY: AD
CHECKED BY: AN
SCALE: AS SHOWN
DATE: 11-19-2013

Figure 1E-1
Groundwater Gradient Map
March 19, 2013
Central Industrial Park
600-720 W. 6th Street
Houston, Texas

N:\ENV\2013\Drafting\92137736\92137736 Figure 1E-2.dwg : Less OW-1

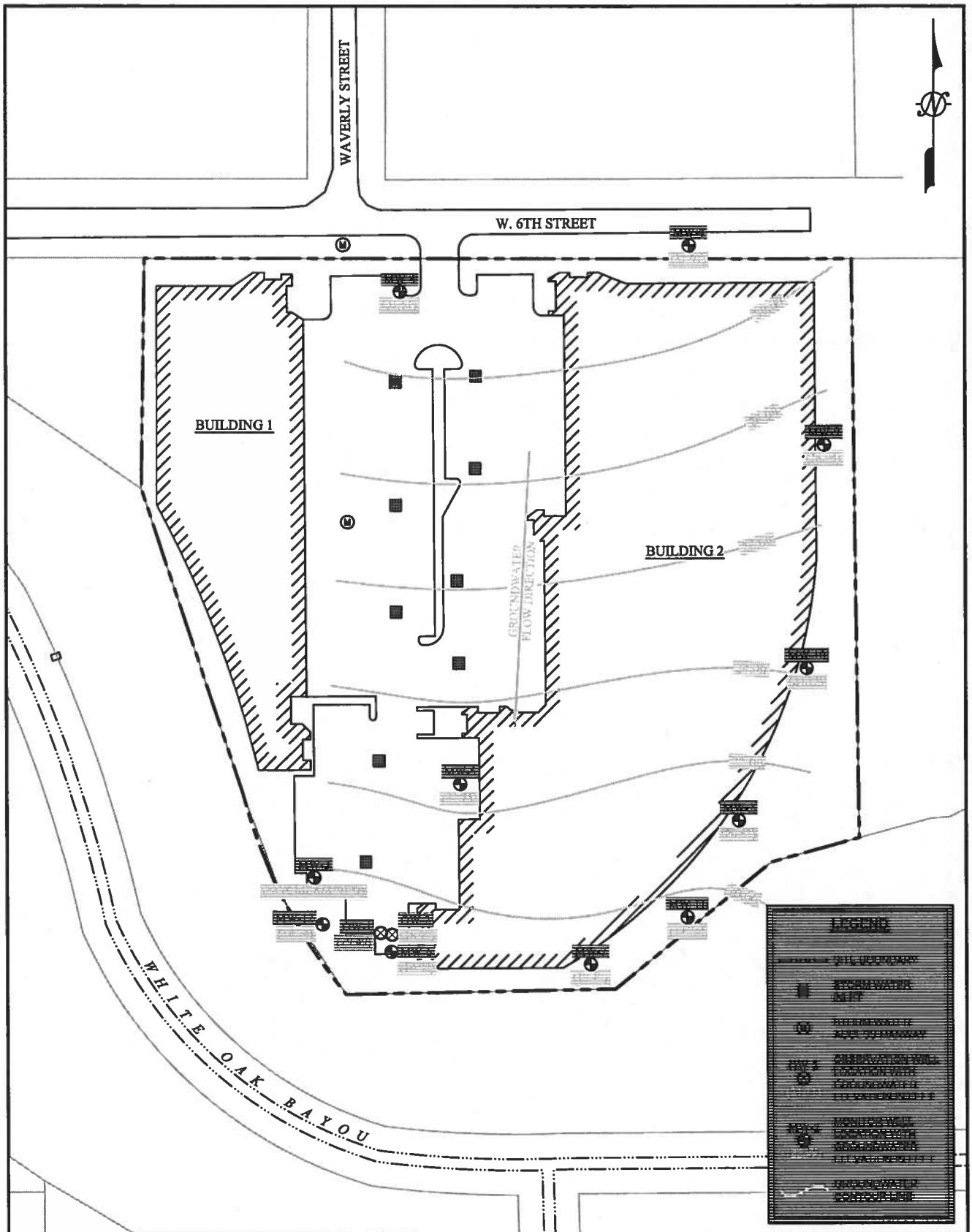

0 60' 120'
APPROXIMATE SCALE 1"= 120'

Terracon
Consulting Engineers & Scientists

TERRACON NO: 92137736

DRAWN BY:	AD
CHECKED BY:	AN
SCALE:	AS SHOWN
DATE:	12-2-2013

Figure 1E-2
Groundwater Gradient Map
October 28, 2011
Central Industrial Park
600-720 W. 6th Street
Houston, Texas

N:\ENV\dox\2013\Drafting\92137736\92137736 Figure 1E-3.dwg : Less OW-1

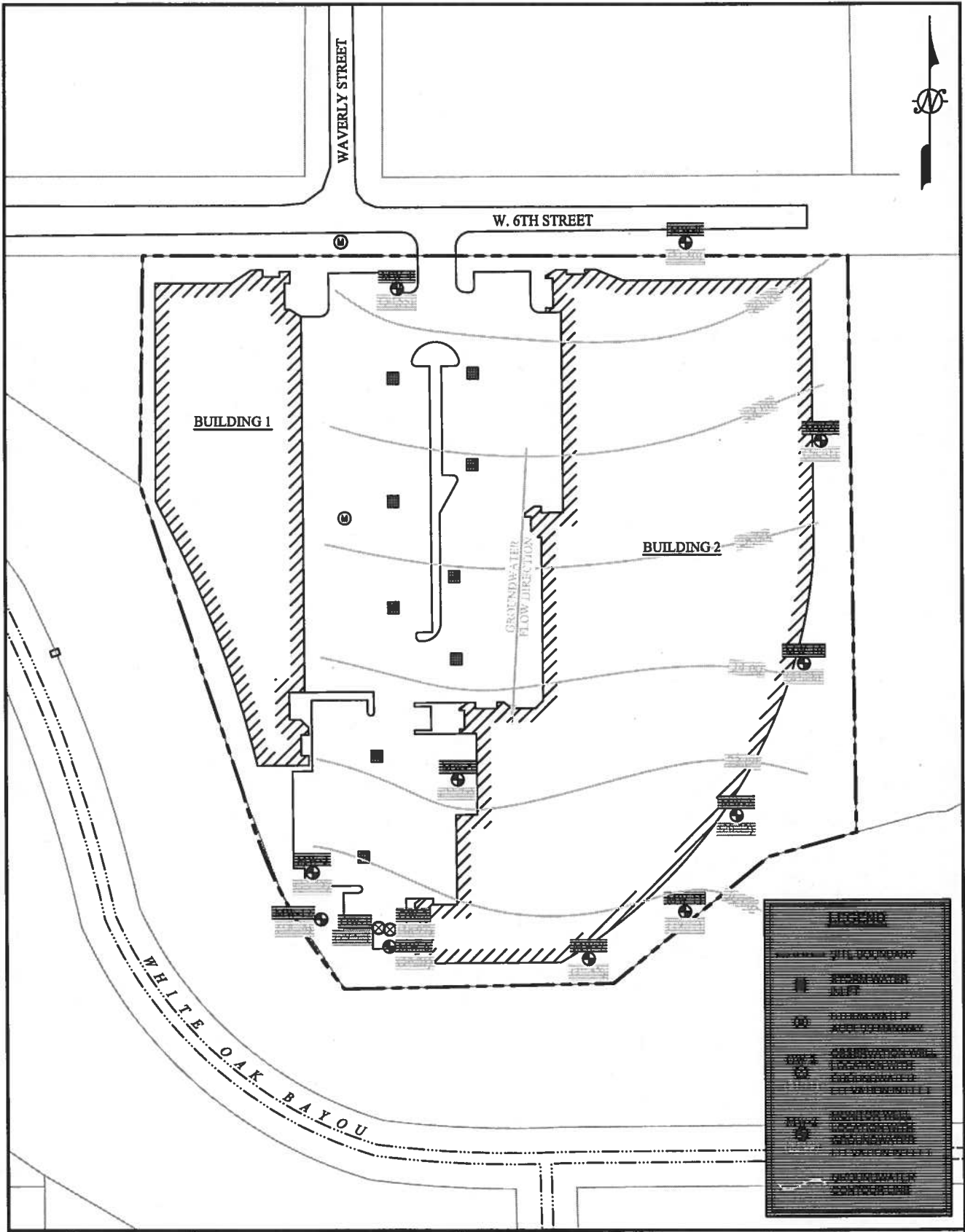

LEGEND	
	UTILITY
	FRESHWATER WELL
	FRESHWATER WELL
	OBSERVATION WELL
	OBSERVATION WELL
	MONITOR WELL
	MONITOR WELL
	GROUNDWATER CONTOUR LINE

APPROXIMATE SCALE 1" = 120'

Terracon
 Consulting Engineers & Scientists
 TERRACON NO: 92137736

DRAWN BY:	AD
CHECKED BY:	AN
SCALE:	AS SHOWN
DATE:	12-2-2013

Figure 1E-3
 Groundwater Gradient Map
 July 20, 2011
 Central Industrial Park
 600-720 W. 6th Street
 Houston, Texas

N:\env\dox\2013\Drafting\92137736\92137736 Figure 1E-4.dwg : Less OW-1

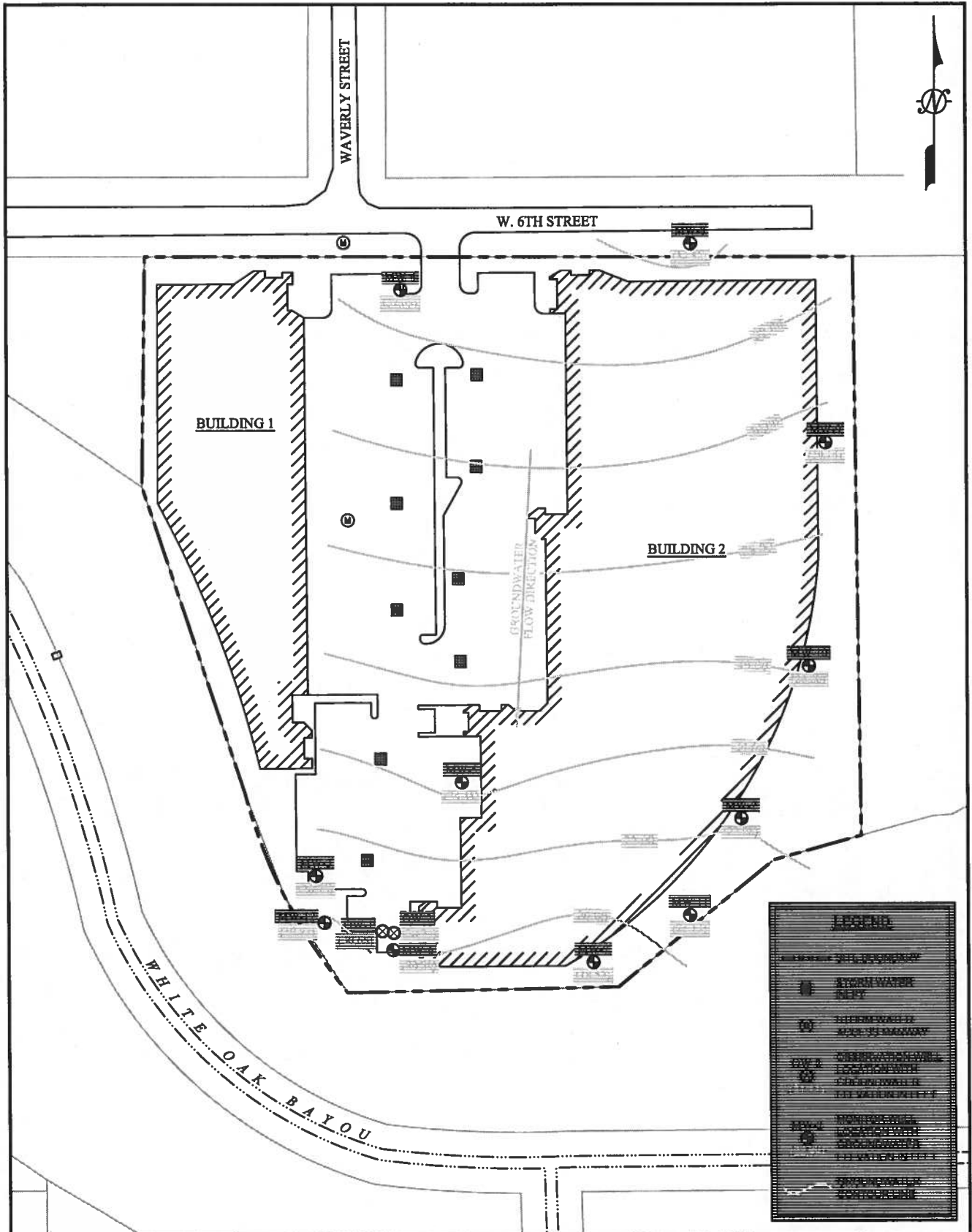

Terracon
Consulting Engineers & Scientists

TERRACON NO: 92137736

DRAWN BY:	AD
CHECKED BY:	AN
SCALE:	AS SHOWN
DATE:	12-2-2013

Figure 1E-4
Groundwater Gradient Map
October 19, 2010
Central Industrial Park
600-720 W. 6th Street
Houston, Texas

N:\ENV\dox\2013\Drafting\92137736\92137736 Figure 1E-5.dwg : Less OW-1

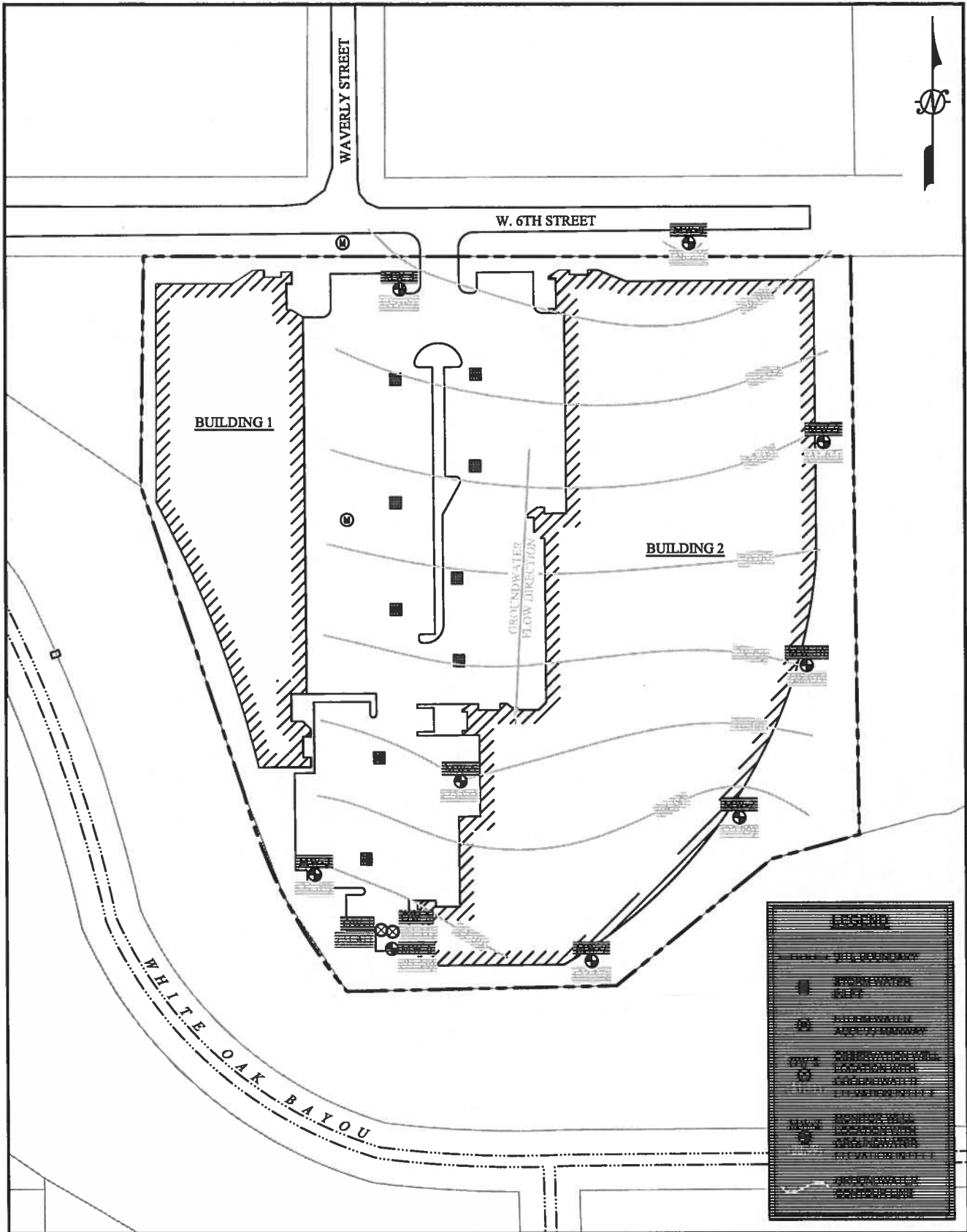

0 60' 120'
APPROXIMATE SCALE 1" = 120'

Terracon
Consulting Engineers & Scientists
TERRACON NO: 92137736

DRAWN BY: AD
CHECKED BY: AN
SCALE: AS SHOWN
DATE: 12-2-2013

Figure 1E-5
Groundwater Gradient Map
January 20, 2010
Central Industrial Park
600-720 W. 6th Street
Houston, Texas

N: \\ENV\dox\2013\Drafting\92137736\92137736 Figure 1E-6.dwg : No OWs

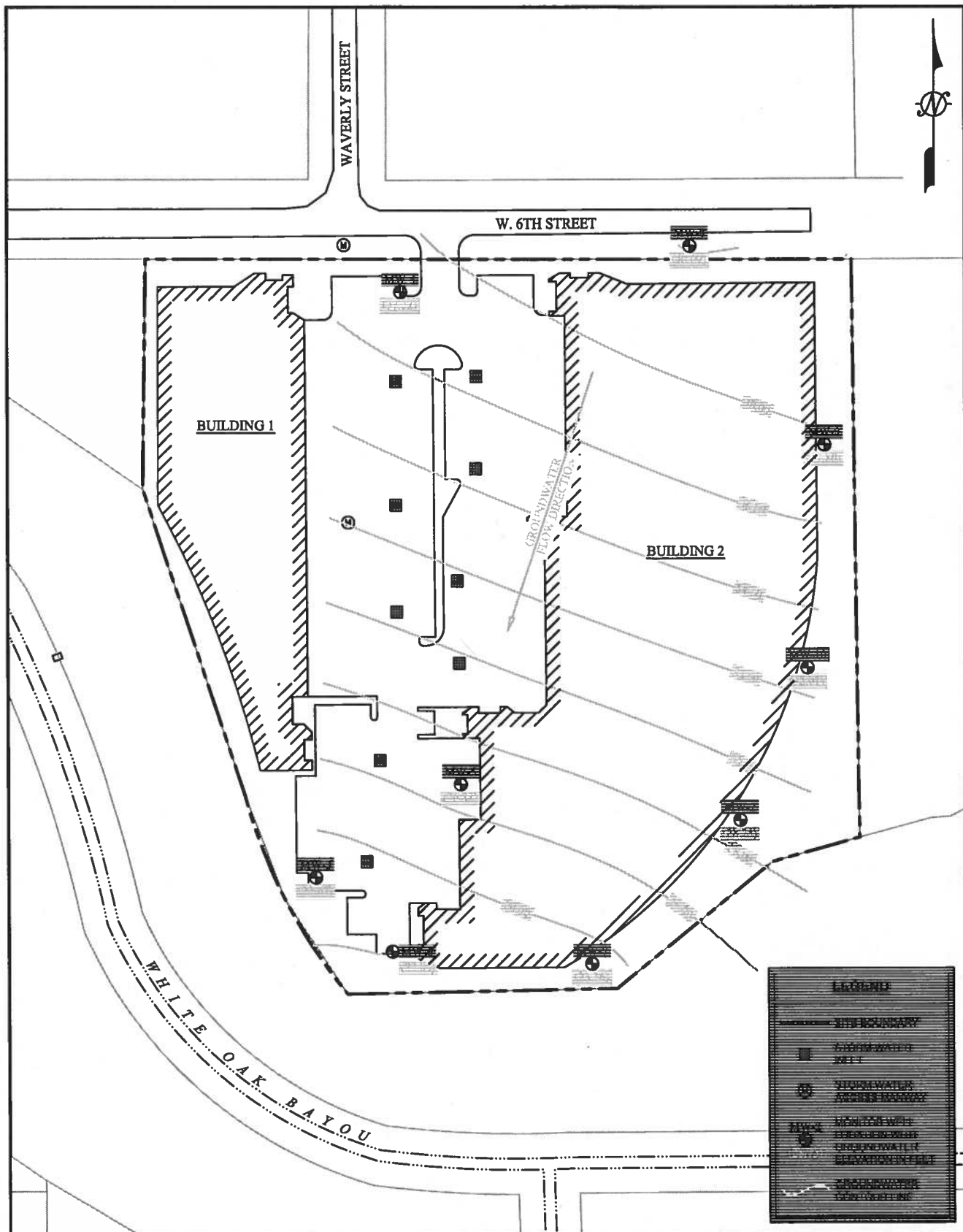

0 60' 120'
APPROXIMATE SCALE 1" = 120'

Terracon
Consulting Engineers & Scientists

TERRACON NO: 92137736

DRAWN BY:	AD
CHECKED BY:	AN
SCALE:	AS SHOWN
DATE:	11-19-2013

Figure 1E-6
Groundwater Gradient Map
March 11, 2008
Central Industrial Park
600-720 W. 6th Street
Houston, Texas

N:\ENV\dox\2013\Drafting\92137736\92137736 Figure 1F-1.dwg : Figure 1F-1

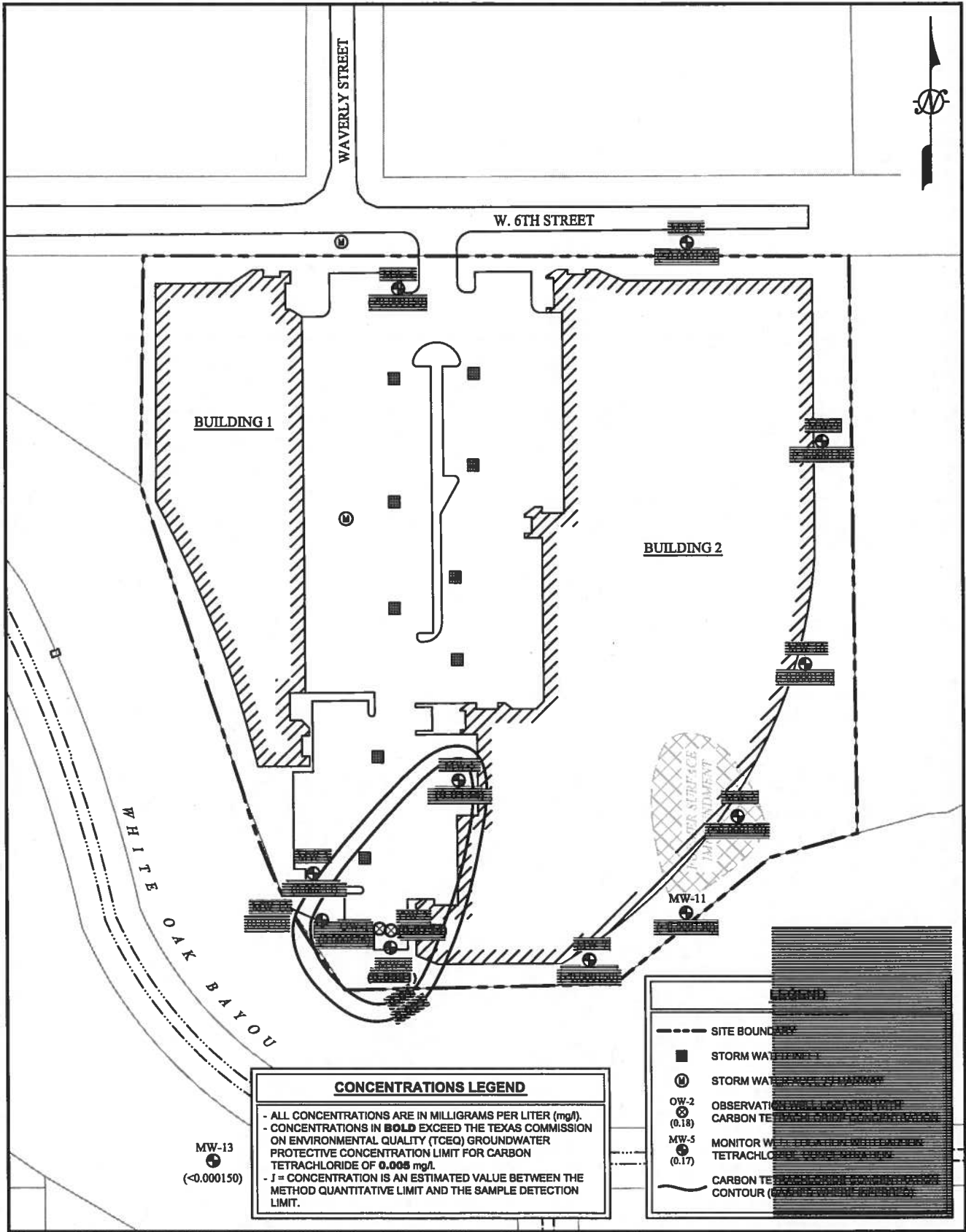

Terracon
Consulting Engineers & Scientists

TERRACON NO: 92137736

DRAWN BY: AD
CHECKED BY: AN
SCALE: AS SHOWN
DATE: 12-2-2013

Figure 1F-1
Groundwater COC Conc. Map - Carbon Tetrachloride
(March, 2013)
Central Industrial Park
600-720 W. 6th Street
Houston, Texas

N: \\ENV\dox\2013\Drafting\92137736\92137736 Figure 1F-2.dwg : Figure 1F-2

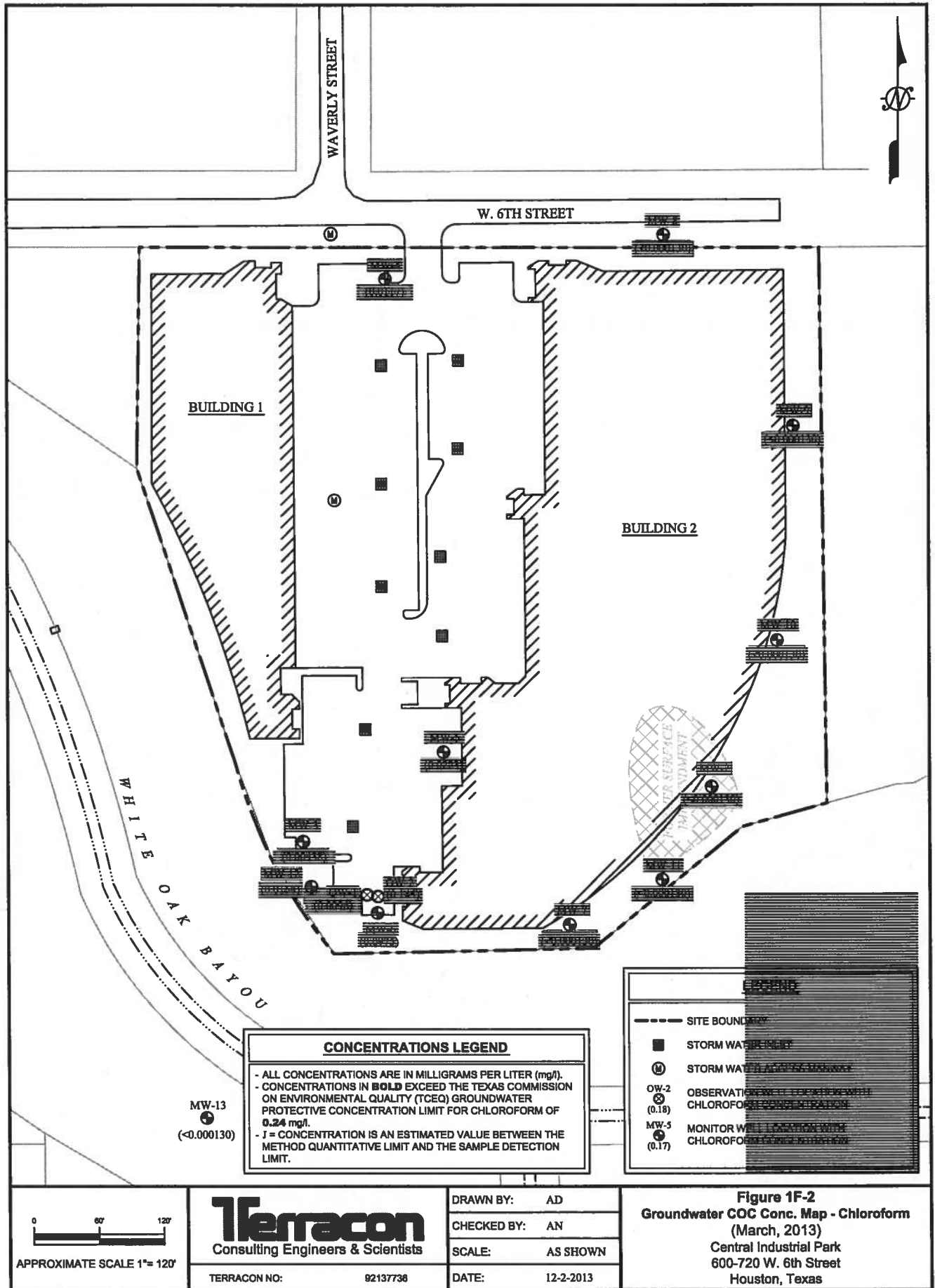

CONCENTRATIONS LEGEND

- ALL CONCENTRATIONS ARE IN MILLIGRAMS PER LITER (mg/l).
- CONCENTRATIONS IN **BOLD** EXCEED THE TEXAS COMMISSION ON ENVIRONMENTAL QUALITY (TCEQ) GROUNDWATER PROTECTIVE CONCENTRATION LIMIT FOR CHLOROFORM OF **0.24 mg/l**.
- J = CONCENTRATION IS AN ESTIMATED VALUE BETWEEN THE METHOD QUANTITATIVE LIMIT AND THE SAMPLE DETECTION LIMIT.

LEGEND

- SITE BOUNDARY
- STORM WATER TREATMENT BASIN
- ⊕ STORM WATER TREATMENT BASIN
- OW-2 OBSERVATION WELL WITH CHLOROFORM CONCENTRATION
- MW-5 MONITOR WELL WITH CHLOROFORM CONCENTRATION

0 60' 120'

APPROXIMATE SCALE 1" = 120'

Terracon
Consulting Engineers & Scientists

TERRACON NO: 92137736

DRAWN BY: AD
CHECKED BY: AN
SCALE: AS SHOWN
DATE: 12-2-2013

Figure 1F-2
Groundwater COC Conc. Map - Chloroform
(March, 2013)
Central Industrial Park
600-720 W. 6th Street
Houston, Texas

N:\ENV\dox\2013\Drafting\92137736\92137736 Figure 1F-3.dwg : Figure 1F-3

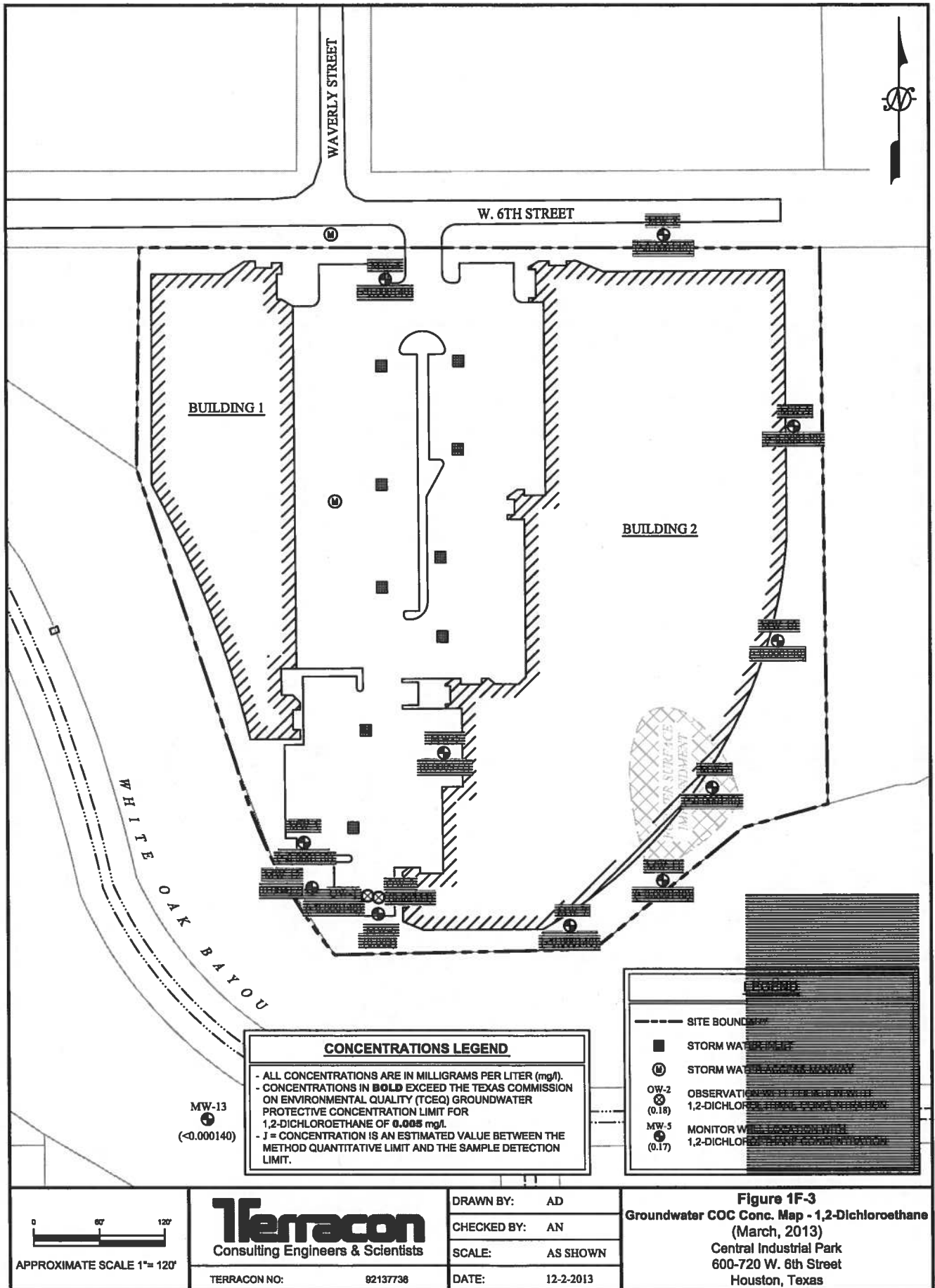

N:\ENV\dox\2013\Drafting\92137736\92137736 Figure 1F-4.dwg : Figure 1F-4

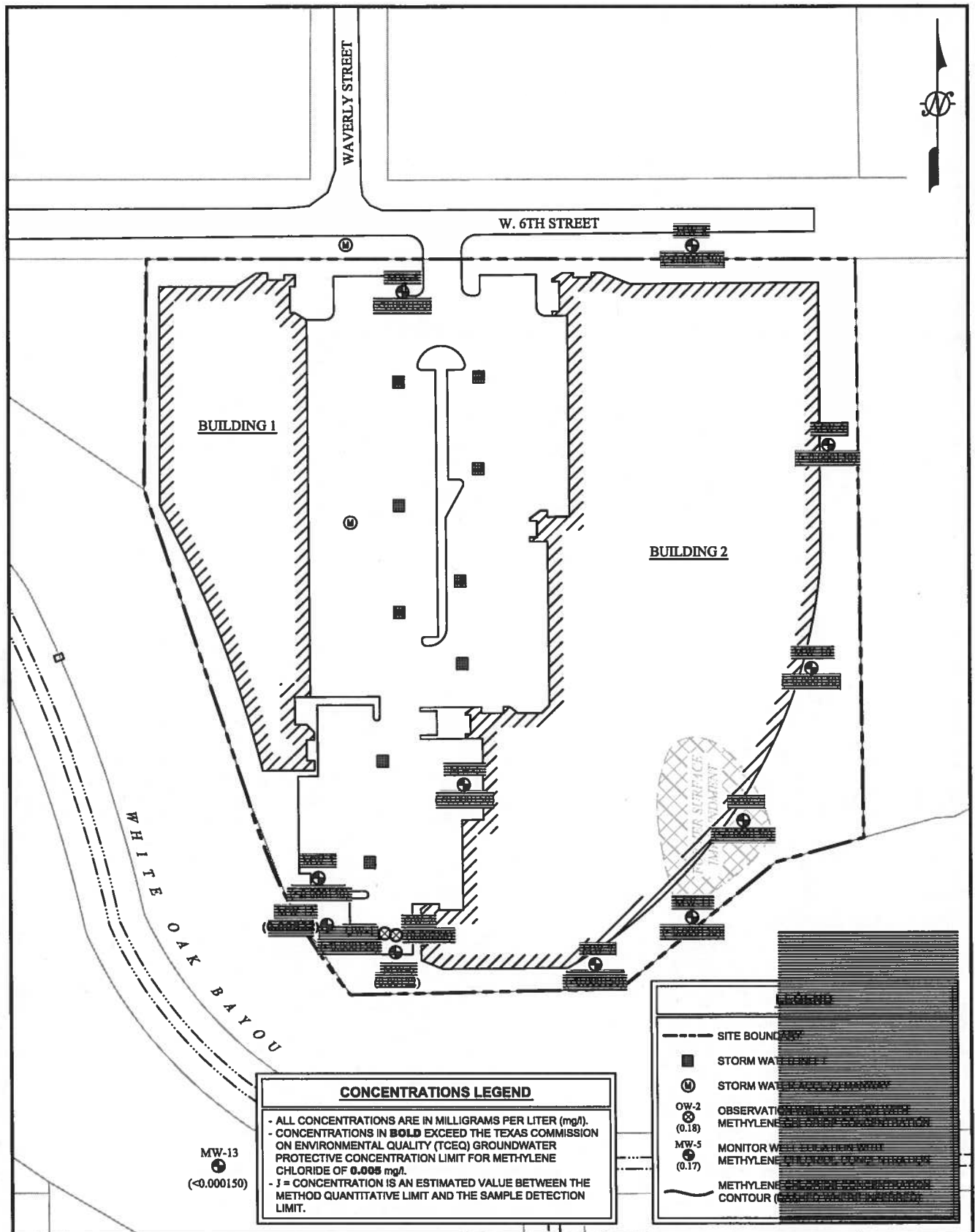

APPROXIMATE SCALE 1" = 120'

Terracon
Consulting Engineers & Scientists

TERRACON NO: 92137736

DRAWN BY:	AD
CHECKED BY:	AN
SCALE:	AS SHOWN
DATE:	12-2-2013

Figure 1F-4
Groundwater COC Conc. Map - Methylene Chloride
(March, 2013)
Central Industrial Park
600-720 W. 6th Street
Houston, Texas

N:\ENV\dox\2013\Drafting\92137736\92137736 Figure 1F-5.dwg : Figure 1F-5

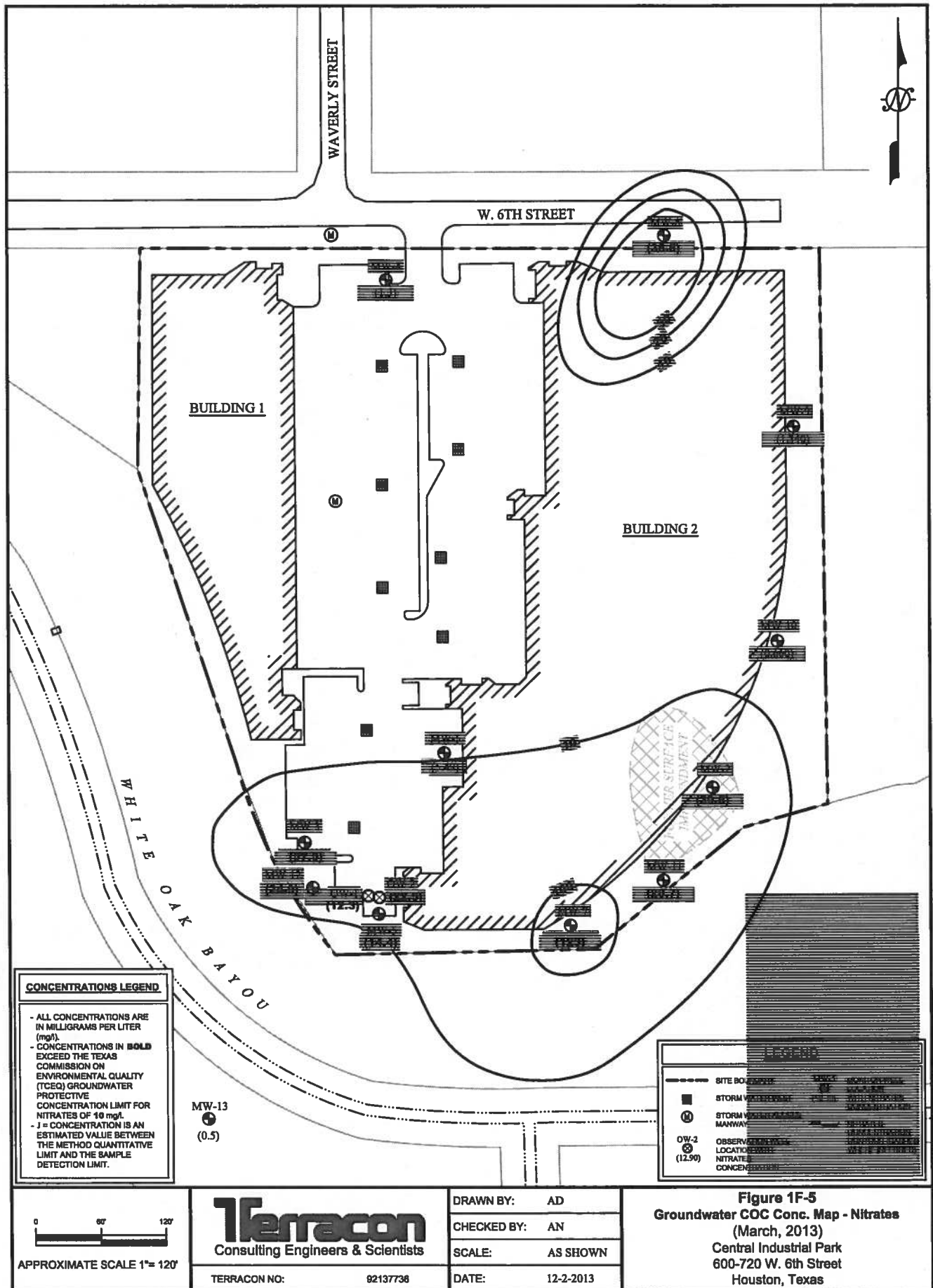

CONCENTRATIONS LEGEND

- ALL CONCENTRATIONS ARE IN MILLIGRAMS PER LITER (mg/L).
- CONCENTRATIONS IN **BOLD** EXCEED THE TEXAS COMMISSION ON ENVIRONMENTAL QUALITY (TCEQ) GROUNDWATER PROTECTIVE CONCENTRATION LIMIT FOR NITRATES OF 10 mg/L.
- J = CONCENTRATION IS AN ESTIMATED VALUE BETWEEN THE METHOD QUANTITATIVE LIMIT AND THE SAMPLE DETECTION LIMIT.

LEGEND

- SITE BOUNDARY
- STORM WATER MANWAY
- MW-1 (12.5)
- MW-2 (12.50)
- OBSERVATION WELL LOCATION
- NITRATE CONCENTRATION

0 60' 120'

APPROXIMATE SCALE 1" = 120'

Terracon
Consulting Engineers & Scientists

DRAWN BY: AD
 CHECKED BY: AN
 SCALE: AS SHOWN
 DATE: 12-2-2013

Figure 1F-5
Groundwater COC Conc. Map - Nitrates
 (March, 2013)
 Central Industrial Park
 600-720 W. 6th Street
 Houston, Texas