

4277-48	Sanitary Sewer Cleaning and Television Inspection In Support of Rehabilitation				
WBS No. R-000266-0165-4	Specialized Maintenance Services, Inc.				
WORK ORDER	KEY MAP	SUBDIVISION	BASIN	Old Council Dist.	New Council Dist.
9	451C	CANDLELIGHT OAKS SEC 2	NW137	B	A
10	452G	PINE FOREST	II067	A	B,C
1	532L,532Q,533J,533M	COLUMBIA ESTATES	AS025,AS026 & AS028	C	D,K
18	528J,N	CATALINA SQUARE	BW234	F	F
8	529L,K	WESTHAMPTON VILLAGE T/H	MN271	F	F,J
12	489M	BRIARGROVE PARK	UBP08,WOU01	G	G
13	489L,Q	GREENTREE PLACE	WD029	G	G
14	489Q	WALNUT BEND	WD031	G	G
15	494T,S,P,N	BRADY PLACE	II184	H	H
16	493E	JOHN BRASHEAR	II21	H	H
3	494R	MAGNOLIA PARK SEC 2	IB013	I	H,I
4	495W	SCHMOELLER SEC 1	IB008	I	I
5	494V,494Z	CENTRAL PARK	IBU02	I	I
6	535K,L	PARK TERRACE	SBP02	I	I
7	496C	WOOD BAYOU	NEU01	I	I
11	535J	COMMERCE CENTRAL	SBP02	I	I
19	531C	BELLAIRE HEIGHTS	SW234	J	J
2	611D	RIDGMONT SEC 2, 6 AND 7	GR015	D	K
17	532P	KNOLLWOOD VILLAGE	SW217	C	K

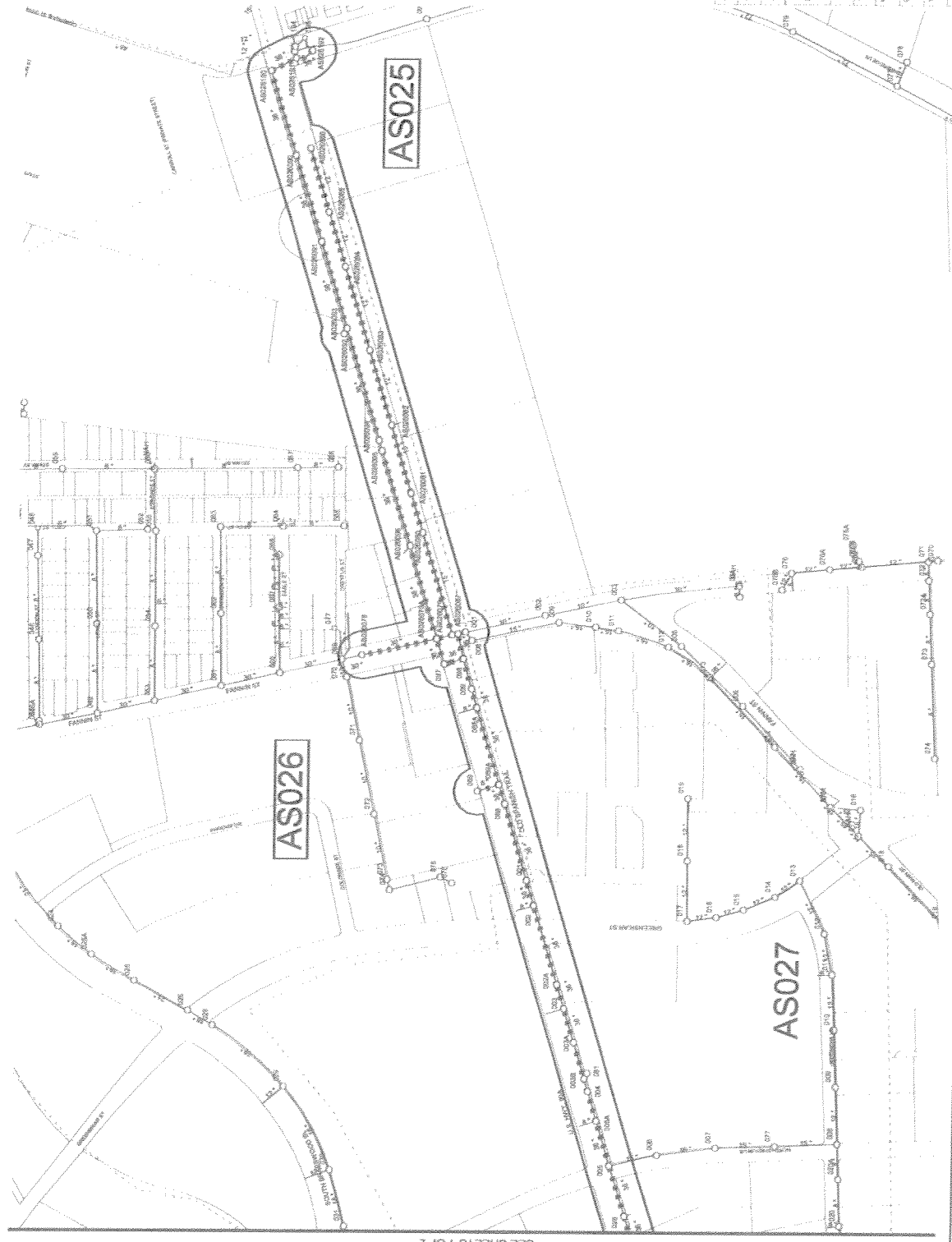

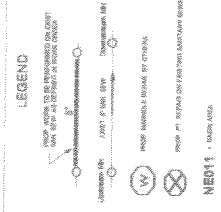

SEE SHEETS 1 OF 2



NO.	REVISION	DESCRIPTION	DATE

**GENERAL NOTES:**

1. EXISTING LOCATION, ALIGNMENT, STATION, SIZE AND/OR DEPTH OF EXISTING SEWER SHALL BE AS SHOWN ON THIS PLAN.
2. AFTER REVIEW OF TABLES, CONTRACTOR SHALL BE RESPONSIBLE TO VERIFY LOCATION OF SEWER LINES TO BE REINSTALLED.
3. COLOR VIDEO OR PHOTOGRAPHS SHALL BE TAKEN OF THE ENTIRE WORK AREA, INCLUDING LOCATION PRIOR TO MOVING EQUIPMENT AND MATERIAL.



**Sanitary Sewer Cleaning and Television Inspection in Support of Rehabilitation**

**QUALITY CONTROL LAB:**  
 Contract Manager: [Name]  
 P.O. Box 8768, Houston, Texas 77267-7623  
 PHONE NO: (713) 474-1111  
 FAX NO: (713) 474-2577

**CONTRACTOR:**  
 Specialized Maintenance Services, Inc.  
 10000 Katy Road, Houston, Texas 77055  
 PHONE NO: (281) 476-1010  
 FAX NO: (281) 476-4887

**QUADRANT:** [Blank]  
**KEY MAP:** [Blank]  
**SUBDIVISION:** [Blank]  
**COUNCIL DISTRICT:** [Blank]  
**C.M.A.P.:** [Blank]

WORK ORDER NO. 01  
 WY FILE NO. 4377-48  
 WBS NO. R4028B-01EE-4  
 CITY CONTRACT NO. 4600010614

**CITY OF HOUSTON**  
 DEPARTMENT OF PUBLIC WORKS AND ENGINEERING  
 4546 BROOKSBY ST. HOUSTON, TX 77037

APPROVALS:  
 WATER DIVISION  
 PUBLIC UTILITIES DIVISION  
 CONSTRUCTION DIVISION  
 SANITARY SEWER DIVISION  
 COLLECTION SYSTEMS DIVISION  
 PLANNING DIVISION  
 PUBLIC WORKS DIVISION  
 PUBLIC UTILITIES DIVISION  
 CONSTRUCTION DIVISION

WORKING UNDER THE AUTHORITY OF THE CITY ENGINEER  
 DESIGNED BY: [Name]  
 DRAWN BY: [Name]  
 CHECKED BY: [Name]  
 DATE: [Date]  
 SHEET NO. 2 OF 2 SHEETS  
 P.S. NO. [Blank] GIB NO. [Blank]

# CITY OF HOUSTON

DEPARTMENT OF PUBLIC WORKS AND ENGINEERING  
WASTEWATER OPERATIONS BRANCH

Sanitary Sewer Cleaning and Television Inspection in Support of Rehabilitation

RIDGEMONT SEC 2, 6 AND 7

COUNCIL DISTRICT: D

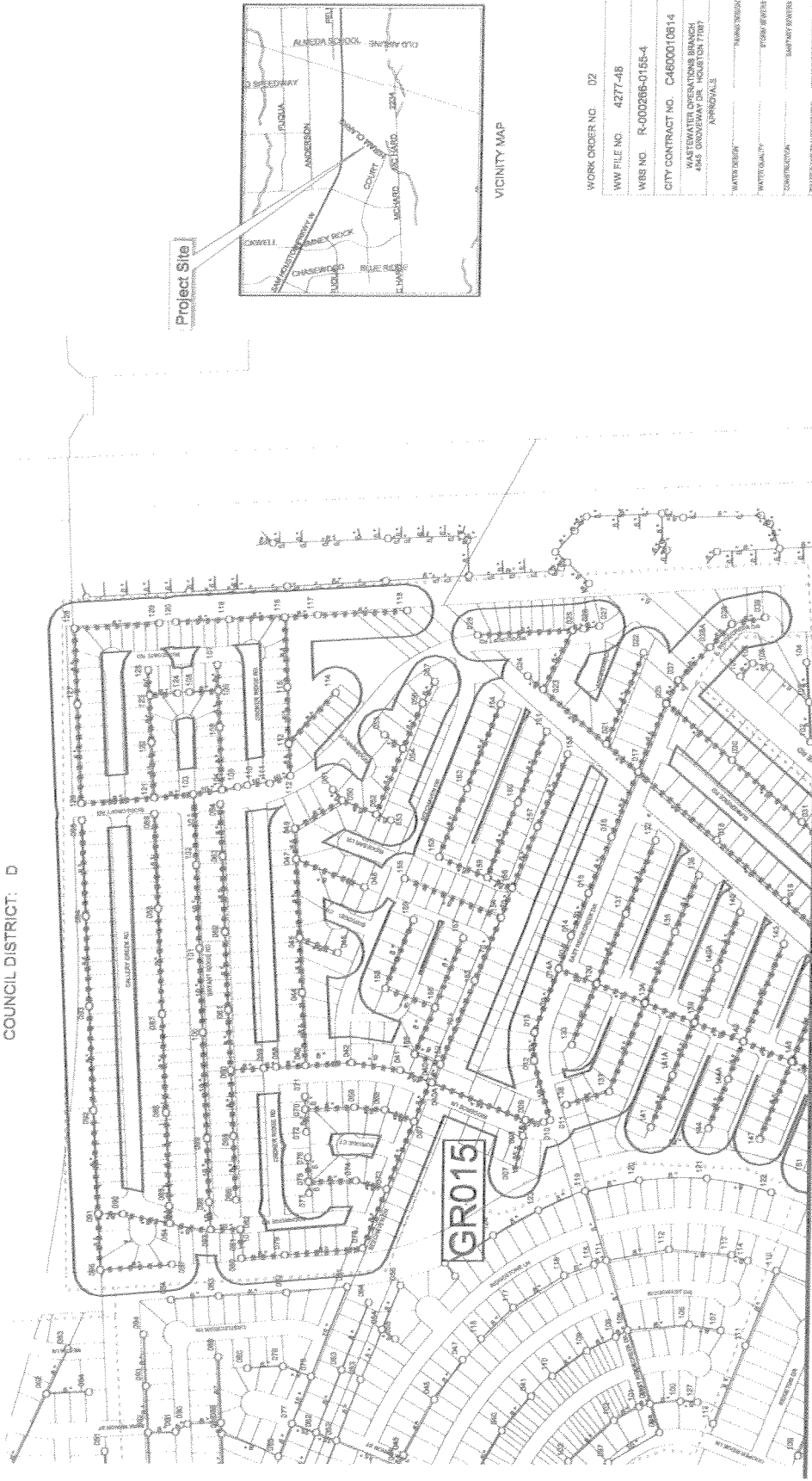

Project Site

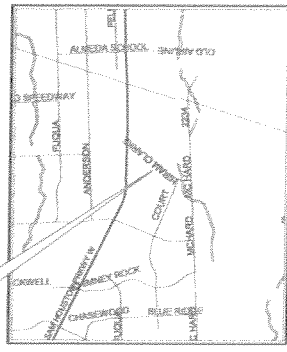

VICINITY MAP

WORK ORDER NO.	D2
WW FILE NO.	4277-48
WBS NO.	R-000288-0155-4
CITY CONTRACT NO.	C4800010614
WASTEWATER OPERATIONS BRANCH 4145 GROVENEWAY DR. HOUSTON 77077	
APPROVALS:	
DESIGNED BY:	JOHN A. SMITH
CHECKED BY:	JOHN A. SMITH
DATE:	11-20-07
SCALE:	AS SHOWN
SHEET NO. OF 2 SHEETS	02 OF 02
DIST. NO.	00627

CONTRACTOR:  
Specialized Maintenance Services, Inc.  
4532 Frenzies Blvd., Houston, Texas 77052  
PHONE NO. (281) 472-2321  
FAX NO. (281) 472-2807

QUALITY CONTROL LAB:  
Central Testing Laboratories  
10000 Katy Road, Houston, Texas 77055  
PHONE NO. (281) 472-2321  
FAX NO. (281) 472-2807



GENERAL NOTES:

1. EXACT LOCATION, ALIGNMENT, ELEVATION, SIZE AND/OR DEPTH OF ALL MANHOLES SHALL BE AS SHOWN ON THIS PLAN.
2. ALL MANHOLES SHALL BE CONSTRUCTED TO THE PROPER DEPTH AND TO THE PROPER LOCATION.
3. COLOR VIDEO OR PHOTOGRAPHY SHALL BE TAKEN OF THE INTERIOR OF ALL MANHOLES PRIOR TO ANY WORKING EQUIPMENT AND MATERIAL.

SEE SHEETS 2 OF 2

NO.	REVISION	DESCRIPTION	DATE

NO.	REVISION	DESCRIPTION	DATE

NE011 - RAIN WATER





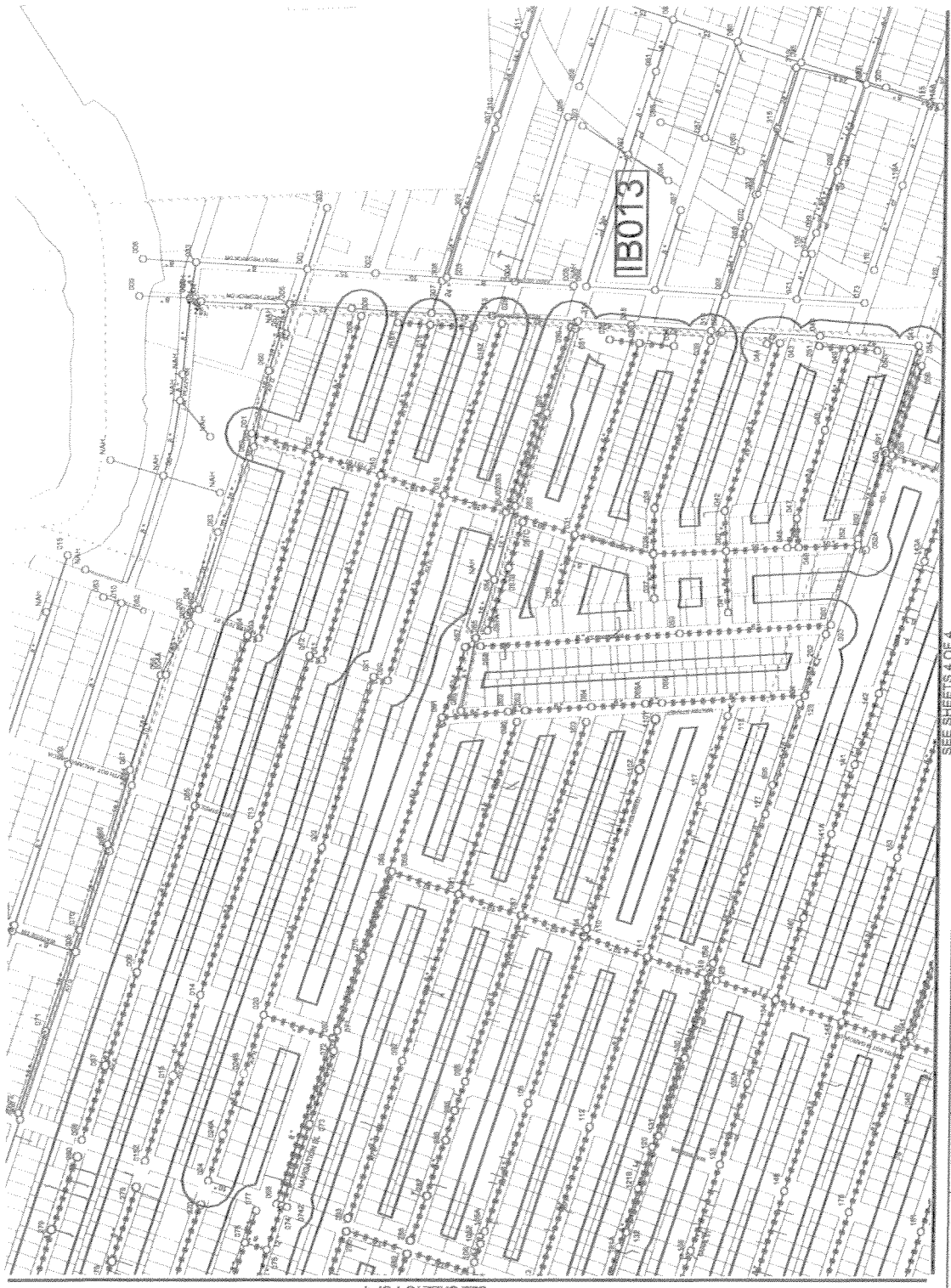

SEE SHEETS 1 OF 4

SEE SHEETS 4 OF 4

**LEGEND**

PROPOSED TO BE REPAIRED OR REPLACED  
 EXISTING TO BE REPAIRED OR REPLACED  
 EXISTING TO BE REMOVED  
 EXISTING TO BE MAINTAINED

PROPOSED TO BE MAINTAINED  
 PROPOSED TO BE REMOVED OR DESTROYED  
 PROPOSED TO BE MAINTAINED

PROPOSED TO BE MAINTAINED  
 PROPOSED TO BE REMOVED OR DESTROYED  
 PROPOSED TO BE MAINTAINED

NER11 - BARRA AREA

NO.	REVISION DESCRIPTION	DATE

**GENERAL NOTES:**

1. ALL WORK SHALL BE IN ACCORDANCE WITH THE LATEST EDITIONS OF THE STANDARD SPECIFICATIONS FOR PUBLIC WORKS OF THE STATE OF TEXAS.
2. AFTER REVIEW OF THESE CONTRACT DOCUMENTS, CONTRACTORS SHALL BE NOTIFIED TO WHICH MANHOLE SECTIONS TO BE REPAIRED/REPLACED.
3. COLOR VIDEO OR PHOTOGRAPHS SHALL BE TAKEN OF THE ENTIRE WORK AREA PRIOR TO ANY WORK BEING PERFORMED TO MAINTAIN EQUIPMENT AND MATERIAL.



**Sanitary Sewer Cleaning and Television Inspection in Support of Rehabilitation**

CONTRACTOR  
 Quality Control Lab  
 4532 Pasadena Blvd, Houston, Texas 77005  
 PHONE NO. (281) 426-1010  
 FAX NO. (281) 476-0877

QUADRANT: SE  
 CITY MAP: LEBEL, L8072  
 SUBDIVISION: PROTONA PARK & MARONOLA PARK SEC 2  
 COUNCIL DISTRICT: C MAP: C0538

UNAPPROVED ENGINEER'S SEAL AND SIGNATURE BLOCK

APPROVED BY: JAMES A. WALKER  
 DATE: 11/15/11  
 SCALE: 1" = 40'

WORK ORDER NO. 3  
 W/O FILE NO. 4277-48  
 WBS NO. R000286-0165-4  
 CITY CONTRACT NO. 4600010814  
**CITY OF HOUSTON**  
 DEPARTMENT OF PUBLIC WORKS AND ENGINEERING  
 4845 GARDENWAY ST., HOUSTON, TX 77007

APPROVALS

DATE: 11/15/11  
 DRAWN BY: JAMES A. WALKER  
 CHECKED BY: JAMES A. WALKER  
 APPROVED BY: JAMES A. WALKER  
 DATE: 11/15/11  
 SCALE: 1" = 40'



SEE SHEETS 3 OF 4

SEE SHEETS 3 OF 4



WORK ORDER NO. 03  
 WW FILE NO. 42748  
 WBS NO. R-00286-0156-4  
 CITY CONTRACT NO. 400010014  
**CITY OF HOUSTON**  
 DEPARTMENT OF PUBLIC WORKS AND ENGINEERING  
 WASTEWATER OPERATIONS BRANCH  
 SANITARY SEWER COLLECTION SYSTEMS SECTION  
 APPROVALS  
 DESIGNER: [Signature]  
 CHECKED: [Signature]  
 IN CHARGE: [Signature]  
 DATE: 01/14/11  
 DRAWN BY: [Signature]  
 SHEET NO. 4 OF 4 SHEETS  
 GIS NO.

CLASSIFICATION: [Blank]  
 KEY MAP: [Blank]  
 SUBDIVISION: [Blank]  
 COUNCIL DISTRICT: [Blank]  
 C MAP: [Blank]

**Sanitary Sewer Cleaning and Television Inspection in Support of Rehabilitation**  
 CONTRACTOR:  
 Quality Control, Inc.  
 4533 West Loop West, Suite 100  
 P.O. Box 8783, Houston, Texas 77268-7833  
 PHONE NO. (281) 475-0221  
 FAX NO. (281) 475-2277



**GENERAL NOTES:**  
 1. EXACT LOCATION, ALIGNMENT, ELEVATION, SIZE AND/OR DEPTH OF EXISTING SAN. SEW. LINES AND/OR MANHOLES SHALL BE AS PER FIELD SURVEY DATA.  
 2. ALL WORK SHALL BE IN ACCORDANCE WITH THE CITY OF HOUSTON STANDARD SPECIFICATIONS FOR SANITARY SEWER COLLECTION SYSTEMS.  
 3. COLOR VIDEO OR PHOTOGRAPHS SHALL BE SUBMITTED TO THE ENGINEER AT THE PROJECT LOCATION PRIOR TO MOVING EQUIPMENT AND MATERIAL.

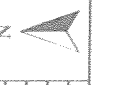

**LEGEND**

EXISTING SAN. SEW. LINE (AS SHOWN IN SURVEY DATA)  
 EXISTING MANHOLE (AS SHOWN IN SURVEY DATA)  
 EXISTING 18" DIA. SAN. SEW. LINE (AS SHOWN IN SURVEY DATA)  
 EXISTING 24" DIA. SAN. SEW. LINE (AS SHOWN IN SURVEY DATA)  
 EXISTING 30" DIA. SAN. SEW. LINE (AS SHOWN IN SURVEY DATA)  
 EXISTING 36" DIA. SAN. SEW. LINE (AS SHOWN IN SURVEY DATA)  
 EXISTING 42" DIA. SAN. SEW. LINE (AS SHOWN IN SURVEY DATA)  
 EXISTING 48" DIA. SAN. SEW. LINE (AS SHOWN IN SURVEY DATA)  
 EXISTING 54" DIA. SAN. SEW. LINE (AS SHOWN IN SURVEY DATA)  
 EXISTING 60" DIA. SAN. SEW. LINE (AS SHOWN IN SURVEY DATA)  
 EXISTING 66" DIA. SAN. SEW. LINE (AS SHOWN IN SURVEY DATA)  
 EXISTING 72" DIA. SAN. SEW. LINE (AS SHOWN IN SURVEY DATA)  
 EXISTING 78" DIA. SAN. SEW. LINE (AS SHOWN IN SURVEY DATA)  
 EXISTING 84" DIA. SAN. SEW. LINE (AS SHOWN IN SURVEY DATA)  
 EXISTING 90" DIA. SAN. SEW. LINE (AS SHOWN IN SURVEY DATA)  
 EXISTING 96" DIA. SAN. SEW. LINE (AS SHOWN IN SURVEY DATA)  
 EXISTING 102" DIA. SAN. SEW. LINE (AS SHOWN IN SURVEY DATA)  
 EXISTING 108" DIA. SAN. SEW. LINE (AS SHOWN IN SURVEY DATA)  
 EXISTING 114" DIA. SAN. SEW. LINE (AS SHOWN IN SURVEY DATA)  
 EXISTING 120" DIA. SAN. SEW. LINE (AS SHOWN IN SURVEY DATA)

NO.	REVISION DESCRIPTION	DATE



# CITY OF HOUSTON

DEPARTMENT OF PUBLIC WORKS AND ENGINEERING  
 WASTEWATER OPERATIONS BRANCH  
 Sanitary Sewer Cleaning and Television Inspection in Support of Rehabilitation  
 CENTRAL PARK  
 COUNCIL DISTRICT: 1

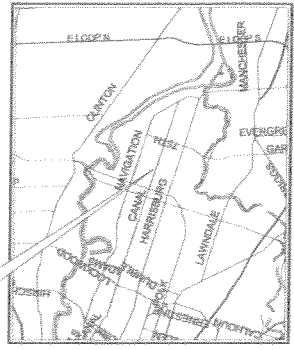

WORK ORDER NO. 05  
 WW FILE NO. 4277-48  
 WBS NO. R-000286-0195-4  
 CITY CONTRACT NO. C4600010614  
 WASTEWATER OPERATIONS BRANCH  
 4545 BROOKWAY DR HOUSTON 77067  
 APPROVALS  
 CONTRACTOR: [Signature]  
 WATER QUALITY: [Signature]  
 CONSTRUCTION: [Signature]  
 UTILITY AND TRANSPORTATION: [Signature]  
 PUBLIC WORKS AND OPERATIONS DIVISION

QUADRANT: SE  
 KEY MAP: 494V, 484Z  
 SEWER MAP: L5596  
 C MAP: C0531

CONTRACTOR:  
 Specialized Maintenance Services, Inc.  
 4533 Pasadena Blvd, Houston, Texas 77062  
 PHONE NO. (713) 474-1531  
 FAX NO. (281) 415-4027

QUALITY CONTROL LAB:  
 Crestal Testing Laboratories  
 11111 Katy Road, Houston, Texas 77058  
 PHONE NO. (713) 474-1531  
 FAX NO. (713) 474-2277



GENERAL NOTES:  
 1. EXACT LOCATION, ALIGNMENT, STATION, SIZE AND/OR DEPTH OF EXISTING MANHOLE, SEWER LINE, AND/OR MANHOLE SHALL BE AS PER FIELD SURVEY AND PHOTOGRAPHS TO WHICH MANHOLE SECTION TO WHICH MANHOLE SHALL BE NOTIFIED.  
 2. COLOR VIDEO OR PHOTOGRAPHS SHALL BE TAKEN OF THE INTERIOR WORK AREA LOCATION PRIOR TO BEGINNING WORK AND MATERIAL.

LEGEND

PROJ. AREA TO BE REPAIRED OR EXIST. MANHOLE TO BE CLEANED BY ORDER

PROJ. MANHOLE TO BE CLEANED BY ORDER

PROJ. MANHOLE TO BE REPAIRED BY ORDER

PROJ. MANHOLE TO BE REPLACED BY ORDER

NEC11 - IMPACTS

NO.	REVISION DESCRIPTION	DATE

# CITY OF HOUSTON

DEPARTMENT OF PUBLIC WORKS AND ENGINEERING  
 WASTEWATER OPERATIONS BRANCH  
 Sanitary Sewer Cleaning and Television Inspection in Support of Rehabilitation  
 PARK TERRACE  
 COUNCIL DISTRICT: 1

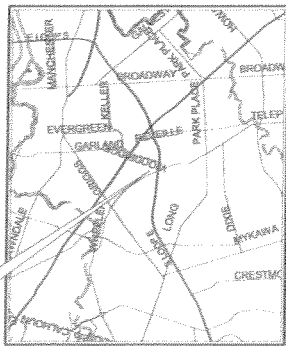
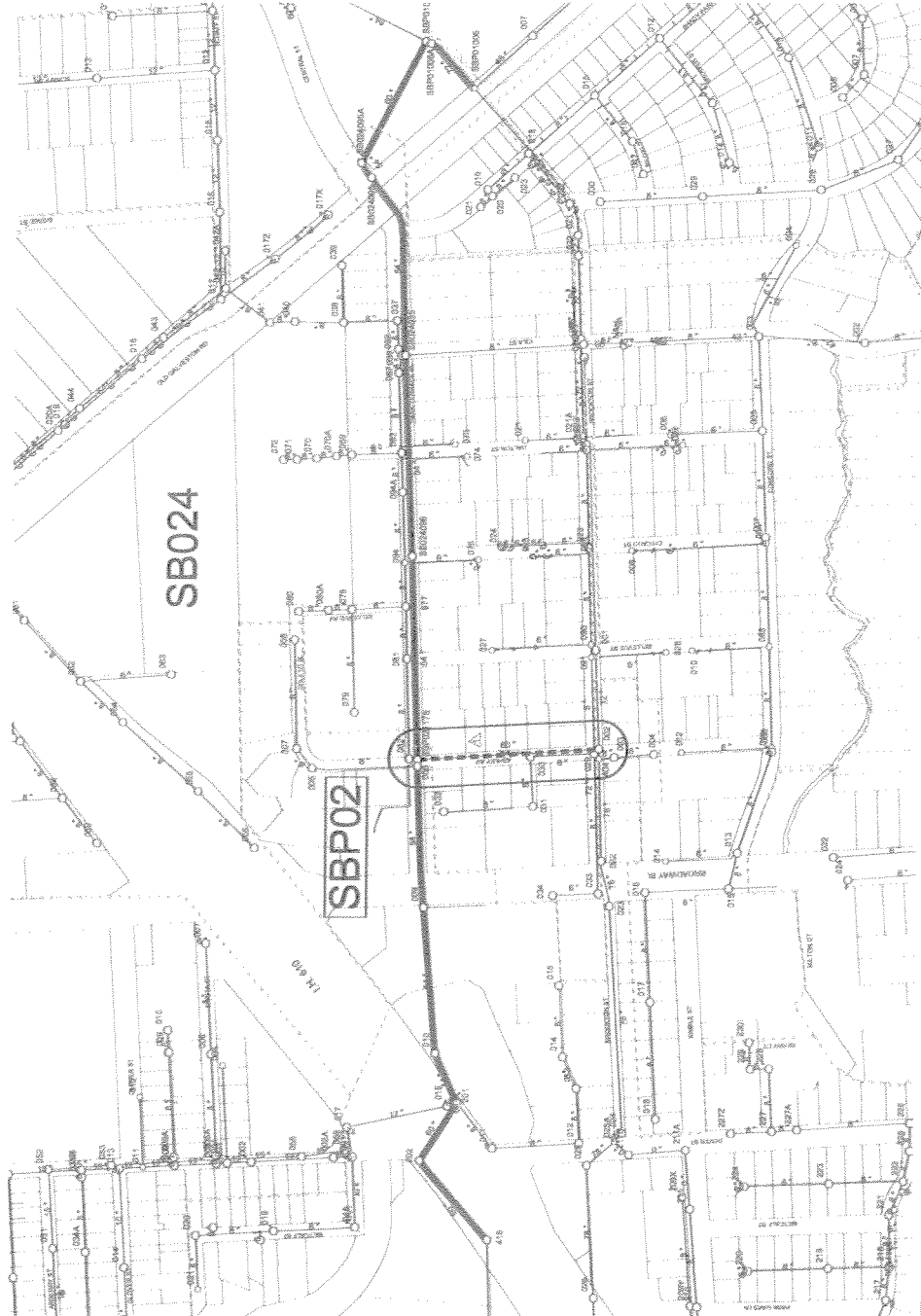

**LEGEND**

MANHOLE: 1. AS SHOWN ON PLANS OR FIELD SURVEY. 2. AS SHOWN ON PLANS OR FIELD SURVEY. 3. AS SHOWN ON PLANS OR FIELD SURVEY.

SEWER LINE: 1. AS SHOWN ON PLANS OR FIELD SURVEY. 2. AS SHOWN ON PLANS OR FIELD SURVEY. 3. AS SHOWN ON PLANS OR FIELD SURVEY.

PROJECT AREA: 1. AS SHOWN ON PLANS OR FIELD SURVEY. 2. AS SHOWN ON PLANS OR FIELD SURVEY. 3. AS SHOWN ON PLANS OR FIELD SURVEY.

MANHOLE: 1. AS SHOWN ON PLANS OR FIELD SURVEY. 2. AS SHOWN ON PLANS OR FIELD SURVEY. 3. AS SHOWN ON PLANS OR FIELD SURVEY.

SEWER LINE: 1. AS SHOWN ON PLANS OR FIELD SURVEY. 2. AS SHOWN ON PLANS OR FIELD SURVEY. 3. AS SHOWN ON PLANS OR FIELD SURVEY.

PROJECT AREA: 1. AS SHOWN ON PLANS OR FIELD SURVEY. 2. AS SHOWN ON PLANS OR FIELD SURVEY. 3. AS SHOWN ON PLANS OR FIELD SURVEY.

NE011 - RAIN WATER

NO.	REVISION	DATE
1	ADDENDUM # 1	04/12/11

**GENERAL NOTES:**

1. EXACT LOCATION, ALIGNMENT, STATION, SIZE AND/OR DEPTH OF EXISTING AND NEW LINES AND/OR MANHOLES SHALL BE AS PER FIELD SURVEY. ALL MANHOLES SHALL BE METRIC.
2. ALL MANHOLE DEPTHS TO BE METRIC.
3. COLOR CODES OR PHOTOGRAPHS SHALL BE TAKEN OF THE EXISTING WORK AREAS PRIOR TO REMOVAL OF EQUIPMENT AND MATERIAL.

**QUALITY CONTROL LAB**  
 Coastal Testing Laboratories  
 4333 Pasadena Blvd., Houston, Texas 77033  
 PHONE NO.: (713) 471-2127  
 FAX NO.: (713) 471-2217

**CONTRACTOR:**  
 Spectraland Maintenance Services, Inc.  
 4333 Pasadena Blvd., Houston, Texas 77033  
 PHONE NO.: (281) 471-4287  
 FAX NO.: (281) 471-4287

QUADRANT: SE  
 KEY MAP: 539K.L  
 SEWER MAP: L6556  
 C MAP: C0933

WORK ORDER NO. 6 Addendum # 1  
 WW FILE NO. 4277-48  
 WBS NO. R-000286-0155-4  
 CITY CONTRACT NO. C4600010614  
 WASTEWATER OPERATIONS BRANCH  
 4545 BROOKWAY DR. HOUSTON 77057  
 APPROVALS:  
 WATER MGR. \_\_\_\_\_  
 WATER QUALITY \_\_\_\_\_  
 TRANSPORTATION \_\_\_\_\_  
 PUBLIC WORKS \_\_\_\_\_  
 COLLECTOR DISTRICT SUPERVISOR: HOUSTON 77057  
 C4600010614











# CITY OF HOUSTON

DEPARTMENT OF PUBLIC WORKS AND ENGINEERING  
 WASTEWATER OPERATIONS BRANCH  
 Sanitary Sewer Cleaning and Television Inspection in Support of Rehabilitation  
 Subdivision: BRIARGROVE PARK  
 Council District: G

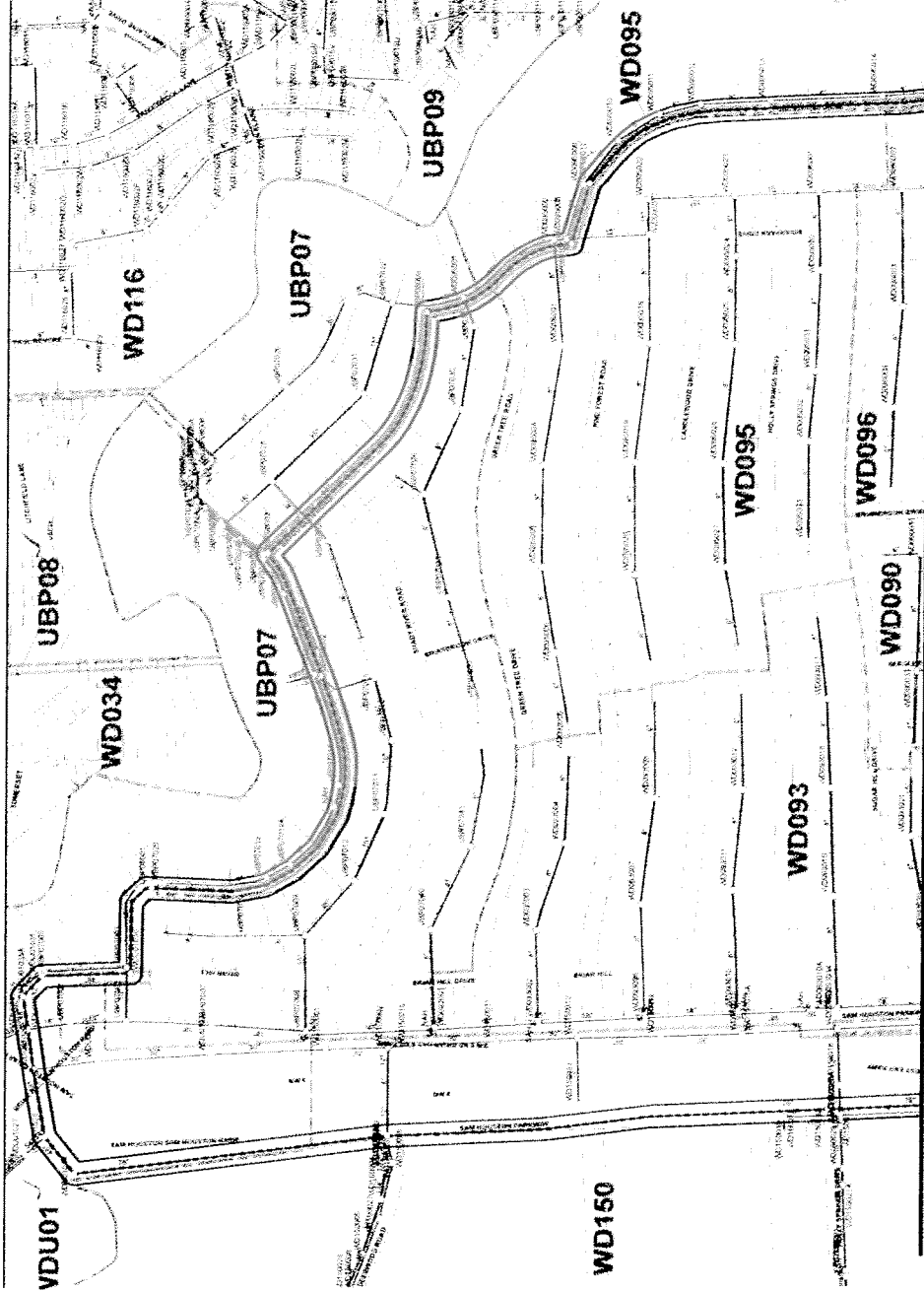

Project Site

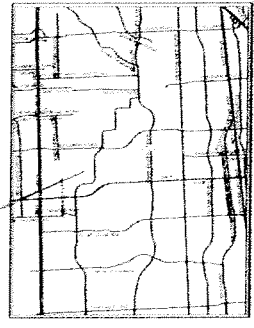

VICINITY MAP

LEGEND	
[Symbol]	12" DIA. ST. PIPE
[Symbol]	18" DIA. ST. PIPE
[Symbol]	24" DIA. ST. PIPE
[Symbol]	30" DIA. ST. PIPE
[Symbol]	36" DIA. ST. PIPE
[Symbol]	42" DIA. ST. PIPE
[Symbol]	48" DIA. ST. PIPE
[Symbol]	54" DIA. ST. PIPE
[Symbol]	60" DIA. ST. PIPE
[Symbol]	66" DIA. ST. PIPE
[Symbol]	72" DIA. ST. PIPE
[Symbol]	78" DIA. ST. PIPE
[Symbol]	84" DIA. ST. PIPE
[Symbol]	90" DIA. ST. PIPE
[Symbol]	96" DIA. ST. PIPE
[Symbol]	102" DIA. ST. PIPE
[Symbol]	108" DIA. ST. PIPE
[Symbol]	114" DIA. ST. PIPE
[Symbol]	120" DIA. ST. PIPE
[Symbol]	126" DIA. ST. PIPE
[Symbol]	132" DIA. ST. PIPE
[Symbol]	138" DIA. ST. PIPE
[Symbol]	144" DIA. ST. PIPE
[Symbol]	150" DIA. ST. PIPE
[Symbol]	156" DIA. ST. PIPE
[Symbol]	162" DIA. ST. PIPE
[Symbol]	168" DIA. ST. PIPE
[Symbol]	174" DIA. ST. PIPE
[Symbol]	180" DIA. ST. PIPE
[Symbol]	186" DIA. ST. PIPE
[Symbol]	192" DIA. ST. PIPE
[Symbol]	198" DIA. ST. PIPE
[Symbol]	204" DIA. ST. PIPE
[Symbol]	210" DIA. ST. PIPE
[Symbol]	216" DIA. ST. PIPE
[Symbol]	222" DIA. ST. PIPE
[Symbol]	228" DIA. ST. PIPE
[Symbol]	234" DIA. ST. PIPE
[Symbol]	240" DIA. ST. PIPE
[Symbol]	246" DIA. ST. PIPE
[Symbol]	252" DIA. ST. PIPE
[Symbol]	258" DIA. ST. PIPE
[Symbol]	264" DIA. ST. PIPE
[Symbol]	270" DIA. ST. PIPE
[Symbol]	276" DIA. ST. PIPE
[Symbol]	282" DIA. ST. PIPE
[Symbol]	288" DIA. ST. PIPE
[Symbol]	294" DIA. ST. PIPE
[Symbol]	300" DIA. ST. PIPE
[Symbol]	306" DIA. ST. PIPE
[Symbol]	312" DIA. ST. PIPE
[Symbol]	318" DIA. ST. PIPE
[Symbol]	324" DIA. ST. PIPE
[Symbol]	330" DIA. ST. PIPE
[Symbol]	336" DIA. ST. PIPE
[Symbol]	342" DIA. ST. PIPE
[Symbol]	348" DIA. ST. PIPE
[Symbol]	354" DIA. ST. PIPE
[Symbol]	360" DIA. ST. PIPE
[Symbol]	366" DIA. ST. PIPE
[Symbol]	372" DIA. ST. PIPE
[Symbol]	378" DIA. ST. PIPE
[Symbol]	384" DIA. ST. PIPE
[Symbol]	390" DIA. ST. PIPE
[Symbol]	396" DIA. ST. PIPE
[Symbol]	402" DIA. ST. PIPE
[Symbol]	408" DIA. ST. PIPE
[Symbol]	414" DIA. ST. PIPE
[Symbol]	420" DIA. ST. PIPE
[Symbol]	426" DIA. ST. PIPE
[Symbol]	432" DIA. ST. PIPE
[Symbol]	438" DIA. ST. PIPE
[Symbol]	444" DIA. ST. PIPE
[Symbol]	450" DIA. ST. PIPE
[Symbol]	456" DIA. ST. PIPE
[Symbol]	462" DIA. ST. PIPE
[Symbol]	468" DIA. ST. PIPE
[Symbol]	474" DIA. ST. PIPE
[Symbol]	480" DIA. ST. PIPE
[Symbol]	486" DIA. ST. PIPE
[Symbol]	492" DIA. ST. PIPE
[Symbol]	498" DIA. ST. PIPE
[Symbol]	504" DIA. ST. PIPE
[Symbol]	510" DIA. ST. PIPE
[Symbol]	516" DIA. ST. PIPE
[Symbol]	522" DIA. ST. PIPE
[Symbol]	528" DIA. ST. PIPE
[Symbol]	534" DIA. ST. PIPE
[Symbol]	540" DIA. ST. PIPE
[Symbol]	546" DIA. ST. PIPE
[Symbol]	552" DIA. ST. PIPE
[Symbol]	558" DIA. ST. PIPE
[Symbol]	564" DIA. ST. PIPE
[Symbol]	570" DIA. ST. PIPE
[Symbol]	576" DIA. ST. PIPE
[Symbol]	582" DIA. ST. PIPE
[Symbol]	588" DIA. ST. PIPE
[Symbol]	594" DIA. ST. PIPE
[Symbol]	600" DIA. ST. PIPE
[Symbol]	606" DIA. ST. PIPE
[Symbol]	612" DIA. ST. PIPE
[Symbol]	618" DIA. ST. PIPE
[Symbol]	624" DIA. ST. PIPE
[Symbol]	630" DIA. ST. PIPE
[Symbol]	636" DIA. ST. PIPE
[Symbol]	642" DIA. ST. PIPE
[Symbol]	648" DIA. ST. PIPE
[Symbol]	654" DIA. ST. PIPE
[Symbol]	660" DIA. ST. PIPE
[Symbol]	666" DIA. ST. PIPE
[Symbol]	672" DIA. ST. PIPE
[Symbol]	678" DIA. ST. PIPE
[Symbol]	684" DIA. ST. PIPE
[Symbol]	690" DIA. ST. PIPE
[Symbol]	696" DIA. ST. PIPE
[Symbol]	702" DIA. ST. PIPE
[Symbol]	708" DIA. ST. PIPE
[Symbol]	714" DIA. ST. PIPE
[Symbol]	720" DIA. ST. PIPE
[Symbol]	726" DIA. ST. PIPE
[Symbol]	732" DIA. ST. PIPE
[Symbol]	738" DIA. ST. PIPE
[Symbol]	744" DIA. ST. PIPE
[Symbol]	750" DIA. ST. PIPE
[Symbol]	756" DIA. ST. PIPE
[Symbol]	762" DIA. ST. PIPE
[Symbol]	768" DIA. ST. PIPE
[Symbol]	774" DIA. ST. PIPE
[Symbol]	780" DIA. ST. PIPE
[Symbol]	786" DIA. ST. PIPE
[Symbol]	792" DIA. ST. PIPE
[Symbol]	798" DIA. ST. PIPE
[Symbol]	804" DIA. ST. PIPE
[Symbol]	810" DIA. ST. PIPE
[Symbol]	816" DIA. ST. PIPE
[Symbol]	822" DIA. ST. PIPE
[Symbol]	828" DIA. ST. PIPE
[Symbol]	834" DIA. ST. PIPE
[Symbol]	840" DIA. ST. PIPE
[Symbol]	846" DIA. ST. PIPE
[Symbol]	852" DIA. ST. PIPE
[Symbol]	858" DIA. ST. PIPE
[Symbol]	864" DIA. ST. PIPE
[Symbol]	870" DIA. ST. PIPE
[Symbol]	876" DIA. ST. PIPE
[Symbol]	882" DIA. ST. PIPE
[Symbol]	888" DIA. ST. PIPE
[Symbol]	894" DIA. ST. PIPE
[Symbol]	900" DIA. ST. PIPE
[Symbol]	906" DIA. ST. PIPE
[Symbol]	912" DIA. ST. PIPE
[Symbol]	918" DIA. ST. PIPE
[Symbol]	924" DIA. ST. PIPE
[Symbol]	930" DIA. ST. PIPE
[Symbol]	936" DIA. ST. PIPE
[Symbol]	942" DIA. ST. PIPE
[Symbol]	948" DIA. ST. PIPE
[Symbol]	954" DIA. ST. PIPE
[Symbol]	960" DIA. ST. PIPE
[Symbol]	966" DIA. ST. PIPE
[Symbol]	972" DIA. ST. PIPE
[Symbol]	978" DIA. ST. PIPE
[Symbol]	984" DIA. ST. PIPE
[Symbol]	990" DIA. ST. PIPE
[Symbol]	996" DIA. ST. PIPE
[Symbol]	1002" DIA. ST. PIPE

BASIN AREA

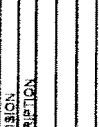

NO.	REVISION	DATE

GENERAL NOTES:  
 1. ALL WORK SHALL BE DONE IN ACCORDANCE WITH THE LATEST EDITIONS OF THE STANDARD SPECIFICATIONS FOR CONSTRUCTION OF PUBLIC WORKS, AS APPLICABLE.  
 2. ALL MATERIALS SHALL BE SUBJECT TO INSPECTION AND APPROVAL BY THE CITY ENGINEER.  
 3. ALL WORK SHALL BE DONE IN ACCORDANCE WITH THE CITY ENGINEER'S ORDINANCES AND REGULATIONS.  
 4. ALL WORK SHALL BE DONE IN ACCORDANCE WITH THE CITY ENGINEER'S ORDINANCES AND REGULATIONS.



QUALITY CONTROL  
 SUPERVISOR: [Name]  
 PROJECT NO.: [Number]  
 DATE: [Date]

QUADRANT: NW  
 KEY MAP: 489M  
 TILE NUMBER: 48976  
 P MAP: C0568

SEE SHEET 2

CITY OF HOUSTON DEPARTMENT OF PUBLIC WORKS AND ENGINEERING WASTEWATER OPERATIONS BRANCH PROJECT NO. 48976 DATE: 11/14/11
WORK ORDER NO. 12
PROJECT NO. R-00266-C-15-4
PROJECT ADDRESS: 4800010814
PROJECT LOCATION: [Address]
PROJECT DESCRIPTION: [Description]
PROJECT STATUS: [Status]
PROJECT CONTACT: [Contact]
PROJECT PHONE: [Phone]
PROJECT FAX: [Fax]
PROJECT EMAIL: [Email]
PROJECT WEBSITE: [Website]



# CITY OF HOUSTON

DEPARTMENT OF PUBLIC WORKS AND ENGINEERING  
 WASTEWATER OPERATIONS BRANCH  
 Wastewater Collection System Rehabilitation and Renewal  
 Subdivision: GREENTREE PLACE,  
 Council District: G

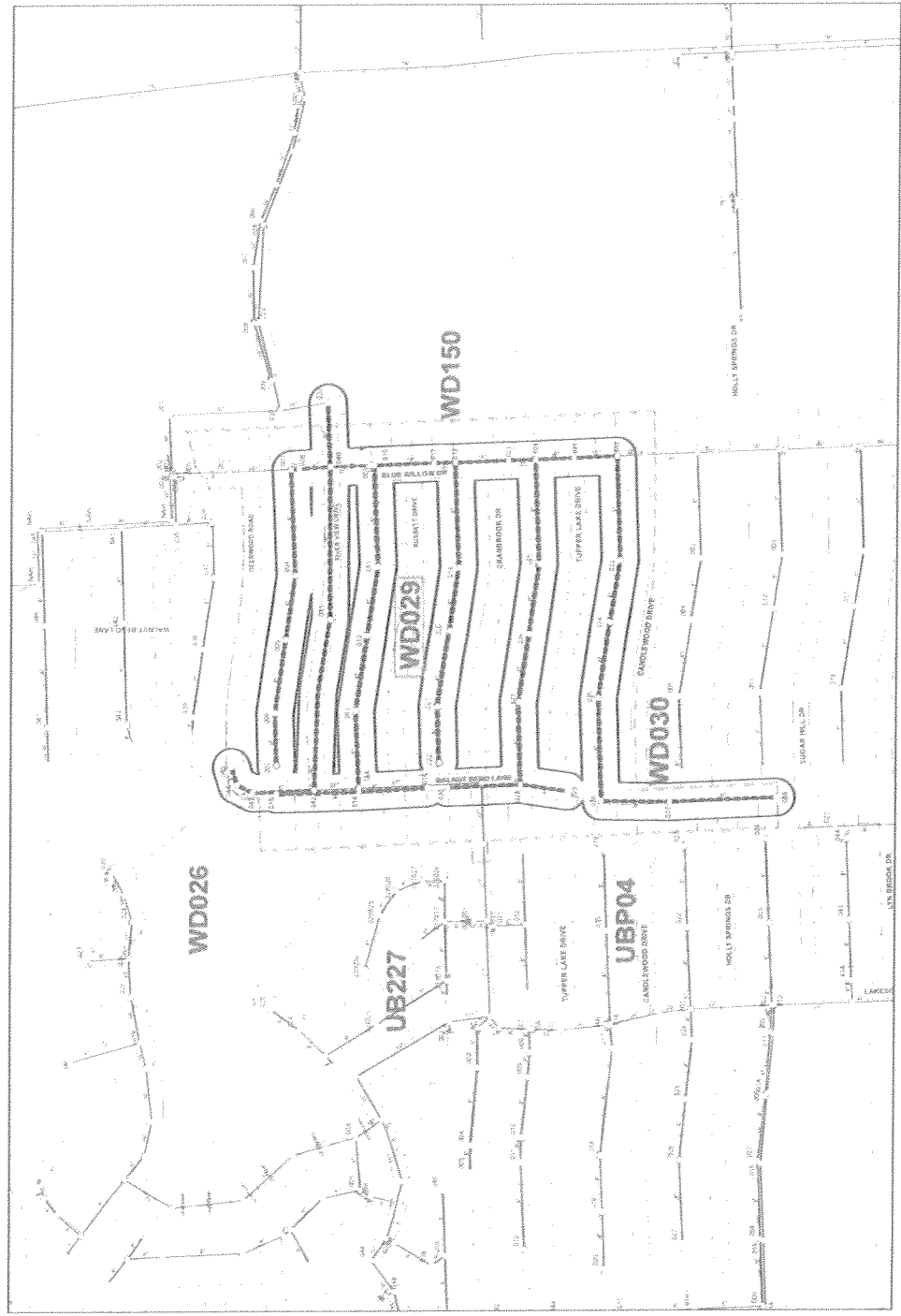

Project Site

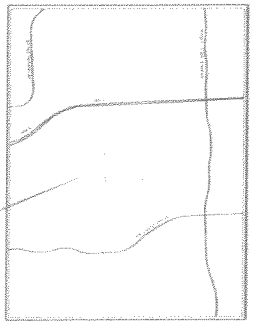

CITY OF HOUSTON DEPARTMENT OF PUBLIC WORKS AND ENGINEERING WASTEWATER OPERATIONS BRANCH HAZARDY WASTE CLEANUP AND REMEDIATION PROJECTS DIVISION OF REHABILITATION AND MAINTENANCE
WWT FILE NO: 4277-48 WORK ORDER NO: 13 JOB NO: R-002286-0155-4 OUTLINE AGREEMENT NO: 4500010814
TITLE: TUPPER LAKE DRIVE SEWER LIFT STATION DATE FOR LATEST REVISION: 08/11/2011 DRAWN BY: J. HARRIS CHECKED BY: J. HARRIS DATE FOR LATEST REVISION: 08/11/2011

CONTRACTOR: QUALITY CONTROL, L.P. 2100 S. 24th Street, Suite 1200 Houston, TX 77058 PHONE NO: 713-477-7271 FAX NO: 713-477-7271	QUADRANT: NW KEY MAP: 489L-Q TILE NUMBER: 4957C C/MAP: C0877
--	---

GENERAL NOTES: 1. EXACT LOCATION, ALIGNMENT, SIZE, AND DEPTH OF ALL EXISTING AND PROPOSED STRUCTURES SHALL BE AS SHOWN ON THIS PLAN. ALL STRUCTURES SHALL BE CONSTRUCTED TO MEET THE REQUIREMENTS OF THE CITY OF HOUSTON STANDARDS AND SPECIFICATIONS FOR WASTEWATER COLLECTION SYSTEMS.
--



NO.	REVISION	DATE

NO.	REVISION	DATE

NO.	REVISION	DATE





# CITY OF HOUSTON

DEPARTMENT OF PUBLIC WORKS AND ENGINEERING  
WASTEWATER OPERATIONS BRANCH

Sanitary Sewer Cleaning and Television Inspection in Support of Rehabilitation  
Subdivision: JOHN BRASHEAR  
Council District: H

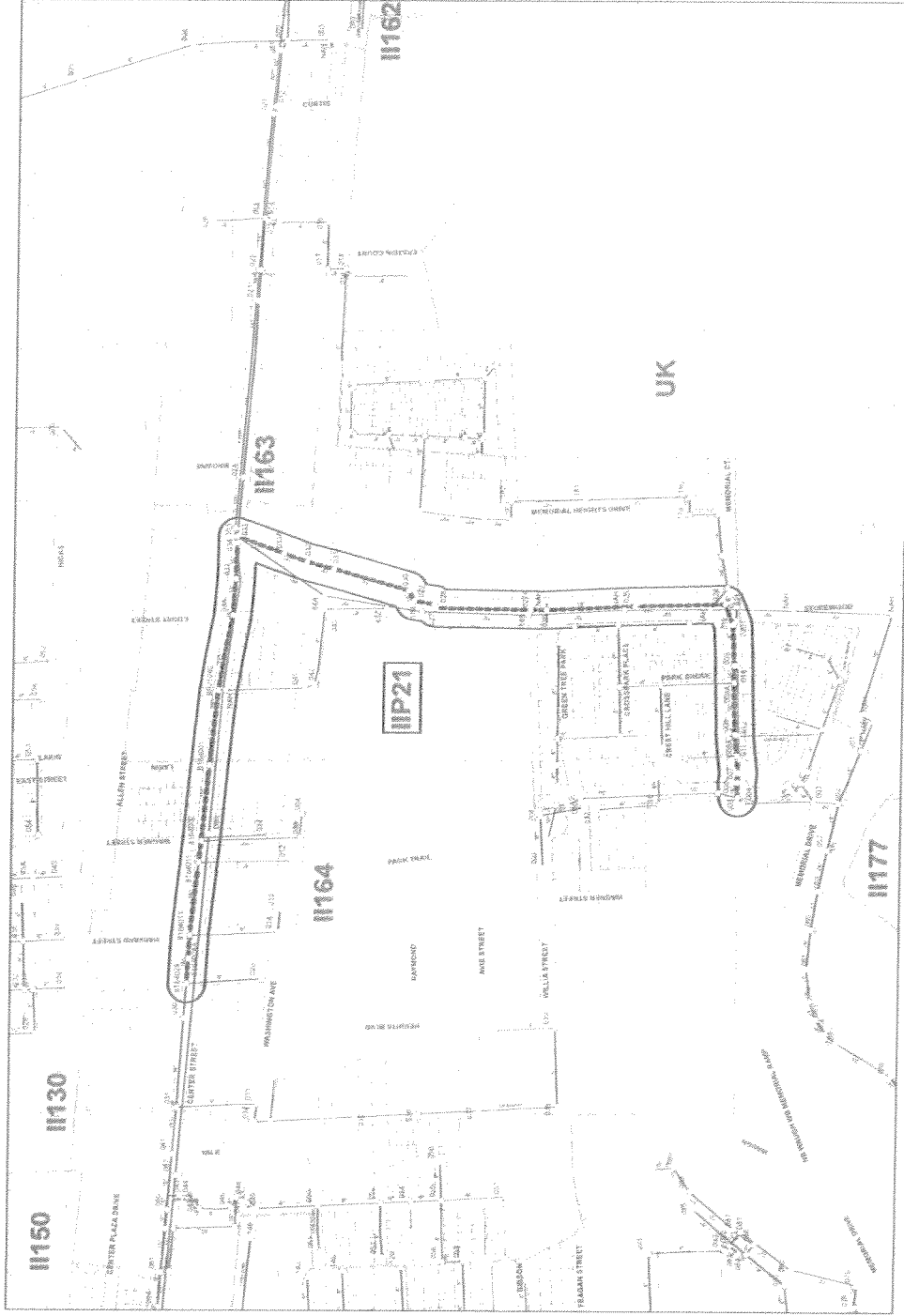

Project Site

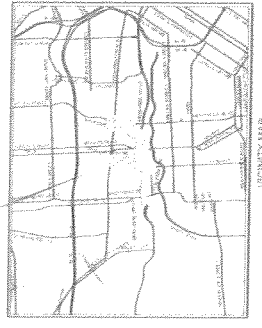

CITY OF HOUSTON DEPARTMENT OF PUBLIC WORKS AND ENGINEERING WASTEWATER OPERATIONS BRANCH	
SAFETY REVIEW, CLEANING AND TELEVISION INSPECTION AND REPAIRS PROJECT NO. 1511-001-001 DRAWING NO. 1511-001-001	
DATE: 08/11/2011	BY: J. BRASHEAR
SCALE: 1" = 40'	PROJECT NO. 1511-001-001
APP. NO. R-000286-0155-4	DATE: 08/11/2011
DATE: 08/11/2011	PROJECT NO. 1511-001-001
DATE: 08/11/2011	PROJECT NO. 1511-001-001
DATE: 08/11/2011	PROJECT NO. 1511-001-001
DATE: 08/11/2011	PROJECT NO. 1511-001-001

NO.	REVISION	DATE

GENERAL NOTES  
1. EXISTING SANITARY SEWER LINES ARE INDICATED BY  
DASHED LINES. EXISTING SANITARY MANHOLE SHALL BE AS SHOWN  
UNLESS OTHERWISE NOTED.  
2. ALL WORK SHALL BE IN ACCORDANCE WITH THE CITY OF HOUSTON  
STANDARD SPECIFICATIONS FOR CONSTRUCTION.  
3. ALL WORK SHALL BE IN ACCORDANCE WITH THE CITY OF HOUSTON  
STANDARD SPECIFICATIONS FOR CONSTRUCTION.



PROJECT BASIN(S) **IP21**

NO.	REVISION	DATE

QUADRANT: SE  
KEY MAP: 488E  
TITLE NUMBER: 5557a  
C MAP: C0818

# CITY OF HOUSTON

DEPARTMENT OF PUBLIC WORKS AND ENGINEERING  
 WASTEWATER OPERATIONS BRANCH  
 Sanitary Sewer Cleaning and Television Inspection in Support of Rehabilitation  
 Subdivision: KNOLLWOOD VILLAGE  
 Council District: C

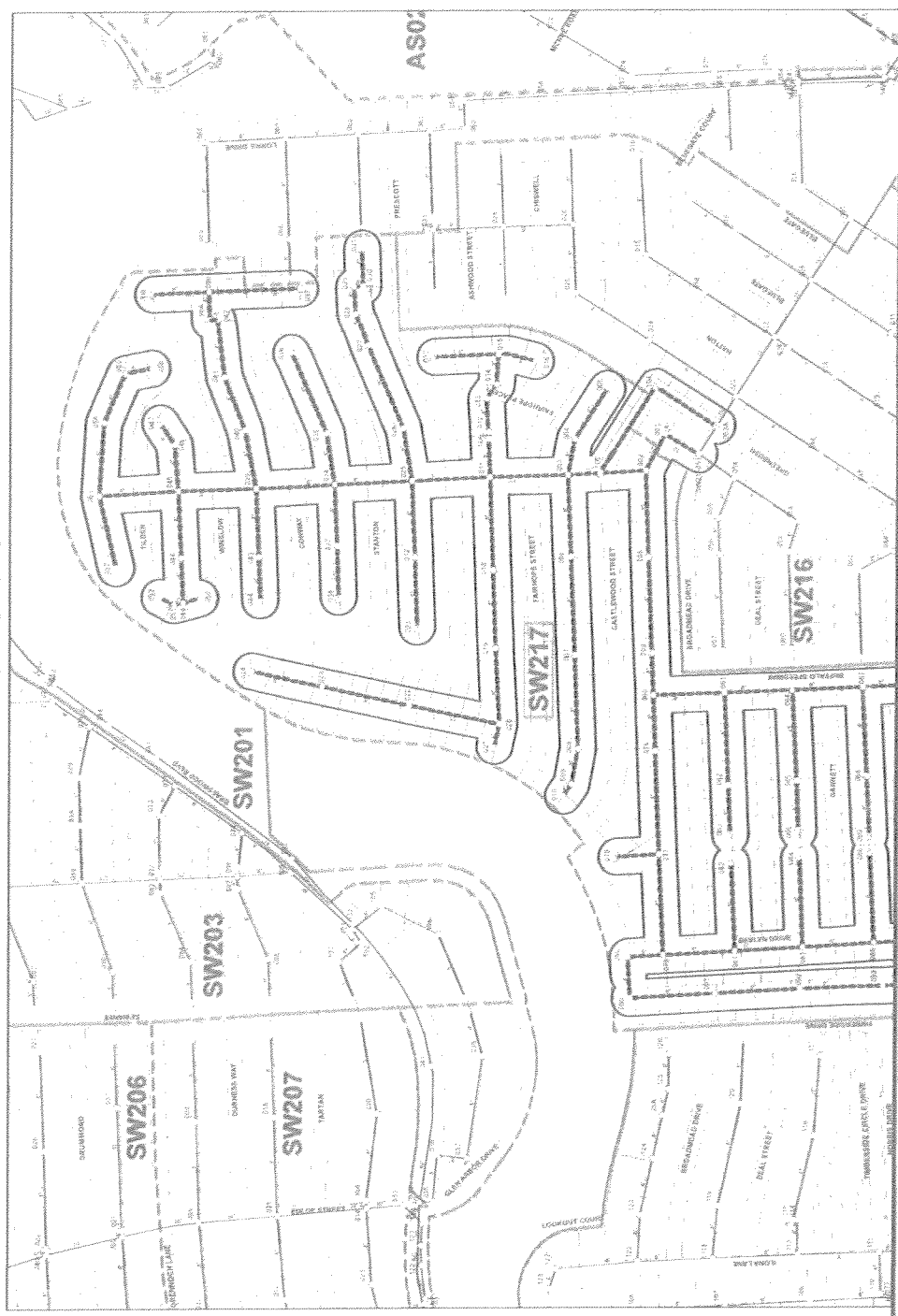

Project Site

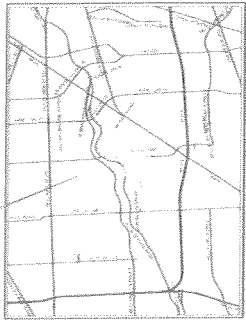

VICINITY MAP

LEGEND

	BASIN AREA SW217
--	------------------

CITY OF HOUSTON DEPARTMENT OF PUBLIC WORKS AND ENGINEERING WASTEWATER OPERATIONS BRANCH	
SANITARY SEWER CLEANING AND TELEVISION INSPECTION IN SUPPORT OF REHABILITATION KNOLLWOOD VILLAGE SUBDIVISION	
WV FILE NO.	4277-48
WORK ORDER NO.	17
CONTRACT	R-600268-0185-4
SO-CRACK ADDRESS OF NO.	4800510814
DATE OF PREPARED FOR ORIGINAL ISSUE	
DATE OF PREPARED FOR REVISION	
DATE OF PREPARED FOR FINAL REVIEW	
DATE OF PREPARED FOR APPROVAL	
DATE OF PREPARED FOR POST-CONSTRUCTION	

NO.	REVISION	DATE

QUADRANT: SW  
 KEY MAP: 532P  
 TILE NUMBER: 5054B  
 C MAP: C0881

2205 Main Street  
 Houston, Texas 77002  
 Telephone: (713) 473-3232  
 Fax: (713) 473-3232

QUALITY CONTROL  
 Control Testing Laboratory, Inc.  
 14000 Katy Road, Suite 100  
 Houston, TX 77050  
 Phone: (281) 711-4743  
 Fax: (281) 711-4743

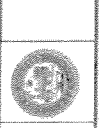

GENERAL NOTES  
 1. EXISTING SANITARY SEWER LINES ARE SHOWN BY DASHED LINES.  
 2. ALL SANITARY SEWER LINES SHALL BE 18" DIA. UNLESS NOTED OTHERWISE.  
 3. ALL SANITARY SEWER LINES SHALL BE 15' DEEP UNLESS NOTED OTHERWISE.  
 4. ALL SANITARY SEWER LINES SHALL BE 15' DEEP UNLESS NOTED OTHERWISE.  
 5. ALL SANITARY SEWER LINES SHALL BE 15' DEEP UNLESS NOTED OTHERWISE.

SEE SHEET 2







CITY OF HOUSTON DEPARTMENT OF PUBLIC WORKS WATER UTILITIES DIVISION SANITARY SEWER DIVISION INSPECTION & SUPPORT OF REGULATION JAMES L. GIBSON, DIRECTOR	SANITARY SEWER PROJECT NO. 4277-48 WORK ORDER NO. 18 A/S NO. R-00286-0195-4 CONTRACT AGREEMENT NO. 4600010614
CONTRACT NO. 4600010614 PROJECT NO. 4277-48 WORK ORDER NO. 18 A/S NO. R-00286-0195-4	DATE: 10/20/11 DRAWN BY: J. GIBSON CHECKED BY: J. GIBSON SCALE: AS SHOWN SHEET NO. 1 OF 1

QUADRANT: SW KEY MAP: 520J.N TILE NUMBER: 48540 C-MAP: C0875	CONTRACT NO. 4600010614 PROJECT NO. 4277-48 WORK ORDER NO. 18 A/S NO. R-00286-0195-4
---	---

GENERAL NOTES:  
 1. ALL WORK SHALL BE IN ACCORDANCE WITH THE LATEST EDITIONS OF THE HOUSTON SANITARY SEWER DESIGN MANUAL AND THE HOUSTON SANITARY SEWER DESIGN SPECIFICATIONS.  
 2. ALL WORK SHALL BE IN ACCORDANCE WITH THE LATEST EDITIONS OF THE HOUSTON SANITARY SEWER DESIGN MANUAL AND THE HOUSTON SANITARY SEWER DESIGN SPECIFICATIONS.  
 3. ALL WORK SHALL BE IN ACCORDANCE WITH THE LATEST EDITIONS OF THE HOUSTON SANITARY SEWER DESIGN MANUAL AND THE HOUSTON SANITARY SEWER DESIGN SPECIFICATIONS.



GENERAL NOTES:  
 1. ALL WORK SHALL BE IN ACCORDANCE WITH THE LATEST EDITIONS OF THE HOUSTON SANITARY SEWER DESIGN MANUAL AND THE HOUSTON SANITARY SEWER DESIGN SPECIFICATIONS.  
 2. ALL WORK SHALL BE IN ACCORDANCE WITH THE LATEST EDITIONS OF THE HOUSTON SANITARY SEWER DESIGN MANUAL AND THE HOUSTON SANITARY SEWER DESIGN SPECIFICATIONS.  
 3. ALL WORK SHALL BE IN ACCORDANCE WITH THE LATEST EDITIONS OF THE HOUSTON SANITARY SEWER DESIGN MANUAL AND THE HOUSTON SANITARY SEWER DESIGN SPECIFICATIONS.

NO.	REVISION	DATE

