

Parcel Map

Subject: Abandonment and sale of a prescriptive sanitary sewer easement, between Peden Street and Damon Court, from the western property line of Block 13, Lot 1 to the eastern property line of Block 13, Lot E, in exchange for conveyance of a 10-foot-wide sanitary sewer easement, all located within the Replat of Rosemont Heights Extension, out of the Obedience Smith Survey. Parcels SY14-112 and DY14-050

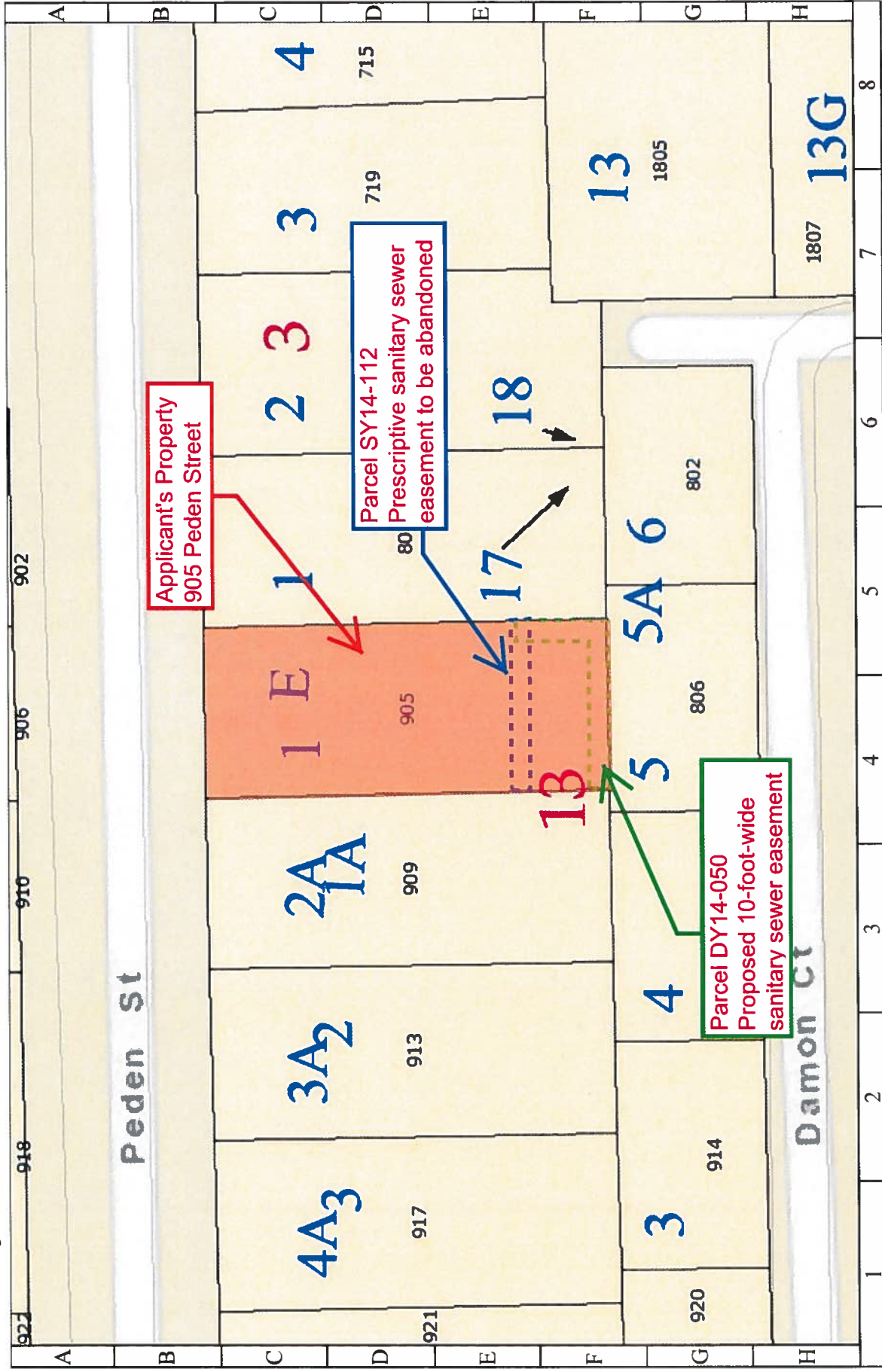

CITY OF HOUSTON
 Department of Public Works and Engineering
 Geographic Information & Management System (GIMS)

DISCLAIMER: THIS MAP REPRESENTS THE BEST INFORMATION AVAILABLE TO THE CITY.
 THE CITY DOES NOT WARRANT ITS ACCURACY OR COMPLETENESS.
 FIELD VERIFICATIONS SHOULD BE DONE AS NECESSARY.

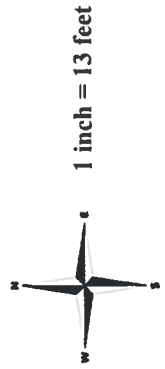

Council District C

Subject: Abandonment and sale of a prescriptive sanitary sewer easement, between Peden Street and Damon Court, from the western property line of Block 13, Lot 1 to the eastern property line of Block 13, Lot E, in exchange for conveyance of a 10-foot-wide sanitary sewer easement, all located within the Replat of Rosemont Heights Extension, out of the Obedience Smith Survey. Parcels SY14-112 and DY14-050

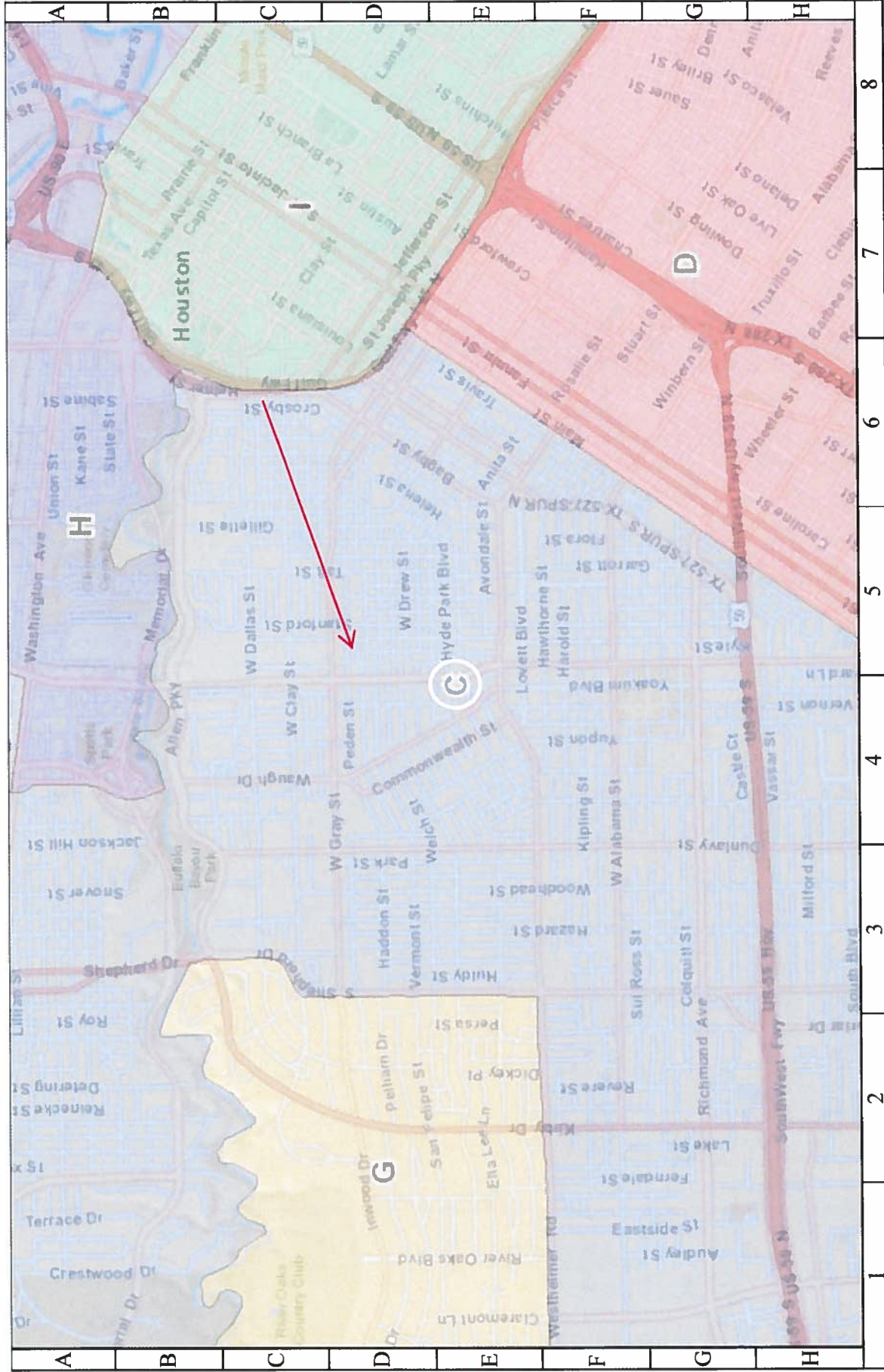

CITY OF HOUSTON
Department of Public Works and Engineering
Geographic Information & Management System (GIMS)

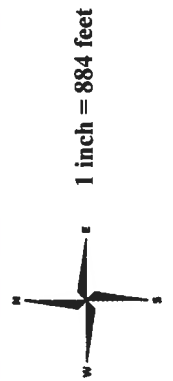

DISCLAIMER: THIS MAP REPRESENTS THE BEST INFORMATION AVAILABLE TO THE CITY.
 THE CITY DOES NOT WARRANT ITS ACCURACY OR COMPLETENESS.
 FIELD VERIFICATIONS SHOULD BE DONE AS NECESSARY.

Council District C

Subject: Abandonment and sale of a prescriptive sanitary sewer easement; between Peden Street and Damon Court, from the western property line of Block 13, Lot 1 to the eastern property line of Block 13, Lot E, in exchange for conveyance of a 10-foot-wide sanitary sewer easement, all located within the Replat of Rosemont Heights Extension, out of the Obedience Smith Survey. Parcels SY14-112 and DY14-050

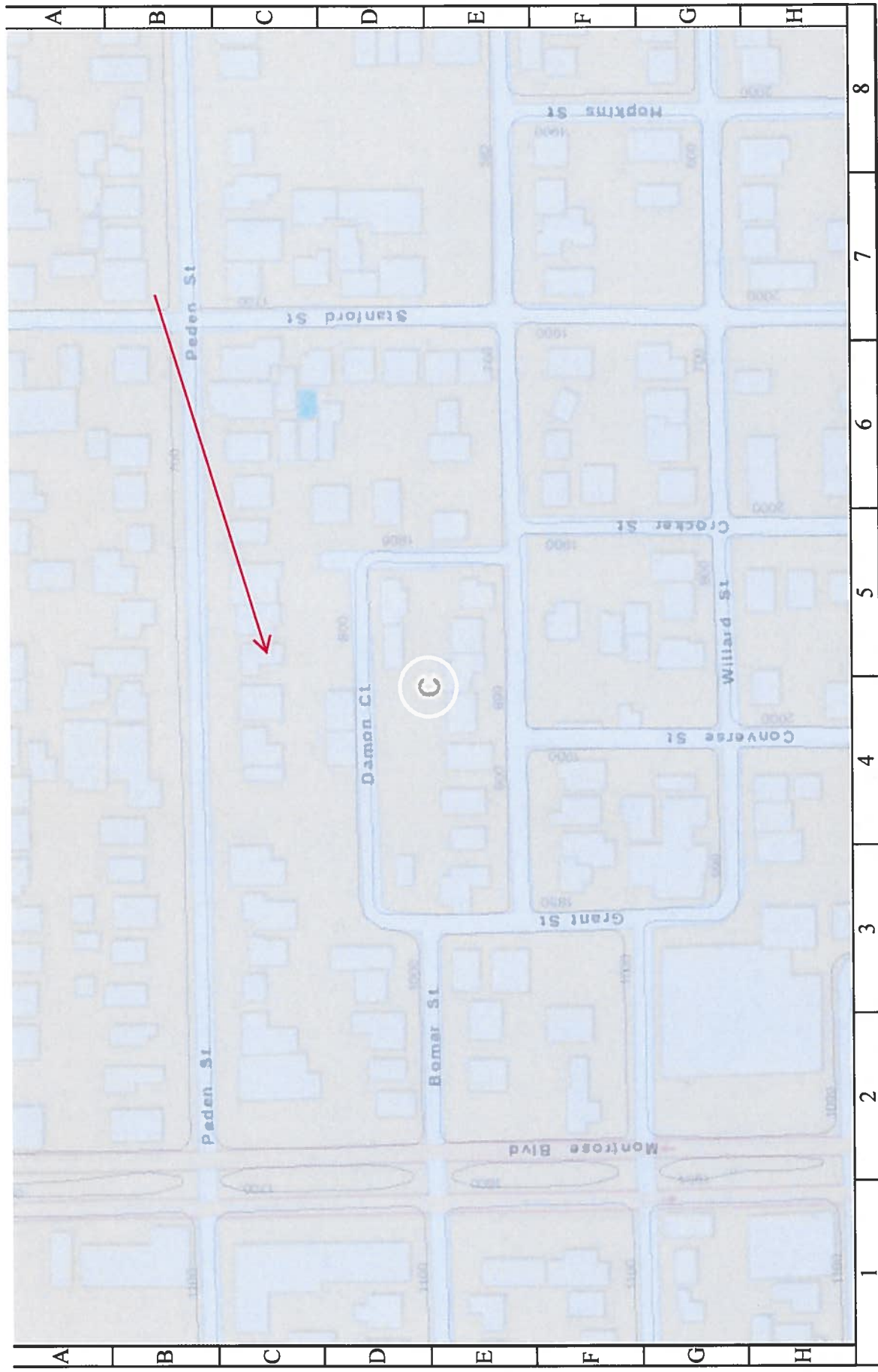

CITY OF HOUSTON
Department of Public Works and Engineering
Geographic Information & Management System (GIMS)

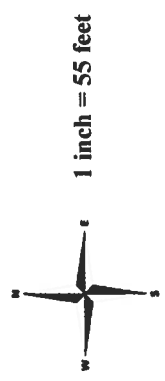

DISCLAIMER: THIS MAP REPRESENTS THE BEST INFORMATION AVAILABLE TO THE CITY.
THE CITY DOES NOT WARRANT ITS ACCURACY OR COMPLETENESS.
FIELD VERIFICATIONS SHOULD BE DONE AS NECESSARY.