

Parcel Map

**Subject:** Abandonment and sale of: 1) a portion of a 10-foot-wide water line easement and 2) a portion of a 20-foot-wide sanitary sewer easement, in exchange for conveyance of: 1) a 20-foot-wide water line easement, 2) a 100-square-foot fire hydrant easement, and (3) a 25-foot-wide sanitary sewer easement, all located within Block 1, Unrestricted Reserve A of Willowbrook Mall, out of the G. W. Childress Survey, A-217. **Parcels SY15-092A, SY15-092B, KY15-172, KY15-173, and DY15-101**

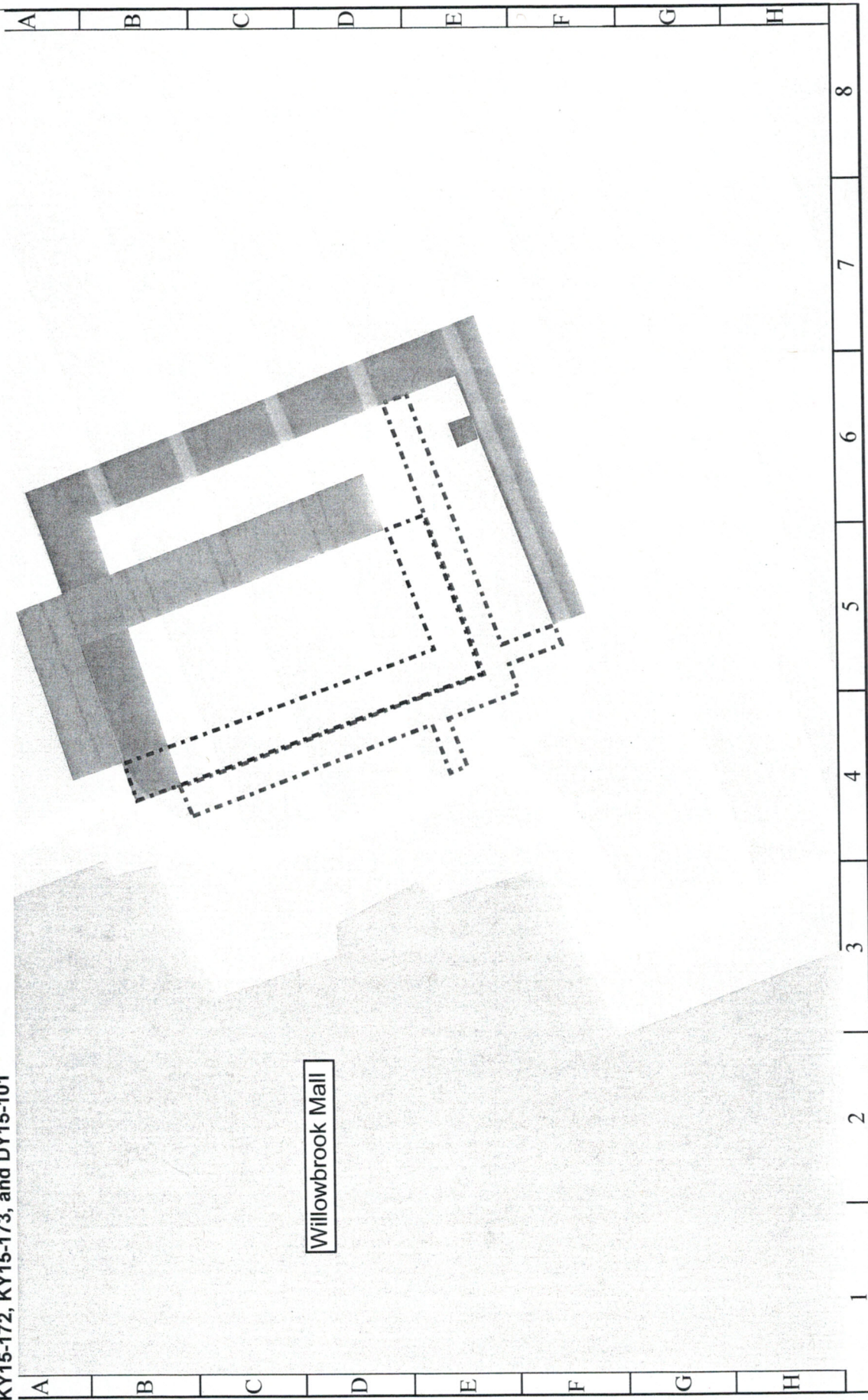

Willowbrook Mall



**CITY OF HOUSTON**  
**Department of Public Works and Engineering**  
**Geographic Information & Management System (GIMS)**

Legend

Parcel SY15-092A	.....
Parcel SY15-092B	-----
Parcel KY15-172	————
Parcel KY15-173	—————
Parcel DY15-101	————

DISCLAIMER: THIS MAP REPRESENTS THE BEST INFORMATION AVAILABLE TO THE CITY.  
 THE CITY DOES NOT WARRANT ITS ACCURACY OR COMPLETENESS.  
 FIELD VERIFICATIONS SHOULD BE DONE AS NECESSARY.

Location Map

**Subject:** Abandonment and sale of: 1) a portion of a 10-foot-wide water line easement and 2) a portion of a 20-foot-wide sanitary sewer easement, in exchange for conveyance of: 1) a 20-foot-wide water line easement, 2) a 100-square-foot fire hydrant easement, and 3) a 25-foot-wide sanitary sewer easement, all located within Block 1, Unrestricted Reserve A of Willowbrook Mall, out of the G. W. Childress Survey, A-217. **Parcels SY15-092A, SY15-092B, KY15-172, KY15-173, and DY15-101**

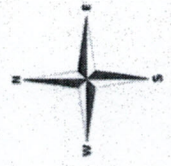
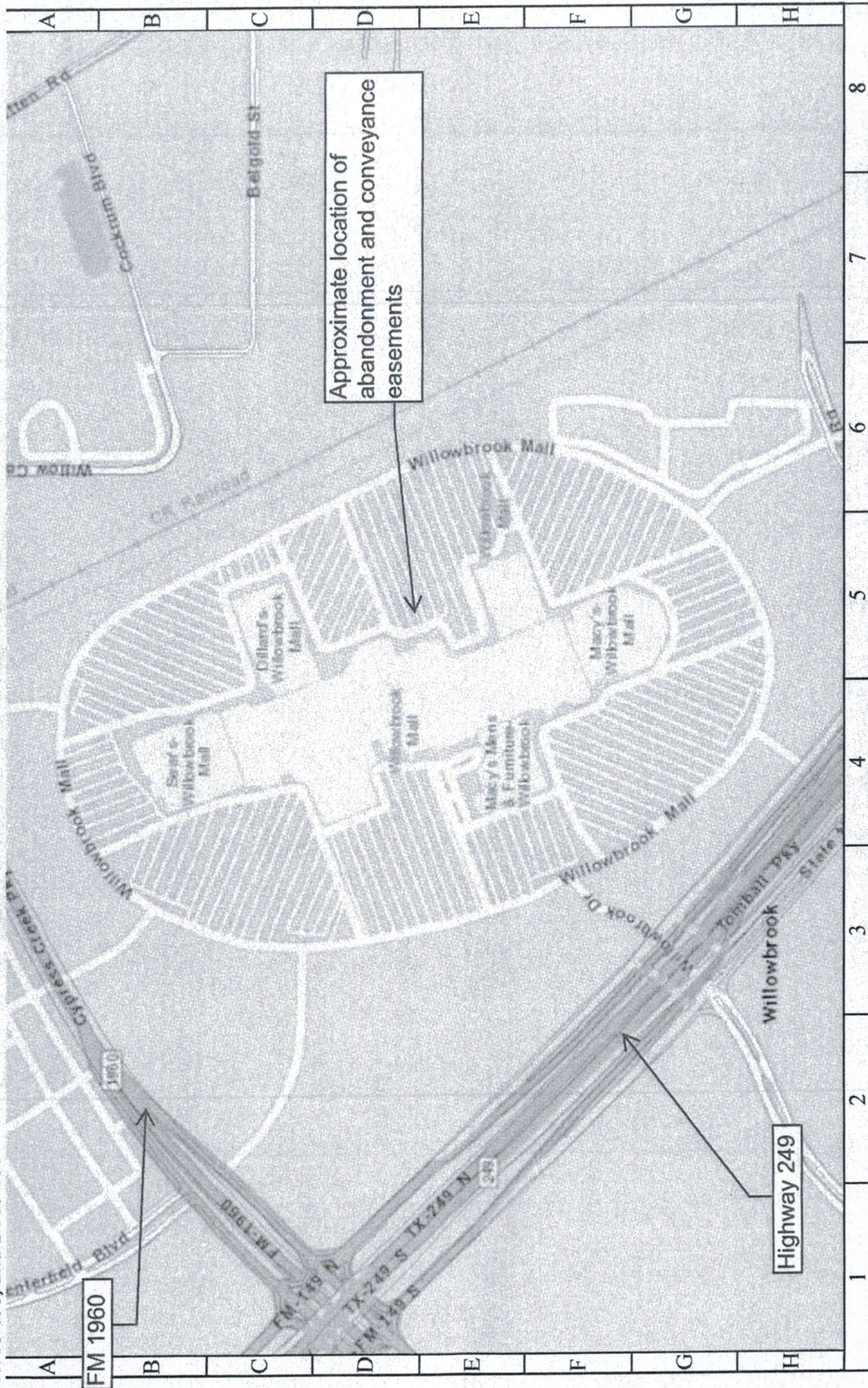

1 inch = 203 feet

**CITY OF HOUSTON**  
**Department of Public Works and Engineering**  
**Geographic Information & Management System (GIMS)**

DISCLAIMER: THIS MAP REPRESENTS THE BEST INFORMATION AVAILABLE TO THE CITY. THE CITY DOES NOT WARRANT ITS ACCURACY OR COMPLETENESS. FIELD VERIFICATIONS SHOULD BE DONE AS NECESSARY.



