

PARCEL MAP

SUBJECT: Abandonment of a portion of Chenevert Street, from Capitol Street to Texas Avenue, located in the South Side Buffalo Bayou Addition, out of the J. S. Holman Survey, A-323. Parcel SY14-048

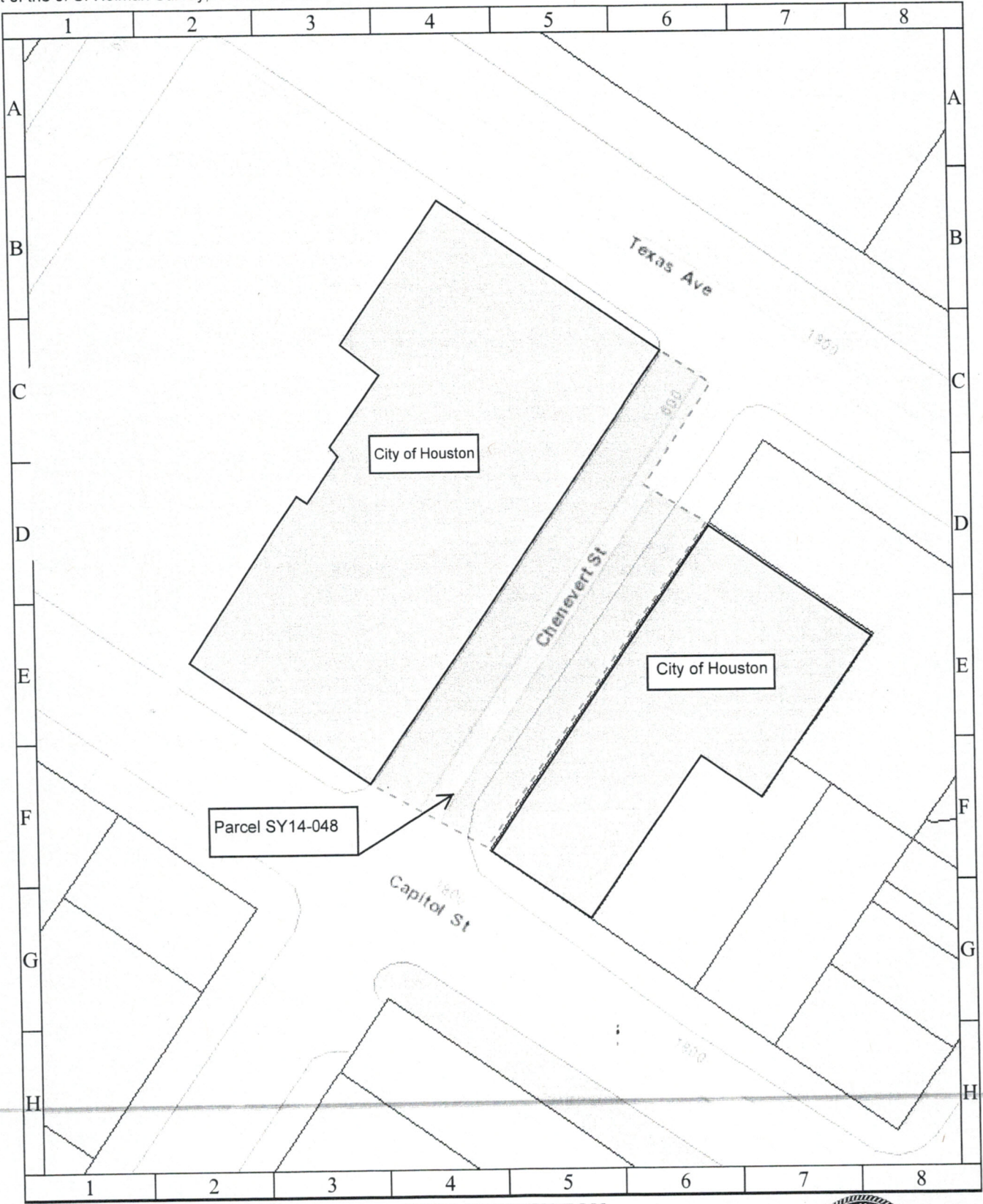

Parcel SY14-048

City of Houston

City of Houston

CITY OF HOUSTON

1 inch = 22 feet

Department of Public Works and Engineering
Geographic Information & Management System (GIMS)

DISCLAIMER: THIS MAP REPRESENTS THE BEST INFORMATION AVAILABLE TO THE CITY.



Council District I

SUBJECT: abandonment of a portion of Chenevert Street, from Capitol Street to Texas Avenue, located in the South Side Buffalo Bayou Addition, out of the J. S. Holman Survey, A-323.
Parcels SY14-048



City of Houston
Generated by the My City Application

Disclaimer:
The map is only for informational purposes and may not have been prepared for or be suitable for legal, engineering, or surveying purposes and does not represent an on-the-ground survey and only represents the approximate relative location of property boundaries

