

REID ROAD MUD NO. 2

(Acres to be annexed: 13.14 , Key Map: 370W)

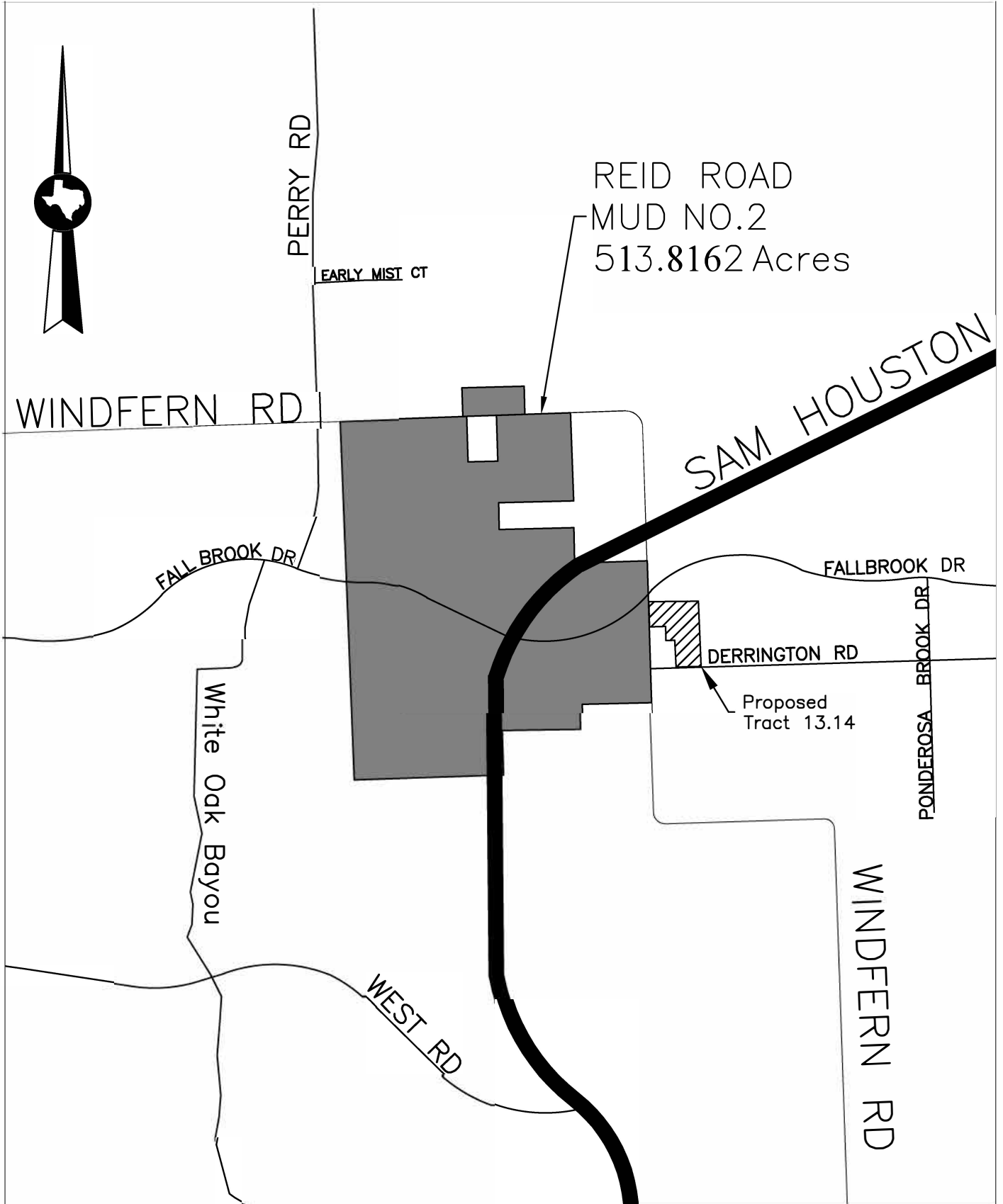

VICINITY MAP
N.T.S.

Reid Road Municipal Utility District No. 2 (13.14 acres)

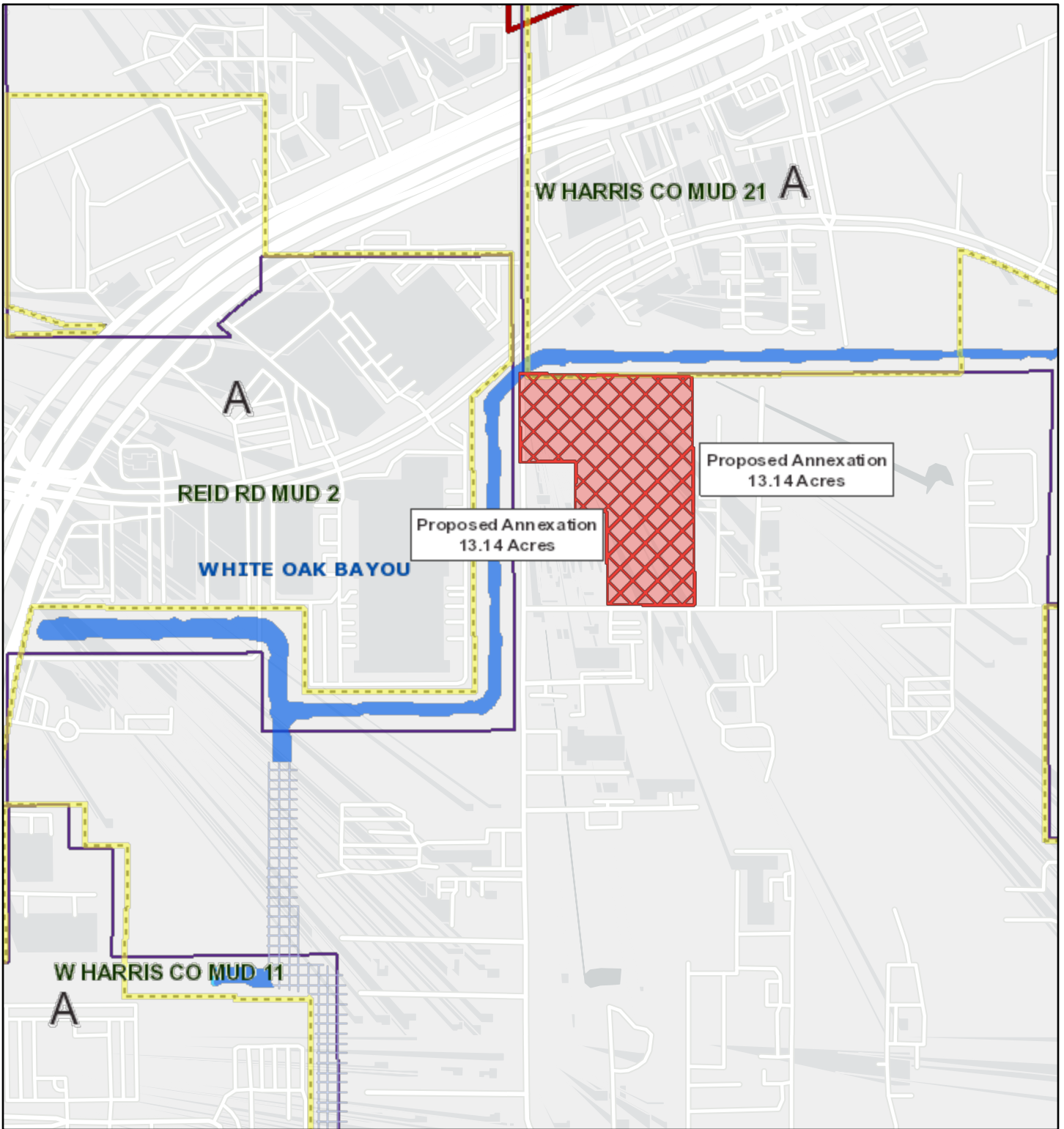

9/26/2023, 8:36:50 AM

1:9,028

- █ Watersheds
- █ Texas Senate Districts
- █ Texas House Districts
- █ Flood Hazard Zones
- █ 100 Year Floodplain
- █ 500 Year Floodplain
- ▤ Floodway
- █ City Limits
- █ Council Districts
- █ Existing Acreage of District

