

Scale: 1" = 1 Mile

**FORT BEND COUNTY  
MUNICIPAL UTILITY  
DISTRICT 134F  
364.652 ACRES**

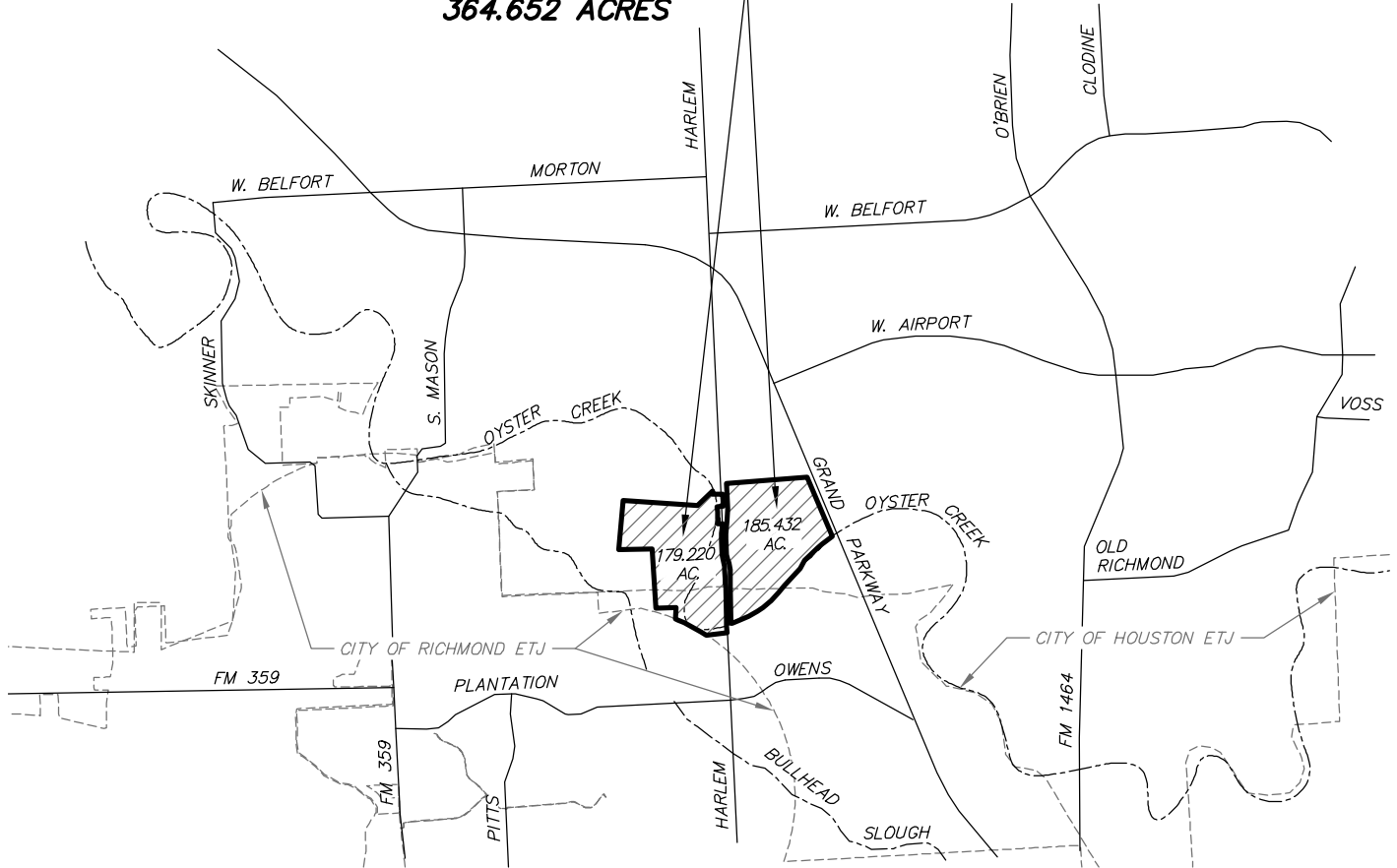

**NOTES:**

1. This document was prepared under 22 TAC §663.21, does not reflect the results of an on the ground survey, and is not to be used to convey or establish interests in real property except those rights and interests implied or established by the creation or reconfiguration of the boundary of the political subdivision for which it was prepared.
2. This exhibit was prepared to graphically depict the general location of the District. Some existing roadways have been omitted due to the scale and to improve the clarity of this exhibit.

**FORT BEND COUNTY  
MUNICIPAL UTILITY DISTRICT  
134F  
VICINITY MAP EXHIBIT**

364.652 ACRES OF LAND LOCATED IN THE WILLIAM MORTON ONE AND ONE-HALF LEAGUE GRANT, ABSTRACT 62, AND THE JANE WILKINS ONE LEAGUE GRANT, ABSTRACT 96 FORT BEND COUNTY, TEXAS



**GBI PARTNERS**  
LAND SURVEYING CONSULTANTS

4724 VISTA ROAD • PASADENA, TX 77505  
PHONE: 281-499-4539 • www.gbisurvey.com  
TBPELS FIRM # 10130300, 10194423

SCALE: 1" = 1 MILE	JOB NO. 211003	DATE: 03/31/2016
CREW CHIEF: N/A	FIELD BOOK: N/A	DWG.: 134F V-MAP_rev1

# Fort Bend County Municipal Utility District No. 134F (364.652 acres)

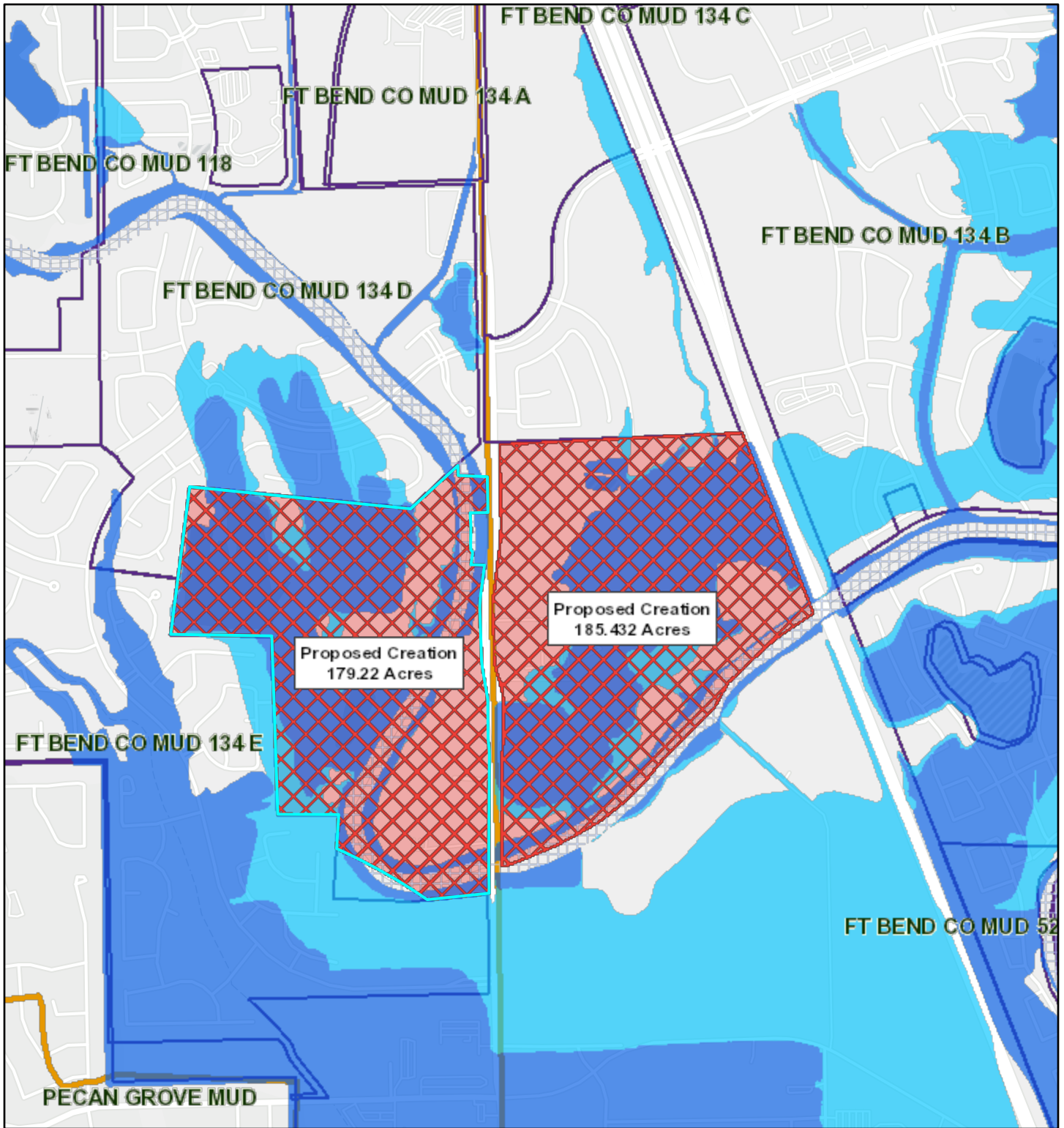

5/31/2022, 2:06:36 PM

1:18,056

- Texas Senate Districts
- Texas House Districts
- 100 Year Floodplain
- 500 Year Floodplain
- Floodway
- City Limits
- Council Districts
- Existing Acreage of District
- Proposed Annexation

