

Parcel Map

Sale of an excess fee-owned portion of Pleasantville Drive, from Munn Street Extension north along Lot 36B-1, Block 3, and Lot 36B-2, Block 4 to a proposed cul-de-sac, in exchange for conveyance to the City of right-of-way for a proposed cul-de-sac, located in the Glendale Subdivision, out of the John Brown Survey, A-8. Parcels SY15-006, AY15-083A, and AY15-083B

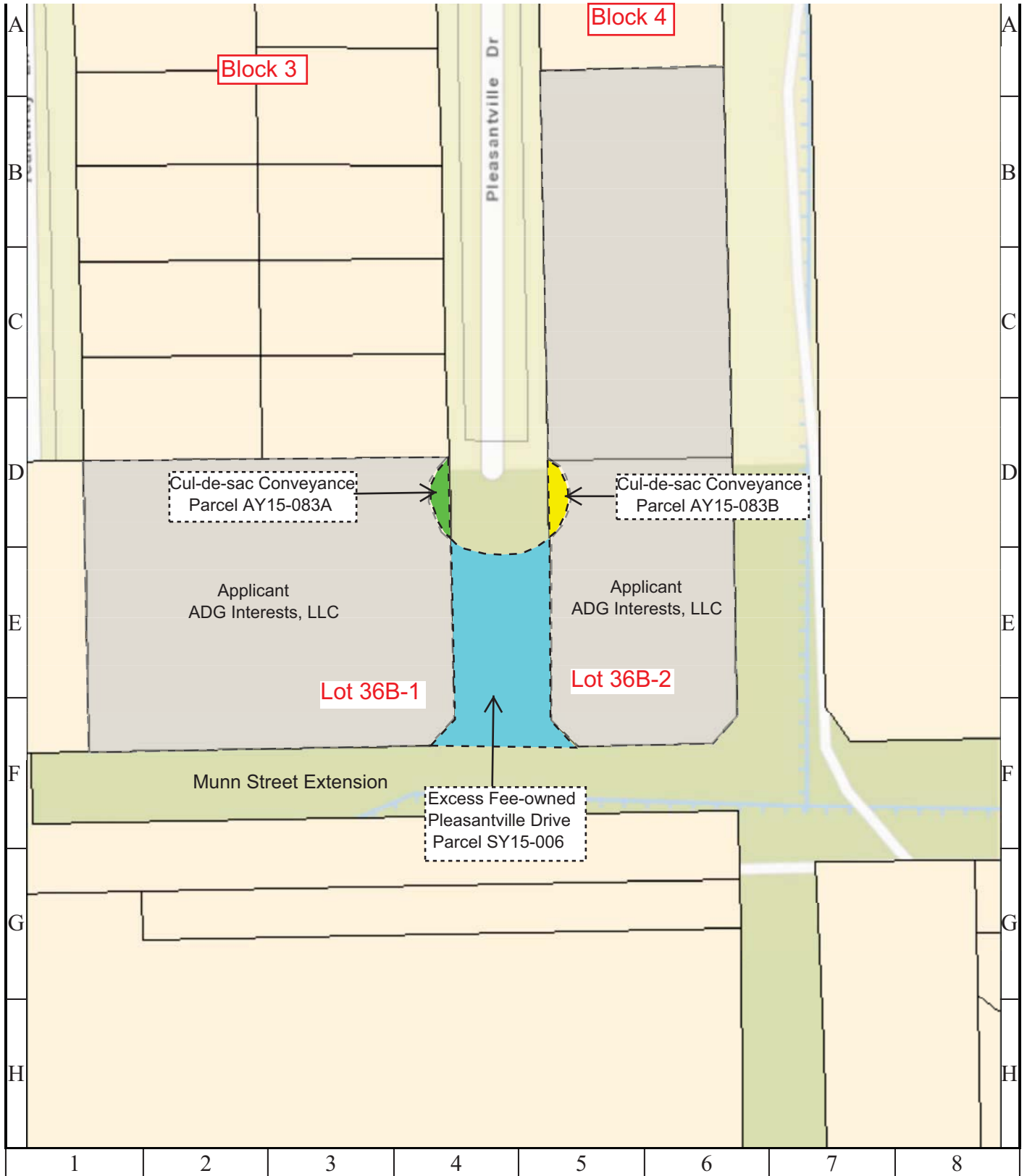

CITY OF HOUSTON
Department of Public Works and Engineering
1 inch = 27 feet Geographic Information & Management System (GIMS)

DISCLAIMER: THIS MAP REPRESENTS THE BEST INFORMATION AVAILABLE TO THE CITY.
THE CITY DOES NOT WARRANT ITS ACCURACY OR COMPLETENESS.
FIELD VERIFICATIONS SHOULD BE DONE AS NECESSARY.

