

# Abandonment and sale of St. Elmo Street

Abandonment and sale of St. Elmo Street, from Oats Street south to its terminus, out of the Burke Addition, Section Two, out of the Harris and Wilson Survey, Abstract 32.  
(Ruby Nunez of Pioneer Engineering on behalf of Roberto and Janet Sessargeo, Owners)

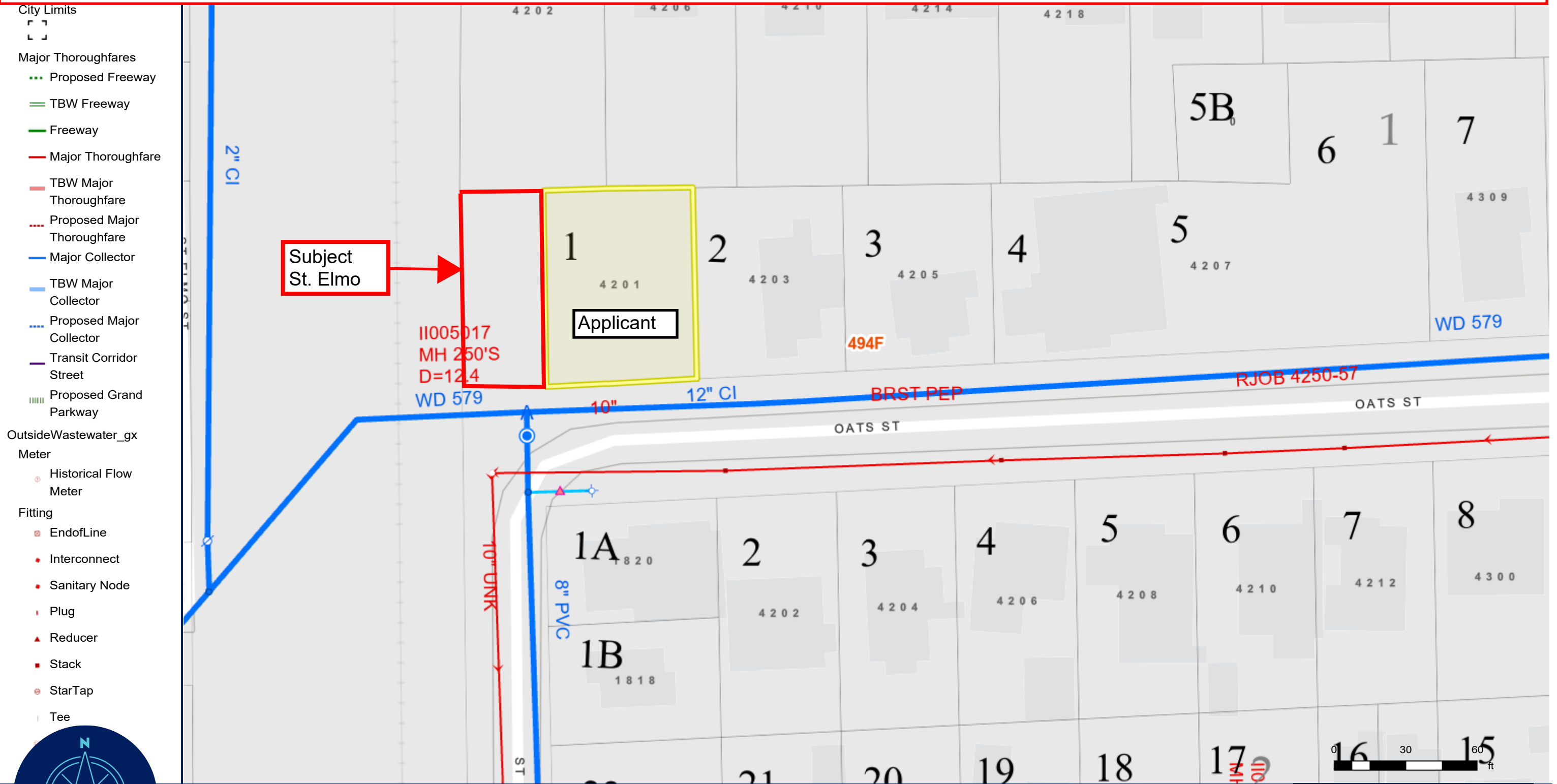

- City Limits
- Major Thoroughfares
  - Proposed Freeway
  - TBW Freeway
  - Freeway
  - Major Thoroughfare
  - TBW Major Thoroughfare
  - Proposed Major Thoroughfare
  - Major Collector
  - TBW Major Collector
  - Proposed Major Collector
  - Transit Corridor Street
  - Proposed Grand Parkway
- OutsideWastewater\_gx Meter
  - Historical Flow Meter
- Fitting
  - EndofLine
  - Interconnect
  - Sanitary Node
  - Plug
  - Reducer
  - Stack
  - StarTap
  - Tee

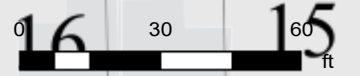

The following data sets were generated by and for the Houston Public Works Department. The asset information within this map are continually being updated, refined and are being provided to your organization for official use only and remains the property of the Houston Public Works Department. Providing this document to you does not constitute a release under the Freedom of Information Act (5 U.S.C. (Section) 552), and due to the sensitivity of the information, this document must be appropriately safeguarded. PLEASE NOTE that these data sets are NOT intended to be used as an authoritative public record for any geographic location or as a legal document and have no legal force or effect. Users are responsible for checking the accuracy, completeness, currency and/or suitability of these datasets themselves. The Department makes no representation, guarantee or warranty as to the accuracy, completeness, currency, or suitability of these datasets, which are provided "AS IS".

