

# BAMMEL UTILITY DISTRICT

## PROPOSED ANNEXATION OF 45.580 ACRES OF LAND

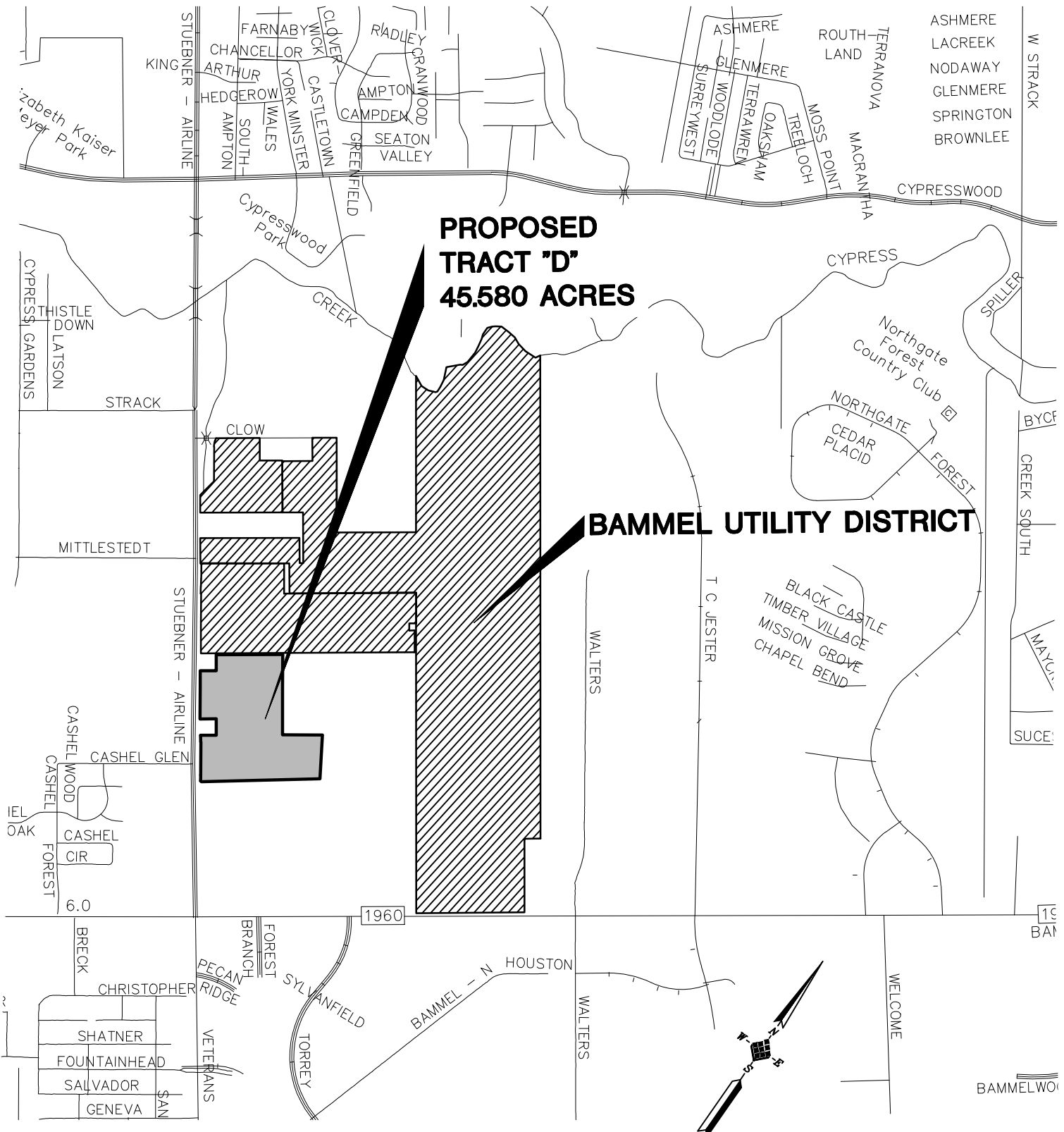

**PROPOSED  
TRACT "D"  
45.580 ACRES**

**BAMMEL UTILITY DISTRICT**

**VICINITY MAP**  
N.T.S.

**LEGEND:**

	BAMMEL U.D. BOUNDARY
	PROPOSED ANNEXATION

	ACRES
EXISTING TOTAL DISTRICT AREA	403.4947
ANNEXATION TRACT "D"	45.580
<b>PROPOSED TOTAL DISTRICT AREA</b>	<b>449.0747</b>

# Bammel Utility District (45.58 acres)

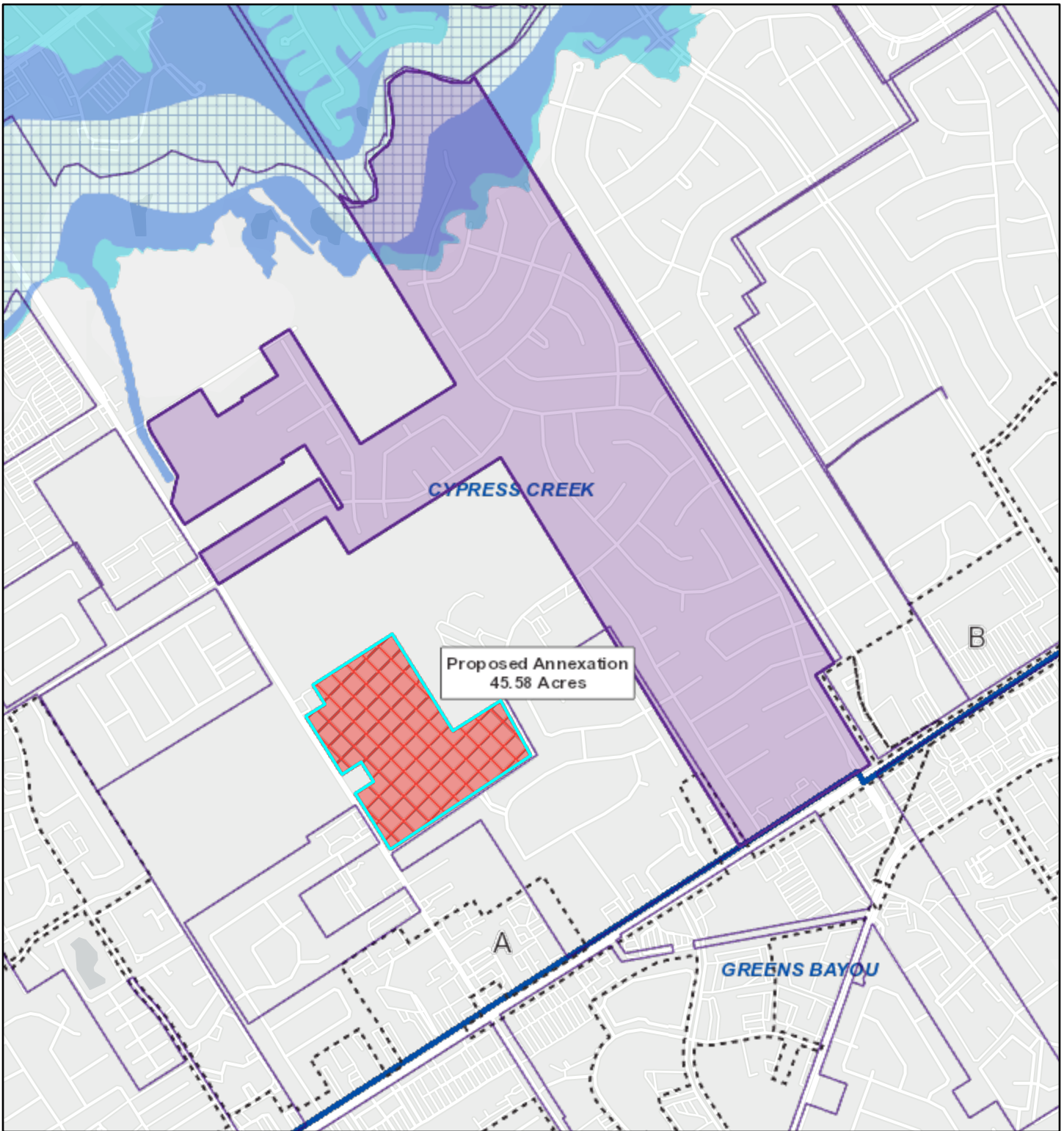

7/9/2020, 12:56:27 PM

1:18,056

- |                           |                              |
|---------------------------|------------------------------|
| <b>Flood Hazard Zones</b> | Council Districts            |
| 100 Year Floodplain       | Existing Acreage of District |
| 500 Year Floodplain       | Proposed Annexation          |
| Floodway                  | COH Wastewater Line          |
| City Limits               | COH Water Line               |

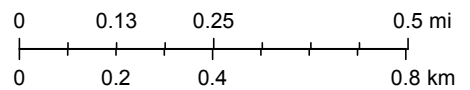

HCFC and HCED,