

[J:\Hort\06-03-2020 3:33 PM\K:\Survey\ALES\Projects\1\_Clients\ASEI - A&S Engineers, Inc.\49101-19\_Sunbelt\_Breen\Survey\Drawings\Autocad\SPWSD\_Vicinity Map (HC).dwg][2.4844 Acres]

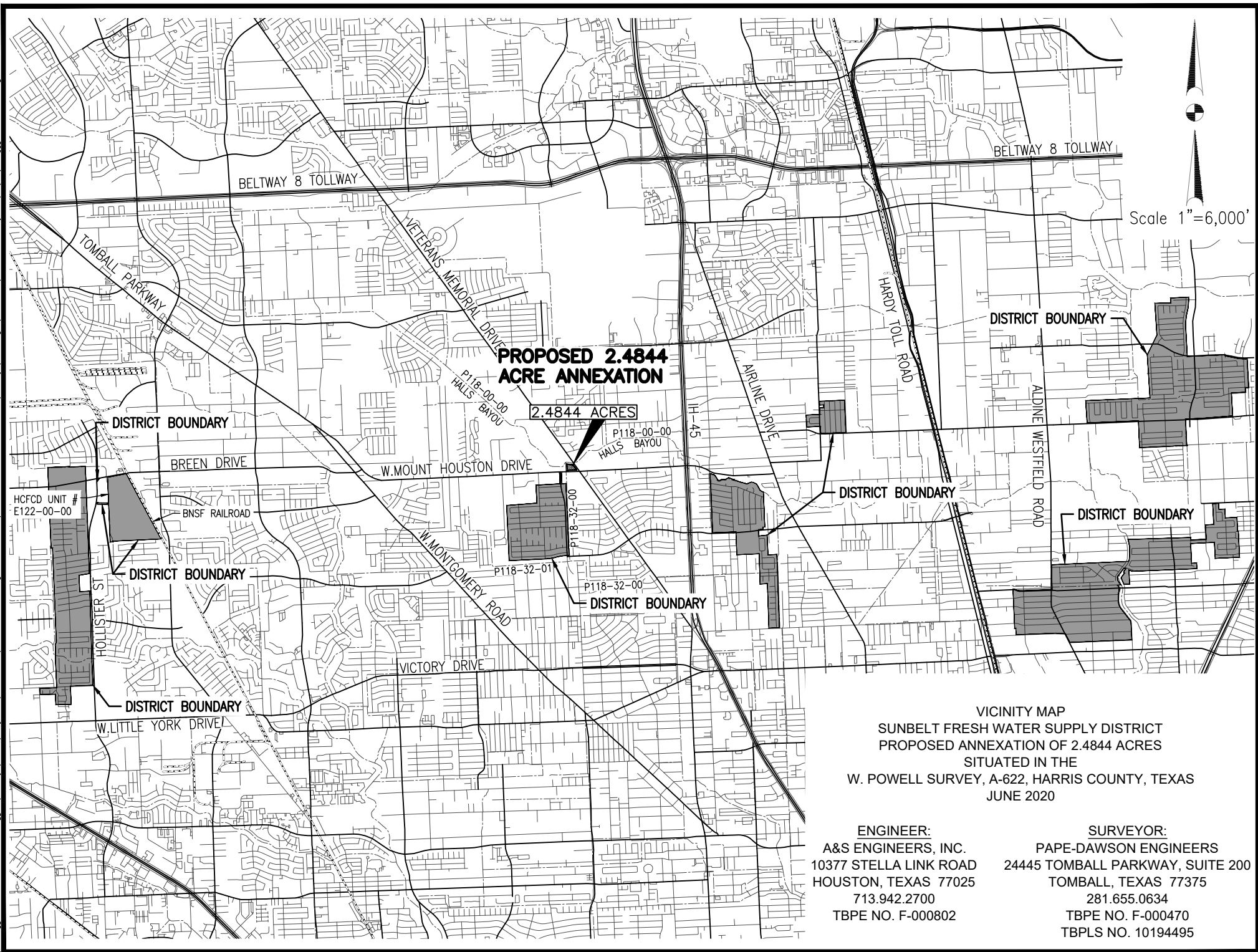

Scale 1"=6,000'

**PROPOSED 2.4844  
ACRE ANNEXATION**

2.4844 ACRES

VICINITY MAP  
SUNBELT FRESH WATER SUPPLY DISTRICT  
PROPOSED ANNEXATION OF 2.4844 ACRES  
SITUATED IN THE  
W. POWELL SURVEY, A-622, HARRIS COUNTY, TEXAS  
JUNE 2020

ENGINEER:  
A&S ENGINEERS, INC.  
10377 STELLA LINK ROAD  
HOUSTON, TEXAS 77025  
713.942.2700  
TBPE NO. F-000802

SURVEYOR:  
PAPE-DAWSON ENGINEERS  
24445 TOMBALL PARKWAY, SUITE 200  
TOMBALL, TEXAS 77375  
281.655.0634  
TBPE NO. F-000470  
TBPLS NO. 10194495

# Sunbelt FWSD - Heather Glen Subdivision (2.4844 acres)

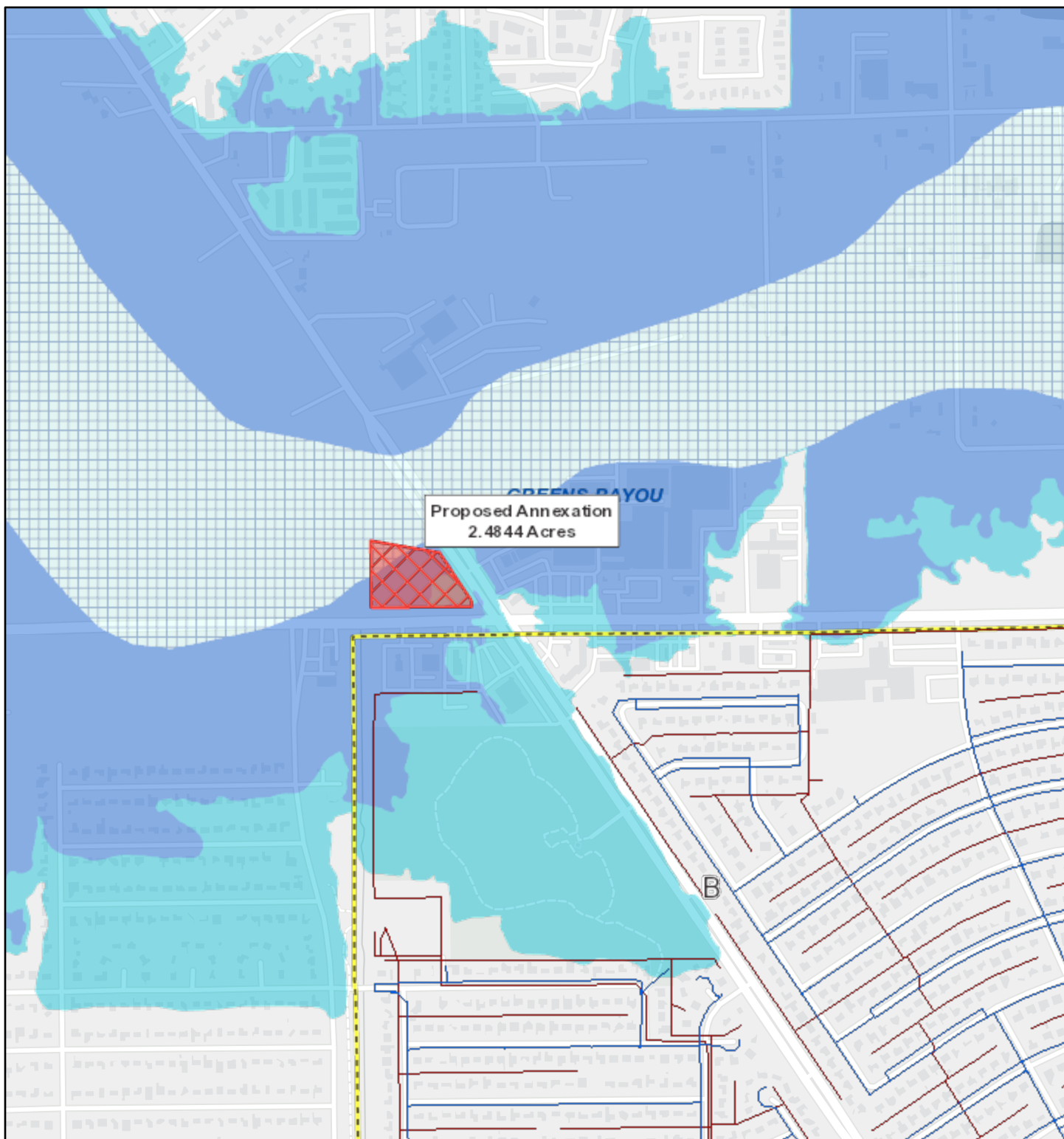

6/3/2020, 1:27:58 PM

1:9,028

- |                           |                              |
|---------------------------|------------------------------|
| <b>Flood Hazard Zones</b> | Council Districts            |
| 100 Year Floodplain       | Existing Acreage of District |
| 500 Year Floodplain       | Proposed Annexation          |
| Floodway                  | COH Wastewater Line          |
| City Limits               | COH Water Line               |

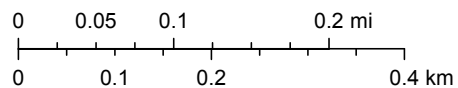

HCFC and HCED,