

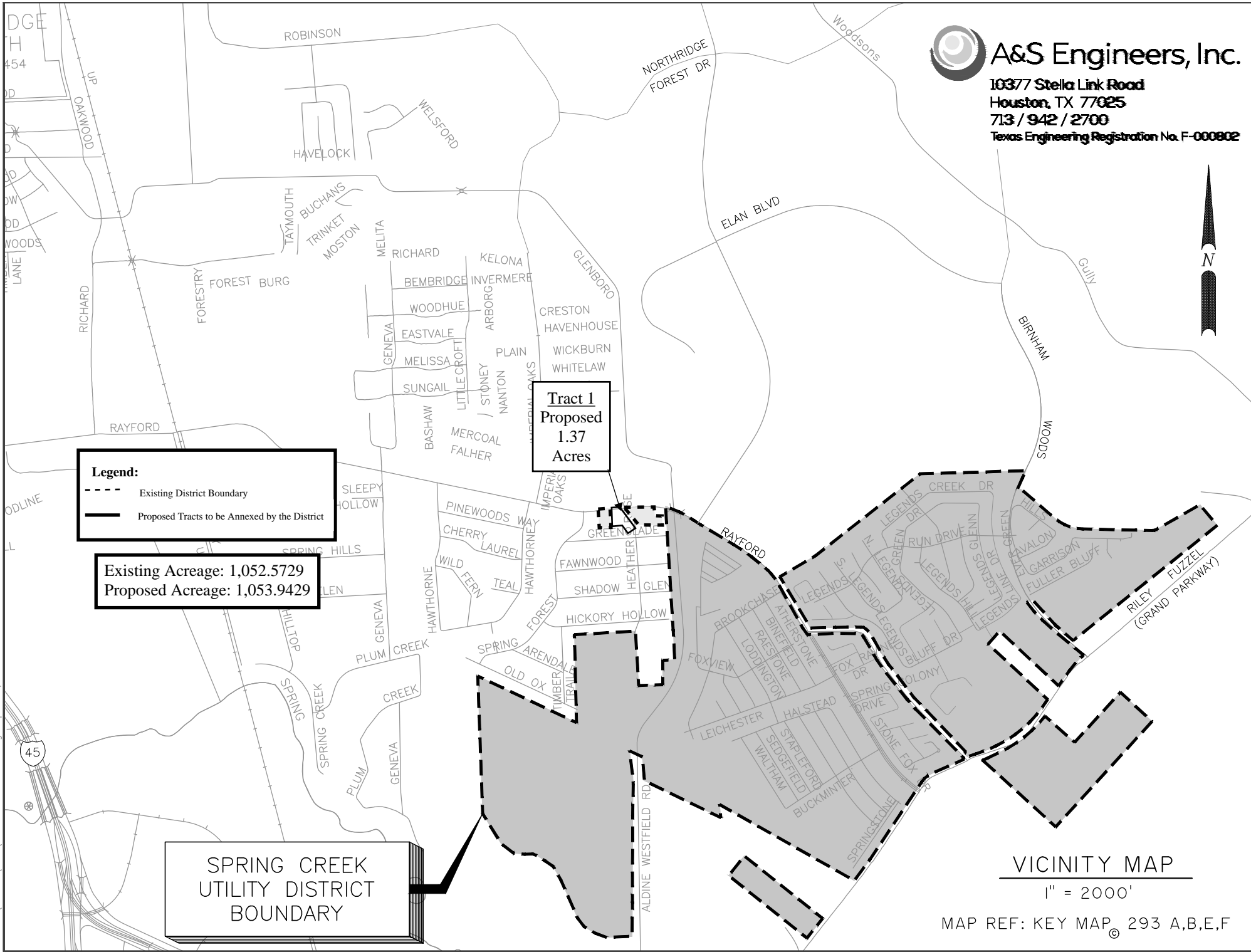

A&S Engineers, Inc.
 10377 Stella Link Road
 Houston, TX 77025
 713 / 942 / 2700
 Texas Engineering Registration No. F-000802



Tract 1
Proposed
1.37
Acres

Legend:
 - - - Existing District Boundary
 — Proposed Tracts to be Annexed by the District

Existing Acreage: 1,052.5729
Proposed Acreage: 1,053.9429

SPRING CREEK
UTILITY DISTRICT
BOUNDARY

VICINITY MAP
 1" = 2000'

MAP REF: KEY MAP, 293 A,B,E,F

FILE: H:\137173\DWG\137173 - VIC MAP.dwg April 23, 2020 - 11:43 AM kwm

Spring Creek UD (1.37 acres)

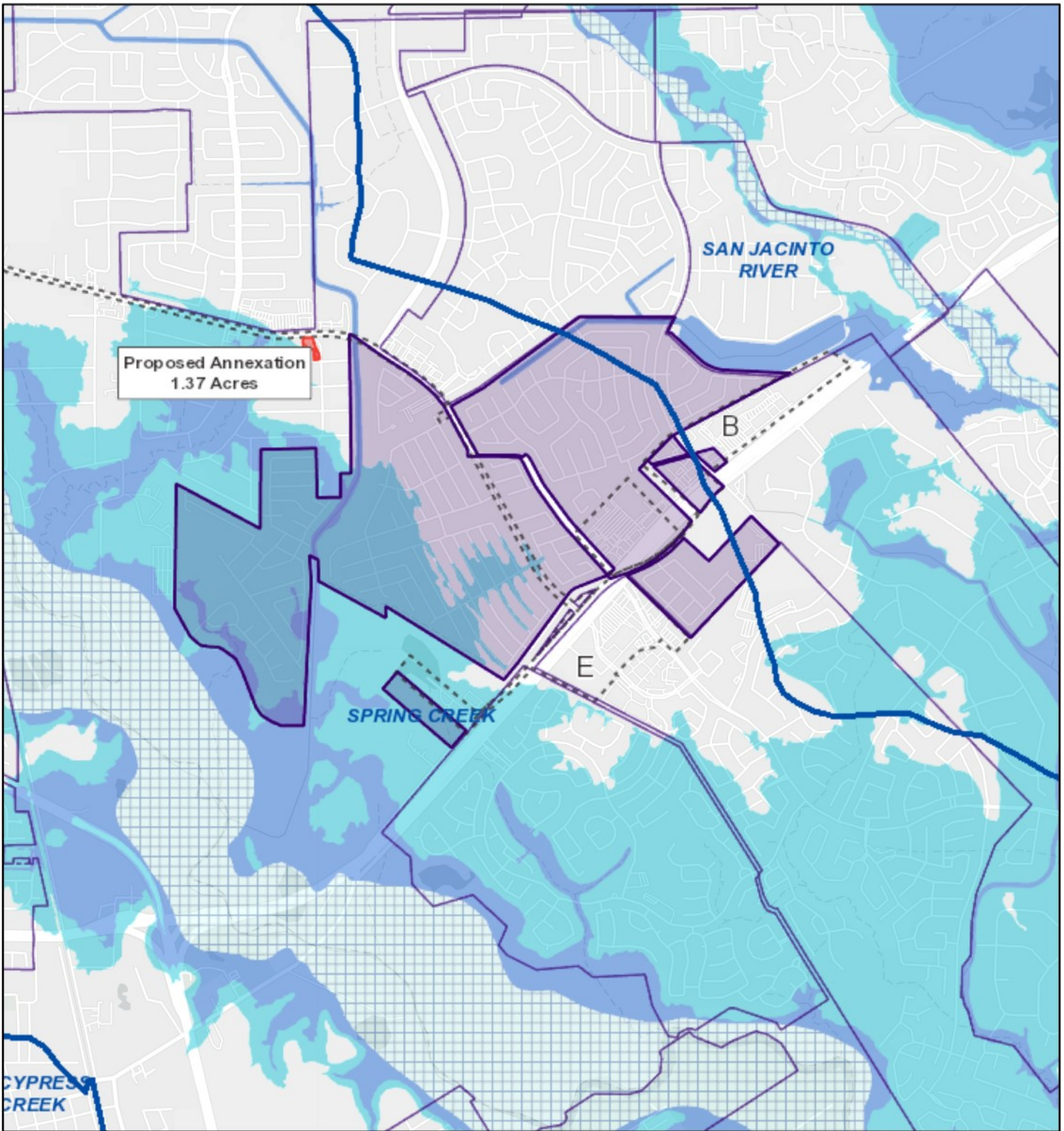

6/30/2020, 12:44:21 PM

1:36,112

- | | |
|---------------------------|------------------------------|
| Flood Hazard Zones | Council Districts |
| 100 Year Floodplain | Existing Acreage of District |
| 500 Year Floodplain | Proposed Annexation |
| Floodway | COH Wastewater Line |
| City Limits | COH Water Line |

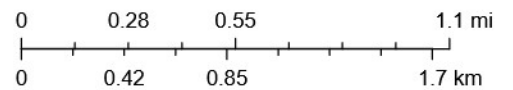

HCFC and HCED.