

PARCEL MAP - SY14-054

Abandonment and sale of a 10-foot-wide prescriptive utility easement, being out of Lots 2, 3, 6, and 7, Block 5, within the Mayfair Addition First Section, out of the A.C. Reynolds Survey.

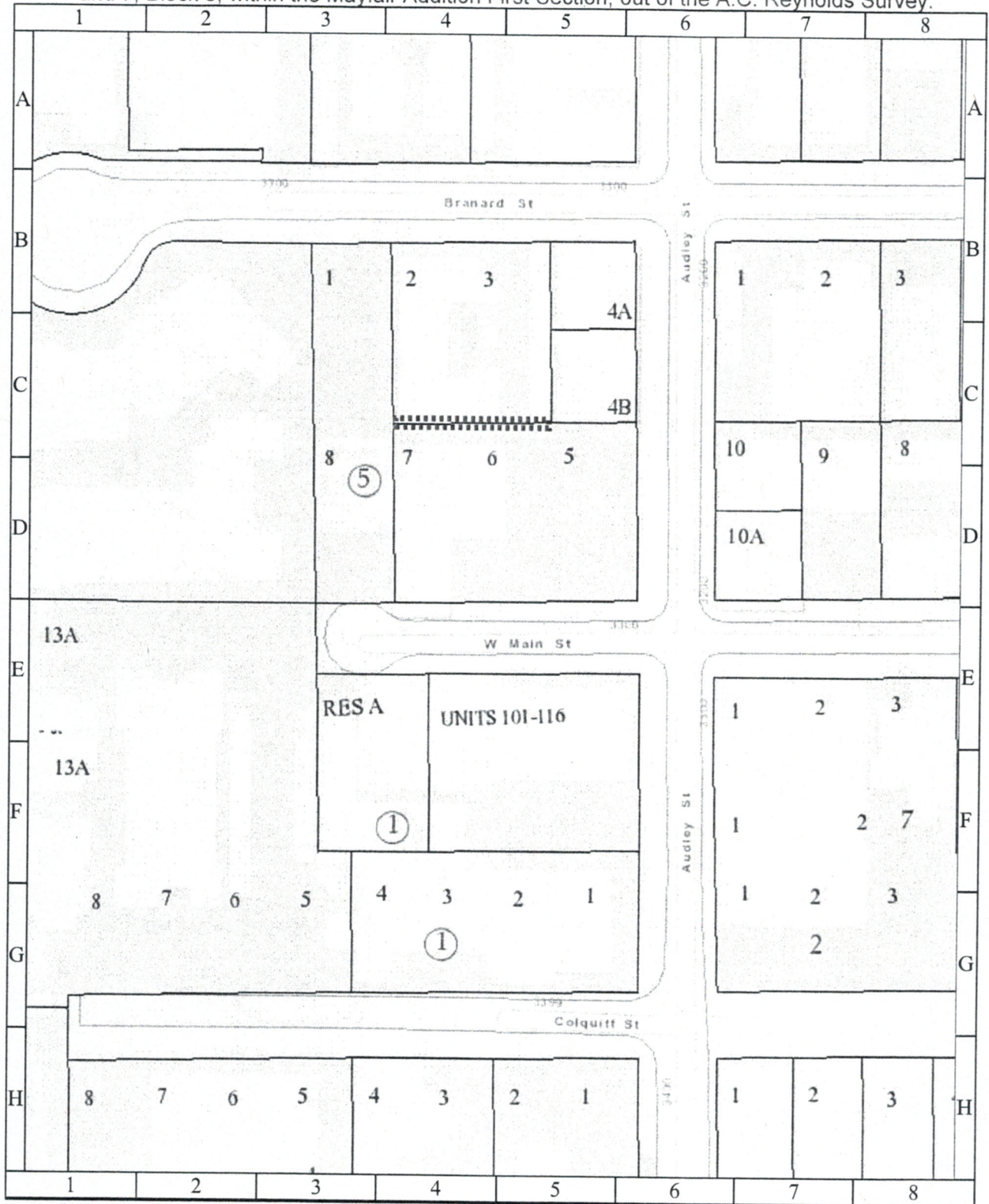

CITY OF HOUSTON

Department of Public Works and Engineering
Geographic Information & Management System (GIMS)

DISCLAIMER: THIS MAP REPRESENTS THE BEST INFORMATION AVAILABLE
TO THE CITY.
THE CITY DOES NOT WARRANT ITS ACCURACY OR COMPLETENESS.

